

DELHI DEVELOPMENT AUTHORITY
ELECTRICAL DIVISION NO:07

Notice Inviting Tender e No: 010 / EE / ED-7 / DDA / 2008-09

Sealed item rate tender are invited for the following works by the Executive Engineer (Elect.) Elect. Divn.7 / DDA, Keshavpuram, Delhi-110035 upto 3:00 PM on behalf of D.D.A. from the approved contractor of appropriate class of DDA, CPWD, MES, P&T, Railway and which shall be opened on the same day at 3:30 PM at Ground Floor, Vikas Minar, DDA Office, I.P. Estate, New Delhi in the presence of intending purchaser of their authorized representatives.

The tender documents can be held on any working day from the office of CAU/NZ/DDA, Ashok Vihar, Sale Counter Vikas Minar, New Delhi between the 11:00 to 3:00 PM on payment of amount of mentioned against each work (non refundable) on production of enlistment registration certificate and valid registration with works contract cell of Sales Tax Department of G.N.C.T.D. and tax clearance certificate issued by the works contract cell in Form-XI as well as the amount earnest money the shape of cash receipt treasury challan / deposit as call receipt of scheduled bank fixed deposit receipt of a scheduled bank / demand draft of scheduled bank in favour of Sr. A.O. / CAU / N.Z. / DDA sales of tenders form will be stopped four days (including the date of opening) before the date fixed for the opening of tender documents.

The manner of submission of tenders opening of the same and entry of contractor's. Their authorized representative to the place of opening shall be as provided in clause 3(a), (b) & 3(c) of PWD-6 forming part of tender.

S. No.	Name of Work	NIT No.	Estimated Cost Earnest Money	Tendered Cost Time Allowed	Date of Sale Date of Opening
1.	D/o Golf Course at Bhalaswa Lake. SH: Supplying & Laying XLPE Aluminium conductor armoured cable for office building, supplying 7 installation of feeder pillar.	(34)	1,74,922/- 3,498/-	Rs.500/- Two Month	14.11.08 18.11.08
2.	D/o Land at Narela Township. SH: Supplying & Installation of submersible pump set in project office building at Narela.	(33)	1,18,818/- 2,376/-	Rs.500/- One Month	14.11.08 18.11.08

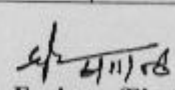
Executive Engineer (Elect)
Electrical Division No.-7
Delhi Development Authority

Contd....2/-

:: 2 ::

No:F.71(6)A/C/ED-7/DDA/2007-08/ 1431

Dt. 6/11/08

Copy to:

1. C.E.(Elect.)/DDA for information please.
2. F.O. TO C.E.(Elect.)/DDA for information please.
3. S.E.(Elect.) Elect. Circle-2/DDA for information please.
4. E.E.(Elect.)/Elect. Divn.1 to 6 & 8 to 12/DDA .
5. Executive Engineer /WD-5/DDA Vikas Minar,
6. A.O.(Work)/DDA
7. Sr. A.O.(CAU)NZ/DDA
8. All AE's/AE(P)/ED-7/DDA
9. Head Clerk/ED-7/DDA
10. Security Officer, Vikas Minar, DDA.
11. Tender Clerk/CAU/NZ/DDA & Tender Clerk./Vikas Minar, DDA
12. DDA Builder Association (Regd.) C-29, Panchsheel Enclave, Delhi.
13. Contractor Welfare Association (Regd.) E-18, Vikas Kuteer, New Delhi.
14. DDA Contractor Association (Regd.) near entrance barrack Vikas Kuteer, I.P. Estate, New Delhi.
15. The Secy. Contractor Welfare Association (Regd.)Y-Shape Building, I.P. Estate New Delhi
16. The Secy. Contractor Welfare Association (Regd.)Arya Samaj Bazar, Sita Ram, Delhi
17. The Association Elect. Contractor (Regd.) 41-A. Mayapuri Indl. Area, Ph-II, New Delhi.
18. Trans Yamuna DDA Contractor Association (Regd.), 11-12, Vir Savarkar Market, Budh Bazar, Gandhi Nagar, Delhi.
19. Delhi Contractor Association (Regd.) 88-B, First Floor, Jwala Heri Market, Paschim Vihar, New Delhi.
20. Delhi Contractor Welfare Association (Regd.), 79, Triveni Apartment, New Police Station, Vivek Vihar, Delhi.
- ✓ 21. E-Mail Address: ddatender@org.in

Executive Engineer (Elect)
Electrical Division No.-7
Delhi Development Authority

sure - II

led in case of
milestone

led in case of
milestone

led in case of
milestone

led in case of
milestone

led in case of
milestone

led in case of
milestone

led in case of
milestone

led in case of
milestone

led in case of
milestone

led in case of
milestone

led in case of
milestone

led in case of
milestone

led in case of
milestone

led in case of
milestone

led in case of
milestone

led in case of
milestone

led in case of
milestone

led in case of
milestone

led in case of
milestone

led in case of
milestone

led in case of
milestone

led in case of
milestone

led in case of
milestone

led in case of
milestone

led in case of
milestone

led in case of
milestone

(87)

SCHEDULE OF WORK

Name of work: D/o Land at Narela Township.
SH: Supplying & installation of submersible pump set in Project Office building at Narela.

S. No.	Description of Item	Qty.	Unit	Rate	Amount
1	Supplying of submersible pump duly coupled with suitable rating of 3 Phase 415 Volts, 50 Hz, 2900 RPM submersible induction motor. The pump set shall be suitable for the following duties; a) Discharge : 160 LPM b) Head : 37 Meter c) Liquid : Clear water.	2 Sets	Set		
2	Supplying of following size of GI B-Class pipe i/c GI flanges duly screwed and welded on both ends of GI pipe, bend, tee, nipple, rubber gasket, GI nut-bolt and washers etc. as reqd. a) 50mm dia.	39.00 Mtr.	Mtr.		
3	Supply of PVC sheathed PVC insulated copper cond. flat Sub. cable etc. as reqd. a) 1X3X1.5 sq mm.	45.00 Mtr.	Mtr.		
4	Lowering, testing, commissioning of sub., pump set alongwith double flanged GI pipe, sub. Cable i/c jointing and accessories upto the required depth, providing & fixing 2 Nos. MS clamps made of MS flat 75mmX16mmX500mm alongwith nut-bolts, washers, cutting the existing bore cover making suitable removable cover and fixing of sub. Cable with insulated wire with GI pipe complete as reqd.	1 Job	Job		
5	Supply & fixing of following size of C.I. flanged valve complete with rubber gasket, nut-bolts and washers etc. as reqd. a) Non-return valve (without by-pass) 50mm dia. b) Sluice valve (non - rising spindle) 50 mm dia.	1 No. 1 No.	Each Each		

A
C
D
DW-1

DEP
AEIP

URE - 'A'

@ 2% of the
for all work
and for work
tunes, earned
as plus 1% of
s.
sted with each
oney shall be
wing manner.
lan/Deposit at

6.	Supplying, erection, testing & commissioning of LT feeder pillar fabricated out of 14 SWG (2mm thick) nominal CRCA MS sheet with (50x50x6)mm angle iron legs as per drawing attached and suitable to accommodate and supplying and fixing the following accessories therein i/c connections, inter-connections with suitable size of copper wire, earth connections, numbering and spray painted after applying a coat of zinc chromate primer as reqd. a) 32 Amp. TP & N MCB 10 K.A. (C-series) - 1 No b) 32 Amp. TP MCB (C-series) 10 K.A. (C-series) - 1 No c) Single phase preventor cum water level guard. With prod/sensor - 1 No. d) DOL starter with enclosure having suitable relay complete as reqd. - 1 No. e) 3 Phase shunt capacitor suitable for item No. 1 - 1 No. f) Phase indicator neon lamps with toggle switches & back up fuses. - 1 set g) Voltmeter (0-500V) 96mm square dial with selector - switch. - 1 No. h) Ammeter (0-30 A) 96mm square dial. - 1 No. i) 20 Amp. SPN MCB 10 KA (B-Series). - 1 No. j) 6 Amp. TP MCB 10 KA (B-Series). - 1 No. k) 4 strip 300mm long al. bus bar 100 Amp. Capacity duly PVC taped / sleeved having drilled holes 6mm dia bolts, nuts and washers etc. as reqd. - 1 No. l) Danger Notice Plate. (200X150)mm - 1 No.	1 Set	Set	
7.	Earthing with GI earth pipe 4.5m long and 40mm dia i/c accessories and providing masonry enclosure with cover plate having locking arrangement and watering pipe etc. with salt & charcoal as reqd.	2 set	Set	
8.	Providing & fixing 25mm X 5 mm GI strip on surface or in recess for earth connection etc. as reqd.	6 Mtr.	Mtr.	
9.	Supplying & fixing 8mm steel wire rope i/c fixing with the steel cage for holding sub. P/set with suitable size of clamps nut, bolts etc. as reqd.	90 Mtr.	Mtr.	

A
C
D
N/L

RECEIVED
20/11/2017

(91)

Supplying and fixing the cage for holding sub. Pump set made of MS flat iron of size (40X5)mmX1.75 mtr. Long with supporting clamps & anchor to the wire rope etc. complete as reqd.	1 Set	Set
Supplying of XLPE aluminium conductor armoured cable of 1.1 K.V. grade of size 4 X 10 sq.mm i/c connection complete etc. as reqd.	115 Mtr.	Mtr.
Laying & Fixing of one No. PVC insulated XLPE al. cond. Cable of 1.1 KV grade of size not exceeding 25 sq.mm on surface as reqd.	80 Mtr.	Mtr.
Fixing of XLPE al. cond. Cable of size 4 X 10 sq.mm with existing G.I. wire including binding with G.I. wire on over head system i/c testing commissioning etc. complete as reqd.	35 Mtr.	Mtr.
Providing & fixing 6 SWG dia G.I. wire on surface or in recess for loop earthing alongwith existing surface / recessed conduit / submain wiring / cable etc. as required.	115 Mtr.	Mtr.
Providing & fixing following capacity TP & N disconnector fuse switch unit inside the existing cubical panel board with ISI marked, HRC fuses i/c drilling holes in cubical panel making connection testing, etc. complete as required.	1 No.	Each
a) 32 Amp. TP & N		
Supplying & erection of G.I. pipe / pole B-class of 6 mtr. long of size 50mm dia with base plate (250X250X6)mm including B-clamp bracket with eye bolt for holding the shackle insulator including proving & fixing of shackle insulator 75mm X 90 mm, erection in cement concrete foundation 1 : 3 : 6 (1 cement : 3 coarse sand : 6 graded stone with 40mm nominal size) including excavation, refilling painting & numbering etc. complete as reqd.	2 Nos.	Each

A---+
C---+
D---+
OW---+
NIL

JEK
S
A.C.I.O.I

(93)

MAKES OF MATERIALS & Governing Specifications

S. NO.	ITEM	GOVERNING SPECIFICATIONS	MAKE
1.	Submersible pump set	-	K.S.B./Kirloskar /Crompton Greaves
2.	C.I. Non Return Valves, Cut-Sluice valve	IS: 5312	I.V.C./Kirloskar
3.	C.I. Sluice valve	IS: 14846	I.V.C./Kirloskar
4.	G.I. pipe	IS: 1239	Jindal (Hissar)/Surya/TATA.
5.	Starter,	-	L&T/Siemens/Cutler Hammer.
6.	Shunt Capacitor	-	GEMadav/Crompton/L&T
7.	Single phase preventer-cum-water level guard.	-	L&T/Mililac
8.	Ammeter & Voltmeter	IS: 1248	AE/Havells/UELI/MP
9.	PVC sheathed, PVC insulated flat submersible copper cable.	IS: 694	Plaza/Faiolex/Safex
10.	Selector Switch	-	Havells/Thakur/L&T/KAYCEE
11.	PVC insulated F.R. copper wire	IS: 694	Skytone/National/ECKO/Havells.
12.	M.C.B.	IS: 8828	Standard/L&T/MDS/Indokopp/Action
13.	Panel Board	-	Shall be fabricated as per drawing attached.
14.	XLPE cable	IS: 7098	Skytone, Ecco, Nicco Asian, Unistar with ISI marked
15.	Switch disconnector fuse unit	IS: 13947	L & T, Siemens, Standard

A
 C
 D
 DVV
 NIL

J.A.P.
 A.E.(P)

12/11/14
 12/11/14
 12/11/14

95

ADDITIONAL CONDITIONS AND SPECIFICATIONS

1. The contractor must get acquainted with the proposed site for the work and study specifications and conditions carefully before tendering. The work shall be executed as per programme approved by the Engineer-in-charge. The work shall be executed in close coordination with the progress of the bldg. work. If the site for electrical work is not available in part or in full for any reason whatsoever the time for the execution of the electrical work shall be correspondingly extended. No claim for any idle labour or compensation (except as provided under clause 10C/10CC as applicable in the printed conditions of contract) shall be entertained.
2. The contractor shall submit completion certificate as per appendix 'E' of the general specification for electrical work (part-I) internal 2005 within one month after actual date of completion, failing which an amount @ 1% of the tendered cost subject to maximum of Rs.5000/- shall be deducted from any amount due to the contractor from DDA.
3. No tube well bore shall be left open as and when sub. Pump set are taken out for repair/replacement.
4. The following work shall be deemed to be included within the scope of work to be executed by the contractor and nothing extra shall be paid on this account.
 - i) All minor building work such as cutting of holes and chases in walls/ceiling and making good the same with cement mortar 1:4 (1 Cement : 4 Coarse sand).
 - ii) Provision of suitable support and clamps for fixing arrangement including nuts, bolts, cable glands, lugs, terminal blocks etc. as a part of the particular item unless given separately in the schedule of work.
 - iii) Masonry support / G.I. pipe support etc. shall be provided wherever required.
5. Testing of Installation:
 - i) The entire system shall be tested to the satisfaction of Engineer-in-charge.
 - ii) Tests shall be performed in the presence of Engineer-in-charge or his representative.
 - iii) The contractor shall provide all labour, equipments and material required for performance of the tests.
6. The rates quoted by the contractor shall be firm and should be inclusive of all central / state govt., taxes, duties and levies etc.
7. Concessional sales tax form C/D shall not be issued by the Department.
8. The installation shall be covered by the conditions that the whole installation or any part thereof found defective within the guarantee period should be replaced by the contractor free of charge in a reasonable time. The guarantee shall cover the followings:

A-
C-
D-
NW-

J.E(P) AE(P)

- a) Quality, strength and performance of the material and equipment used.
 - b) Safe electrical and mechanical strength of all parts of the equipments under all specified conditions of operations / satisfactory performance.
 - c) Safe performance figure and other values as specified in the schedule of guarantee / technical particulars.
 - d) Prompt service during guarantee period.
 - e) Attending to consequential damages in the equipments supplied and installed by the tenderer.
 - f) Guarantee period of 12 months shall be counted from the date of handing over of installation to the department against manufacturing defects / satisfactory performance on a non-judicial stamp paper of Rs.50/- only.
9. Contractor shall provide the manufacturer test certificate in respect of all major items.
 10. The contractors shall be fully responsible for watch and ward of the material brought / work executed at site till the same is complete and taken over by the department.
 11. After the award of work, the contractor shall get all the materials approved from the Engineer-in-charge before use in the work. The contractor shall also produce test certificate for conformity with relevant IS specification if required by the Engineer-in-charge.
 12. The submersible cable from panel T.W. bore shall be laid in 40mm dia G.I. 'B' Class pipe, the cost of which is included in the item of panel board.
 13. Flyash bricks shall be used in the work wherever required.

SPECIFICATIONS:

14. The work as indicated in the schedule of quantities attached herewith including any modifications, additions, alterations ordered subsequently shall be carried out as per specifications given below :-
 - i) CPWD specifications for Electrical Works at Delhi part-I (Internal) 2005 and part-II (External) 1994 with amendments upto the date of tenders.
 - ii) Indian Electricity Rules 1956 as amended upto date.
 - iii) A table indicating the makes, governing specifications and other details in respect of some of the important materials to be used in the work is attached. These specifications shall have preference over those indicated in 14(i) above.
 - iv) Only material bearing ISI/BIS certification mark shall be used in the work. Where articles of different designs / make bearing ISI/BIS certification mark are available, the decision of Engineer-in-charge about the design/ make to be used in the work shall be final and binding on the contractor.
 - v) Where material bearing ISI/BIS certification marks are not available, material conforming to relevant BIS/ISI shall be used with prior approval of Engineer-in-charge.

A
C
D
OW.

NIL

AE(P)

- vi) If the specifications of any item are not available then the decision of the Engineer-in-charge regarding quality shall be final and binding on the contractor.
15. In case of any discrepancy in the description of any item given in the schedule of quantities and the specifications, the former shall prevail. If the specifications of any item are not available, the decision of Engineer-in-charge, shall be final.
16. No Tool and plants shall be issued for execution of the work or for testing of the installation. These shall be arranged by the contractor within the quoted rates.
17. The contract would have to make his own arrangement for cartage and transportation of the materials and nothing extra shall be payable on this account.
18. The sub. Standard work shall be rejected without assigning any reason.
19. The following information to be furnished by the tenderers :
 - a) Type, make, model and HP of the pump set offered.
 - b) Discharge in liters per minutes and head in meters.
 - c) Revolution per minutes.
20. Time allowed for carrying of work within one months.
21. Additional specification are indicated in the following clause. These additional specifications given below shall have precedence over these indicated para 14 above in case of deviations between the two.
22. Three pin socket outlet shall be provided for power plug points.,
23. Connectors to be used any where in the installation shall be of porcelain type.
24. Earthing work i.e. embedding of earth electrode and testing of installations shall be carried out in the presence of the Asstt. Engineer (E).
25. The length of GI pipe to be used in the work for installation of the submersible pump set shall not be more than three meters.

Executive Engineer (E)
Elect. Divn 7/DDA.

A ---
C
D
OW ---
NIL

JE(P) AE(P)

FEEDER PILLAR FOR PUMP SET

ITEM NO:- 6

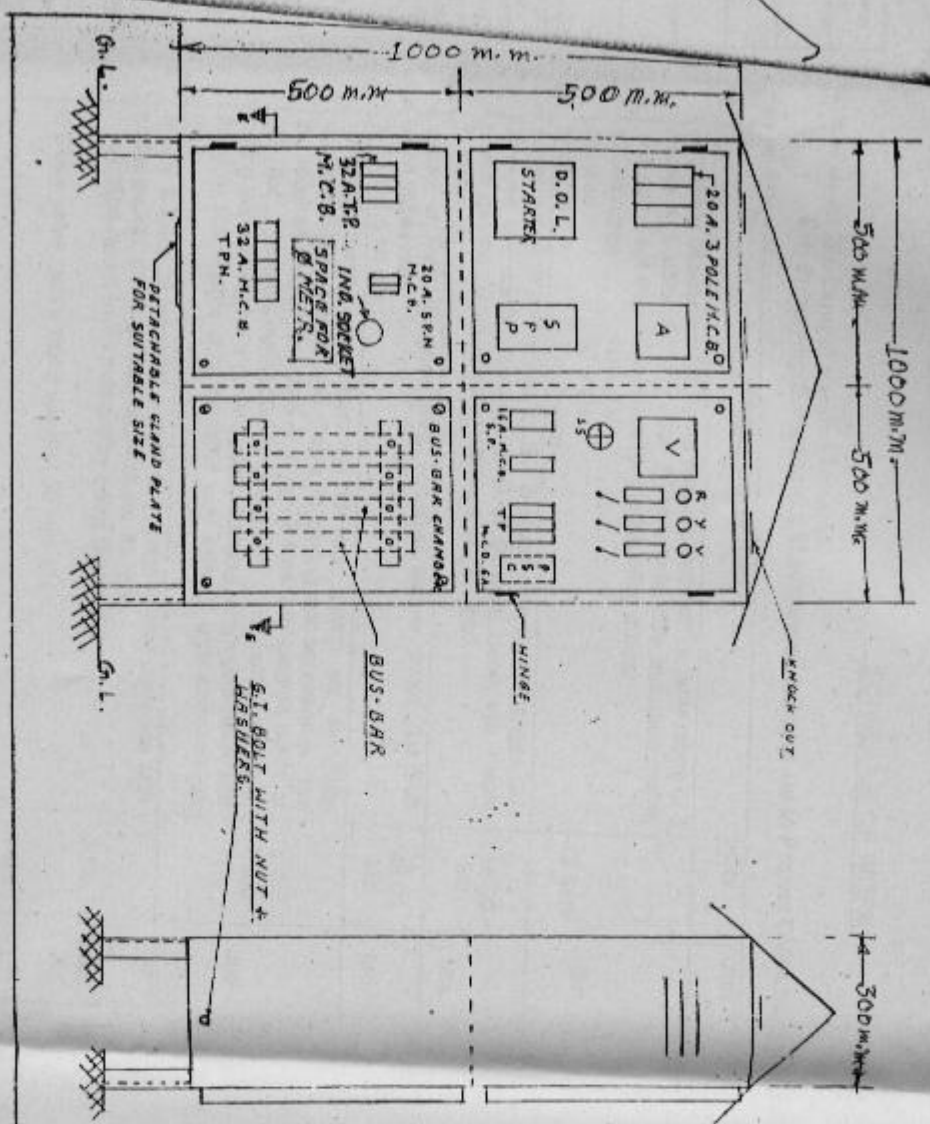

NOTES:-

- ① - DRG. IS NOT TO THE SCALE
- ② - ALL DIMENSIONS ARE IN MM
- ③ - LOCATION OF ACCESSORIES SHOWN ARE TENTATIVE AND SUBJECT TO CHANGE AS PER SITE CONDITION & APPROVAL OF ENGINEER-IN-CHARGE.
- ④ - PANNEL SHOULD BE DUST & VERMIN PROOF
- ⑤ - KNOCK OUTS FOR CABLE CONDUIT ENTRIES SHOULD BE MADE AS PER RECD.

Handwritten signature and initials.

Handwritten signature and initials.

16/9/08
ABCE-12

Handwritten signature and initials.