

DELHI DEVELOPMENT AUTHORITY
ELECTRICAL DIVISION NO:07

Notice Inviting Tender e No: 010 / EE / ED-7 / DDA / 2008-09

Sealed item rate tender are invited for the following works by the Executive Engineer (Elect.) Elect. Divn.7 / DDA, Keshavpuram, Delhi-110035 upto 3:00 PM on behalf of D.D.A. from the approved contractor of appropriate class of DDA, CPWD, MES, P&T, Railway and which shall be opened on the same day at 3:30 PM at Ground Floor, Vikas Minar, DDA Office, I.P. Estate, New Delhi in the presence of intending purchaser of their authorized representatives.

The tender documents can be held on any working day from the office of CAU/NZ/DDA, Ashok Vihar, Sale Counter Vikas Minar, New Delhi between the 11:00 to 3:00 PM on payment of amount of mentioned against each work (non refundable) on production of enlistment registration certificate and valid registration with works contract cell of Sales Tax Department of G.N.C.T.D. and tax clearance certificate issued by the works contract cell in Form-XI as well as the amount earnest money the shape of cash receipt treasury challan / deposit as call receipt of scheduled bank fixed deposit receipt of a scheduled bank / demand draft of scheduled bank in favour of Sr. A.O. / CAU / N.Z. / DDA sales of tenders form will be stopped four days (including the date of opening) before the date fixed for the opening of tender documents.

The manner of submission of tenders opening of the same and entry of contractor's. Their authorized representative to the place of opening shall be as provided in clause 3(a), (b) & 3(c) of PWD-6 forming part of tender.

S. No.	Name of Work	NIT No.	Estimated Cost Earnest Money	Tendered Cost Time Allowed	Date of Sale Date of Opening
1.	D/o Golf Course at Bhalaswa Lake. SH: Supplying & Laying XLPE Aluminium conductor armoured cable for office building, supplying 7 installation of feeder pillar.	(34)	1,74,922/- 3,498/-	Rs.500/- Two Month	14.11.08 18.11.08
2.	D/o Land at Narela Township. SH: Supplying & Installation of submersible pump set in project office building at Narela.	(33)	1,18,818/- 2,376/-	Rs.500/- One Month	14.11.08 18.11.08

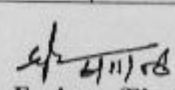
Executive Engineer (Elect)
Electrical Division No.-7
Delhi Development Authority

Contd....2/-

:: 2 ::

No:F.71(6)A/C/ED-7/DDA/2007-08/ 1431

Dt. 6/11/08

Copy to:

1. C.E.(Elect.)/DDA for information please.
2. F.O. TO C.E.(Elect.)/DDA for information please.
3. S.E.(Elect.) Elect. Circle-2/DDA for information please.
4. E.E.(Elect.)/Elect. Divn.1 to 6 & 8 to 12/DDA .
5. Executive Engineer /WD-5/DDA Vikas Minar,
6. A.O.(Work)/DDA
7. Sr. A.O.(CAU)NZ/DDA
8. All AE's/AE(P)/ED-7/DDA
9. Head Clerk/ED-7/DDA
10. Security Officer, Vikas Minar, DDA.
11. Tender Clerk/CAU/NZ/DDA & Tender Clerk./Vikas Minar, DDA
12. DDA Builder Association (Regd.) C-29, Panchsheel Enclave, Delhi.
13. Contractor Welfare Association (Regd.) E-18, Vikas Kuteer, New Delhi.
14. DDA Contractor Association (Regd.) near entrance barrack Vikas Kuteer, I.P. Estate, New Delhi.
15. The Secy. Contractor Welfare Association (Regd.)Y-Shape Building, I.P. Estate New Delhi
16. The Secy. Contractor Welfare Association (Regd.)Arya Samaj Bazar, Sita Ram, Delhi
17. The Association Elect. Contractor (Regd.) 41-A. Mayapuri Indl. Area, Ph-II, New Delhi.
18. Trans Yamuna DDA Contractor Association (Regd.), 11-12, Vir Savarkar Market, Budh Bazar, Gandhi Nagar, Delhi.
19. Delhi Contractor Association (Regd.) 88-B, First Floor, Jwala Heri Market, Paschim Vihar, New Delhi.
20. Delhi Contractor Welfare Association (Regd.), 79, Triveni Apartment, New Police Station, Vivek Vihar, Delhi.
- ✓ 21. E-Mail Address: ddatender@org.in

Executive Engineer (Elect)
Electrical Division No.-7
Delhi Development Authority

Annexure-

: withheld in
ment of milles

(87)

DELHI DEVELOPMENT AUTHORITY
ELECTRICAL DIVISION NO-7

Name of work: D/o Golf Course at Bhalaswa lake.

(SH: - Supplying & Laying XLPE Aluminium conductor armoured cable, for office building, Supplying & installations of Feeder Pillars.)

No.	Description of item	Qty.	Unit	Rate	Amount
	Supplying of 4 X 35sq.mm XLPE Aluminium conductor armoured power cable of 1.1 KV grade including connection, testing on load etc. as required.	270 Mtr.			
	Laying of one number PVC insulated and PVC sheathed / XLPE power cable of 1.1 KV grade of size exceeding 25 sq. mm but not exceeding 120 sq. mm direct in ground including excavation, sand cushioning, protective covering and refilling the trench etc. as required.	255.00 Mtr.			
	Laying of one number of PVC insulated and PVC sheathed / XLPE power cable of 1.1 KV grade of size exceeding 25 sq. mm but not exceeding 400 sq. mm in the existing masonry open duct as required.	5 Mtr.			
	Laying of one No. PVC insulated & PVC sheathed / XLPE power cable of 1.1 KV grade of size exceeding 25 sq.mm but not exceeding 400 sq.mm in the existing RCC/HUME/STONEWARE/METAL pipe as required.	10 Mtr.			
	Supplying, installation, testing and commissioning of Cubical Type out door Feeder Pillar, double door, duly compartmentalised and fabricated with 14 S.W.G. (2 mm thick nominal) CRCA M.S. Sheet with 50 mm X 50 mm X 6 mm angle iron legs as per drawing attached and suitable to accommodate & supplying & fixing the following accessories therein, duly spray painted after applying a coat of Zinc-Chromate primer including making inter-connections of accessories mounted thereon with suitable size of copper wires with thimble / lugs, Compression Glands, earthing stud, numbering, making brick foundation complete as required.	1 Sets.			
	a) 250 Amp, 415 volts TP&N switch disconnector fuse unit with HRC fuses (Interior Only) ----- 1 No.				
	b) 63 Amps, 415VVolts TP&N switch disconnector fuse unit with HRC fuses (Interior Only) ----- 1 No.				
	c) 32 Amps, 415VVolts TP&N switch disconnector fuse unit with HRC fuses (Interior Only) ----- 2 Nos.				

NIL

JE(P) A.E(P)

d) Volt meter (0-500V) of size 96 m. m. Sq. type with selector switch.....	1 Set.		
e) Ammeter (0-30Amp.) of size 96 m. m. Sq. type ---- 1 No.			
f) 32Amps, "C" series T.P. & N MCB ----- 1 No.			
g) 20Amps, "C" series T.P. MCB ----- 1 No.			
h) 40Amps DP, Isolator MCB ----- 2 No.			
i) Neon Indicating lamp set with toggle switches & sliding kitkat with fuse.....	1 set.		
j) 4-Strip, 400 m. m. long Aluminium bus-bar 100 Amps. Capacity duty PVC tapped / sleeved having drilled holes for 6m.m. dia, nut, bolt & washers etc. as complete as required.....	1 Set		
k) Danger Notice Plate ----- 1 No.			
<p>6. Supplying , installation, testing and commissioning of Cubical Type out door Feeder Pillar, double door, duly compartmentalised and fabricated with 14 S.W.G. (2 mm thick nominal) CERCA M.S. Sheet with 50 mm X 50 mm X 6 mm angle iron legs as per drawing attached and suitable to accommodate & supplying & fixing the following accessories therein, duly spray painted after applying a coat of Zinc-Chromate primer including making inter-connections of accessories mounted thereon with suitable size of copper wires with thimble / lugs, Compression Glands , earthing stud, numbering, making brick foundation complete as required.</p> <p>a) 32 Amps, 415Volts TP&N switch disconnecter fuse unit with HRC fuses (Interior Only) ----- 1 No.</p> <p>b) 32 Amps, "C" series T.P. & N MCB ----- 1 No.</p> <p>c) 20 Amps, "C" series T.P. MCB ----- 1 No.</p> <p>d) 6 Amps, "C" series T.P. MCB ----- 1 No.</p> <p>e) 20Amps, "C" series S.P. & N MCB ----- 1 No.</p> <p>f) 20 Amps, Industrial Socket----- 1 No.</p> <p>g) Volt meter (0-500V) of size 96 m.m. Sq. type with selector switch----- 1 Set.</p> <p>h) Ammeter (0-30Amp.) of size 96 m.m. Sq. type ----- 1 No.</p> <p>i) D.O.L. Starter suitable upto 6 H.P. motor----- 1 No.</p> <p>j) Single phase preventor----- 1 No.</p>	2 Sets.		

ML
AE(P)

k) Power Capacitor of 2 KVAR 1 No.			
l) Neon indicating lamp set with toggle switches & sliding fuse 1 set.			
m) 4-Strip, 300 m. m. long Aluminium bus-bar 100 Amps. Capacity duly PVC tapped / sleeved having drilled holes for 6m.m. dia. nut, bolt & washers etc. as complete as required 1 Set			
(n) Danger Notice Plate 1 No			
7.	Earthing with GI earth pipe 4.5mtrs long x 40mm dia. i.e accessories, and providing masonry enclosure with cover plate having locking arrangement & watering pipe etc. with charcoal and salt as reqd.	6 Sets	P. Set
8.	Providing and fixing 25 mm. x 5 mm. G. I. strip in 40 mm dia. G. I. pipe from earth electrode as required	10 Mtr.	Mtr.
9.	Providing and fixing 25 mm x 5 mm. G. I. strip on surface or in recess for connection etc. as required.	10 Mtr.	Mtr.
10.	Providing and fixing 6 SWG G.I. wire on surface or in recess for loop earthing along with the existing surface / recessed conduit / sub-main wiring / cable as reqd.	270 Mtr.	Mtr.

A --- 1
 C
 D
 O/W ---
 NIL

S. S.
 (E.P.)
 (A.E.P.)

ADDITIONAL CONDITIONS & SPECIFICATIONS

1. The contractor must get acquainted with the proposed site for the work study & specifications and conditions carefully before tendering. If the site or part of the site is not available for any reasons, the programme of execution shall be modified accordingly and the agency shall have no claim except provided in the printed conditions of the contract.
2. The work, as indicated in the schedule of work attached herewith including any modification / addition / alteration / ordered subsequently, shall be carried out as per the following specifications indicated in order of their precedence.
 - a) C.P.W.D. general specification for electrical work part-I [Internal] 2005 , part-II [External] 1994 with correction slips up to the date of tender.
 - b) Relevant BIS Code as modified upto the date wherever BIS code do not exist the British Standard should be followed.
 - c) Indian Electricity Rules 1956 and amended up to date, In case of any discrepancy in the description of any item given in the schedule of quantity and specifications given above the formal shall prevail.
3. The rates quoted by the contractor shall be firm and should be inclusive of all Central / State Govt. Taxes, Duties & Govt. Levies etc. Concessional sales tax form C / D shall not issued by the department.
4. Nothing extra shall be paid on account of cartage etc.
5. Water & electricity for execution of work shall be arranged by the firm through their own arrangement and charges if any shall be borne by them.
6. Testing of installation shall be done by the contractor within the quoted rates. The arrangement of labour / material required for testing shall be arranged by the firm within the quoted rates.
7. The contractor shall stand guarantee for a period of 12 months for material supplied / installed against manufacturing defect / satisfactory performance from the date of completion / handing over whichever is later on a non judicial stamp paper of Rs. 50=00.
8. The clause 10C or 10CC shall not be applicable in this contract.
9. Time allowed for carrying out of the work shall be 2 (Two) Months.
10. Fly ash brick shall be used for laying of cable, if required.
11. End termination of cable in TP&N Switch / MCB / Isolator shall be done by the contractor within the quoted rates.

A ---
C --- NIL
D ---

The contractor has to submit the test certificate of XLPE Aluminum conductor cable.

The contractor shall be fully responsible for watch & ward of material brought / work executed at site till the same is completed and taken over by the department.

No, Tool & Plants will be issued to the agency by the department for execution of work.

Earthing work including embedding of earth electrodes, laying of cable, looping & its testing shall be carried out in the presence of Engineer-in-Charge or his representatives.

The size of Feeder pillar given in the drawing is tentative however for accommodating the accessories to be provided therein, if the size of Feeder pillar to be increased the same shall be increased within the quoted rates & nothing extra shall be paid.

Following makes of materials are acceptable to be used for the items mentioned here under: -

- a) PVC insulated / XLPE aluminum armored conductor cable as per IS: 7098 shall be either of the following makes Asian Cable / Unistar / ECKO / NICCO / Skytone.
- b) Switch Disconnecter fuse unit shall be either of the following makes LT / LK / Standard / Havell's.
- c) Voltmeter / Ammeter as per IS: 1248 shall be either of the following makes AE's / Havell's / Rishab.
- d) MCB as per IS: 8828 shall be either of the following makes Standard / Havell's / MDS / Indocopp / Action & having minimum bracking capacity 10KVA at 220 / 440 Volts.
- e) DOL starter shall be either of the following makes LT / LK / Siemens / Bharat Cutler Hammer.
- f) Single Phase Preventor shall be either of the following makes L&T / Minilec.
- g) Power Shunt Capacitor shall be either of the following makes G E / Crompton / L & T / Madhav.

A
C
D
DW-
NIL

J.E(P) A.E(P)

4/7/18
इतिहास
निर्माण
संविदात

(17)
FLOOR MOUNTED SERVICE FEEDER PILLAR
SIZE :- 1000 mm. x 1000 mm. x 300 mm. (DOUBLE DOOR)

RAIN PROTECTION COVER

ITEM NO-5

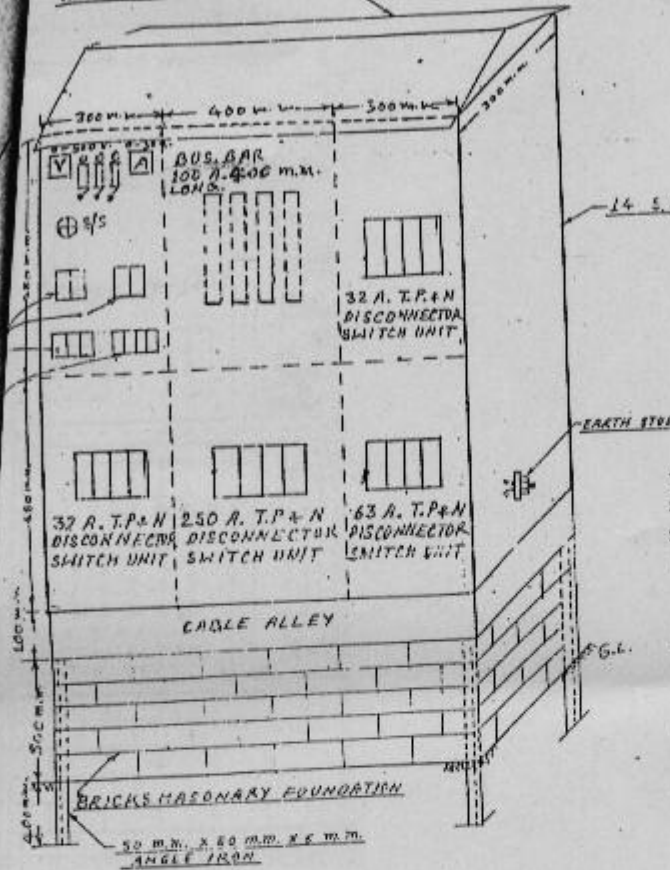

NOTES :-

1. DRG. IS NOT TO THE SCALE
2. ALL DIMENSIONS ARE IN MM.
3. LOCATION OF ACCESSORIES SHOWN ARE TENTATIVE AND SUBJECT TO CHANGE AS PER SITE CONDITION & APPROVAL OF ENGINEER-IN-CHARGE.
4. KNOCK-OUTS FOR CABLE/CONDUIT ENTRIES SHOULD BE MADE AS PER REGD.
5. ALL THE COMPARTMENTS DOORS SHALL BE HINGED GASKETED AND KNOB FITTED
6. PANNEL SHOULD BE DUL VARMIN PROOF.

W ---
C ---
D ---
DW ---
NIL

JE (P) AE (P)

7/11/78
निर्माण विभाग
विद्युत उपकरण
विभाग, अहमदाबाद

FEEDER PILLAR FOR PUMP SET

ITEM NO:-6

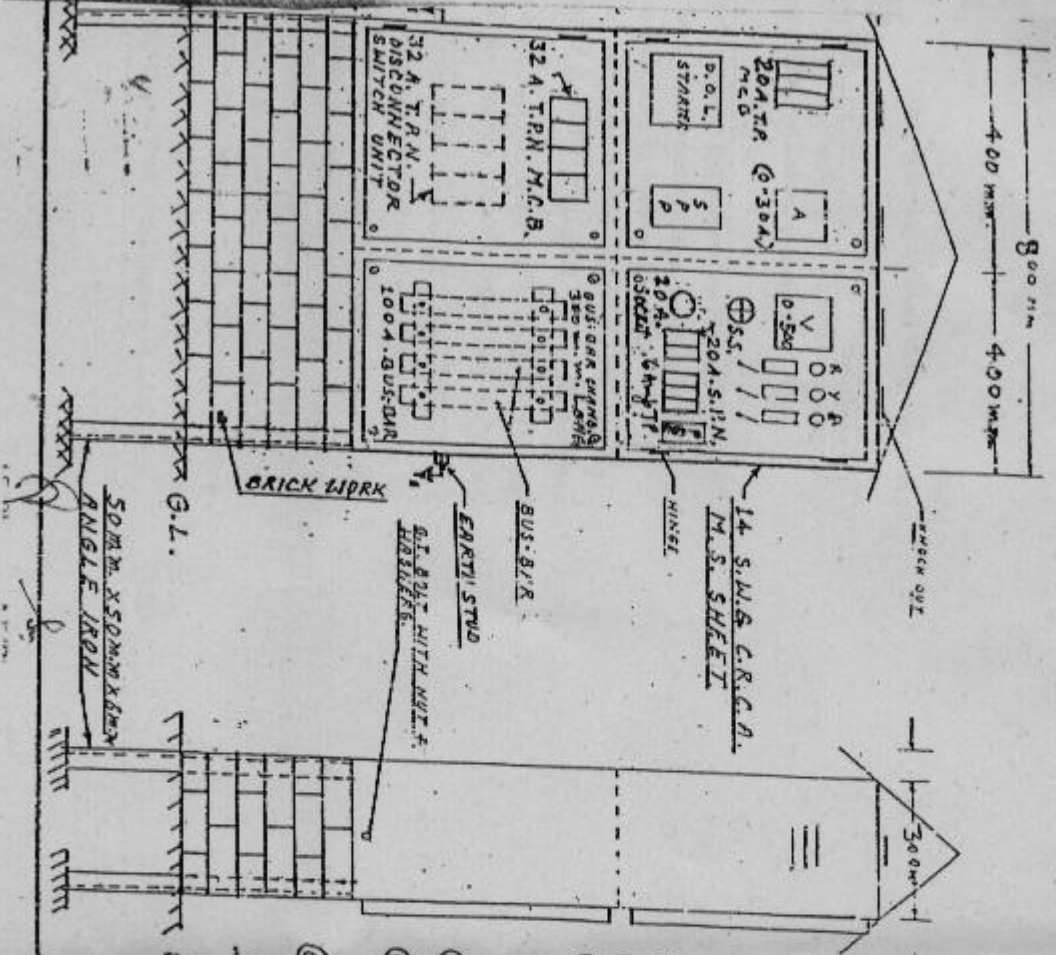

NOTES:-

1. DRG. IS NOT TO THE SCALE
2. ALL DIMENSIONS ARE IN MM
3. LOCATION OF ACCESSORIES SHOWN ARE TENTATIVE AND SUBJECT TO CHANGE AS PER SITE CONDITION & APPROVAL OF ENGINEER-IN-CHARGE.
4. PANELS SHOULD BE DUST & VERMIN PROOF
5. KNOCK OUTS FOR CABLE / CONDUIT ENTRIES SHOULD BE MADE AS PER READ.
6. ALL THE COMPARTMENTS DOORS SHALL BE HINGED GASKETED AND KNOB FITTED.

For the Engineer
Signature
Date