

LANDUSE AREA STATEMENT OF SECTOR-40

A. TOTAL AREA OF SECTOR 40: 341.99 HA

- DDA ACQUIRED AREA: 153.75 HA (45.0%)
- OTHER'S AREA: 188.20 HA (55.0%)

B. LANDUSE BREAKUP OF DDA ACQUIRED AREA:

LANDUSE	AREA (IN HA)	PERCENTAGE
RESIDENTIAL (GROSS)	97.29	63.28
COMMERCIAL	5.91	3.84
PUBLIC/ SEMI PUBLIC FACILITIES	3.75	2.44
RECREATIONAL	21.72	14.13
CIRCULATION	25.08	16.31
TOTAL	153.75	100.00

C. LANDUSE BREAKUP OF GROSS RESIDENTIAL AREA:

LANDUSE	AREA (IN HA)	PERCENTAGE
RESIDENTIAL (NET)	63.28	100.00
COMMERCIAL	0.00	0.00
PUBLIC/ SEMI PUBLIC FACILITIES	0.00	0.00
RECREATIONAL	0.00	0.00
CIRCULATION	0.00	0.00
TOTAL	63.28	100.00

D. DISTRIBUTION OF NET RESIDENTIAL AREA:

GROUP HOUSING	NET AREA	DUS	PERCENTAGE	POPULATION
	63.28	18984	100	85428

E. DETAILS OF ZONAL LEVEL PSP FACILITIES (FC-38):

PLOT NO	USE	AREA (IN HA)
PSP 3	HOSPITAL - D	0.58

F. DETAILS OF ZONAL LEVEL PSP FACILITIES (FC-39):

PSP 4 & 5 (INCLUDING AREA UNDER EXISTING ROAD)		2.9117
PLOT NO	USE	AREA (IN HA)
1	ESS 66 K.V.	0.8631
2	PSP	0.9395
3	NURSING HOME/ POLY CLINIC	0.1410
4	PSP	0.1024
5	PSP	0.1024
6	POLICE POST	0.1024
	CIRCULATION	0.6609

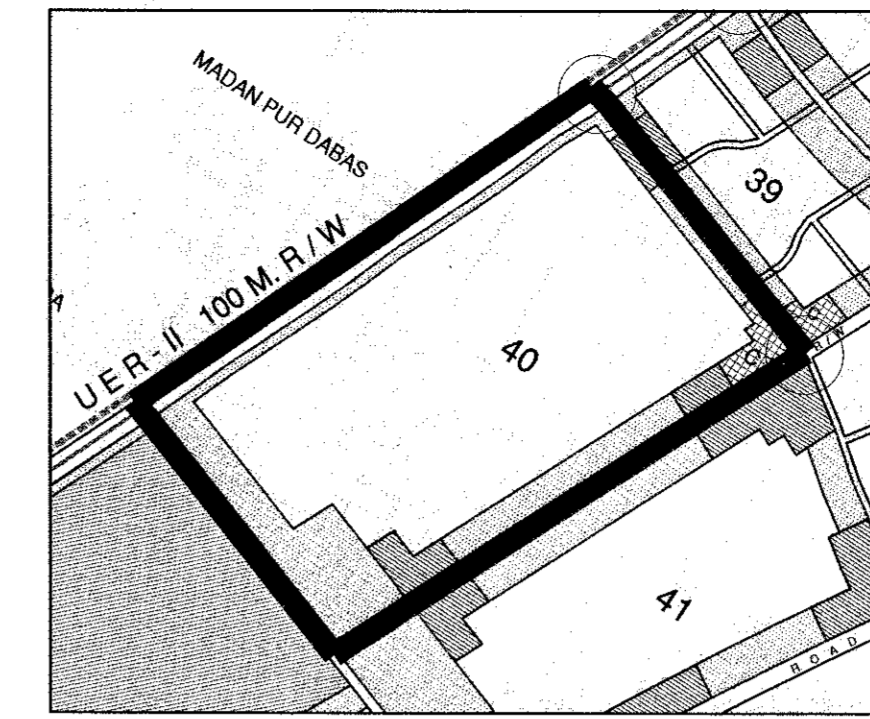

KEY MAP

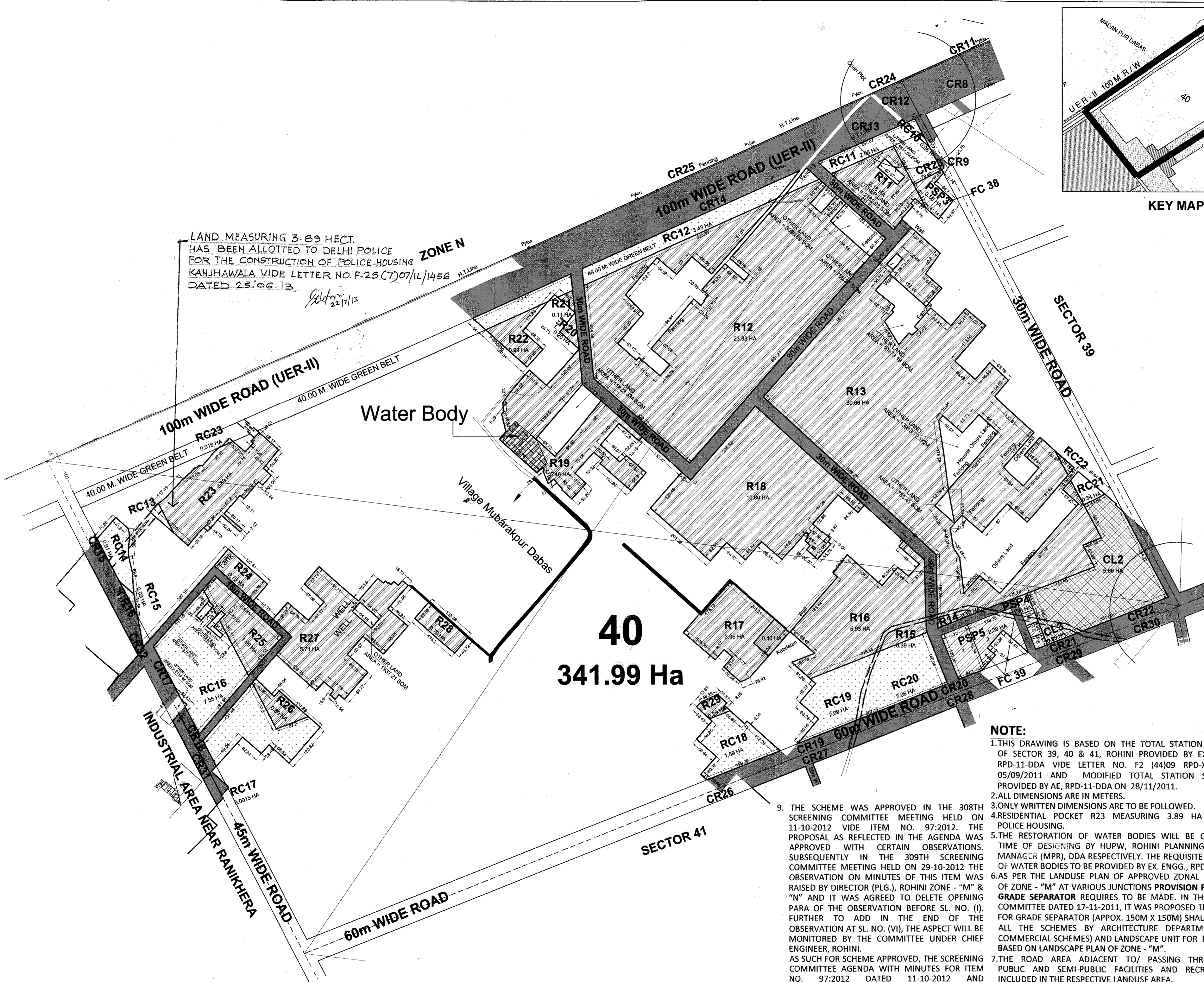

40
341.99 Ha

LAND MEASURING 3.89 HECT.
HAS BEEN ALLOTTED TO DELHI POLICE
FOR THE CONSTRUCTION OF POLICE HOUSING
KANJHAWALA VIDE LETTER NO. F-25 (7) 07/11/1456
DATED 25.06.13.

Water Body

Village Mubarakpur Dabas

NOTE:

- THIS DRAWING IS BASED ON THE TOTAL STATION SURVEY (TSS) PLAN OF SECTOR 39, 40 & 41, ROHINI PROVIDED BY EXECUTIVE ENGINEER, RPD-11-DDA VIDE LETTER NO. F2 (44)09 RPD-XI/DDA/1162 DATED 05/09/2011 AND MODIFIED TOTAL STATION SURVEY (TSS) PLAN PROVIDED BY AE, RPD-11-DDA ON 28/11/2011.
- ALL DIMENSIONS ARE IN METERS.
- ONLY WRITTEN DIMENSIONS ARE TO BE FOLLOWED.
- RESIDENTIAL POCKET R23 MEASURING 3.89 HA IS RESERVED FOR POLICE HOUSING.
- THE RESTORATION OF WATER BODIES WILL BE CONSIDERED AT THE TIME OF DESIGNING BY HUPW, ROHINI PLANNING OFFICE & PROJECT MANAGER (MPR), DDA RESPECTIVELY. THE REQUISITE DETAILS WITH AREA OF WATER BODIES TO BE PROVIDED BY EX. ENGG., RPD XI, DDA.
- AS PER THE LANDUSE PLAN OF APPROVED ZONAL DEVELOPMENT PLAN OF ZONE - "M" AT VARIOUS JUNCTIONS PROVISION FOR INTER-SECTION / GRADE SEPARATOR REQUIRES TO BE MADE. IN THE 302ND SCREENING COMMITTEE DATED 17-11-2011, IT WAS PROPOSED THAT LAND RESERVED FOR GRADE SEPARATOR (APPOX. 150M X 150M) SHALL BE FOLLOWED FOR ALL THE SCHEMES BY ARCHITECTURE DEPARTMENT (HOUSING & COMMERCIAL SCHEMES) AND LANDSCAPE UNIT FOR RESPECTIVE SCHEMES BASED ON LANDSCAPE PLAN OF ZONE - "M".
- THE ROAD AREA ADJACENT TO/ PASSING THROUGH RESIDENTIAL, PUBLIC AND SEMI-PUBLIC FACILITIES AND RECREATIONAL AREA IS INCLUDED IN THE RESPECTIVE LANDUSE AREA.
- THE MASTER PLAN/ ZONAL PLAN ROADS I.E. 100 M (UER II), 80 M (UER III), 60 M, 45 M AND 30 M LAND WHICH FORMS PART OF UNAUTHORISED COLONIES AND INTIMATED ABOUT HINDRANCES TO GNCTD LAND REQUIRED TO BE ACQUIRED BY DDA BASED ON REHABILITATION POLICY.
- THE SCHEME WAS APPROVED IN THE 308TH SCREENING COMMITTEE MEETING HELD ON 11-10-2012 VIDE ITEM NO. 97:2012. THE PROPOSAL AS REFLECTED IN THE AGENDA WAS APPROVED WITH CERTAIN OBSERVATIONS. SUBSEQUENTLY IN THE 309TH SCREENING COMMITTEE MEETING HELD ON 29-10-2012 THE OBSERVATION ON MINUTES OF THIS ITEM WAS RAISED BY DIRECTOR (PLG.), ROHINI ZONE - "M" & "N" AND IT WAS AGREED TO DELETE OPENING PARA OF THE OBSERVATION BEFORE SL. NO. (I). FURTHER TO ADD IN THE END OF THE OBSERVATION AT SL. NO. (VI), THE ASPECT WILL BE MONITORED BY THE COMMITTEE UNDER CHIEF ENGINEER, ROHINI.
- AS SUCH FOR SCHEME APPROVED, THE SCREENING COMMITTEE AGENDA WITH MINUTES FOR ITEM NO. 97:2012 DATED 11-10-2012 AND CONFIRMATION OF 309TH SCREENING COMMITTEE MEETING NO. 105:2012 BE READ IN TOTALITY.
- THE SAME HAS BEEN VERIFIED BY DY. DIRECTOR (ARCH.) COORD. ON DATE 15.01.2013.

LEGEND:

- R1** RESIDENTIAL
- RC1** RECREATIONAL
- CR1** CIRCULATION
- CL1** COMMERCIAL
- PSP1** PUBLIC/SEMI-PUBLIC FACILITIES
- LAND RESERVED FOR GRADE SEPARATOR
- ◉ WATER BODY

FILE NO.: DIR(PLG)/R/5040/05/149

**LAYOUT PLAN OF
SECTOR 40
ROHINI, PHASE V**

SCALE: 1 : 5000

DATE: OCTOBER 2012

PLG. ASSTT./PLG. OFFICER: [Signature]

ASSTT. DIR. (PLG.): [Signature]

BY: DIR. (PLG.): [Signature]

DIRECTOR (PLG.): [Signature]

रोहिणी
ROHINI
योजना कार्यालय, नई दिल्ली 10085
PLANNING OFFICE NEW DELHI 10085

ड्राइंग संख्या : DRG. NO.