

LANDUSE AREA STATEMENT OF SECTOR - 38

A. TOTAL AREA OF SECTOR - 38 **205.95 (206.58) HAC.**

B. LANDUSE BREAKUP OF AREA UNDER SECTOR - 38

LANDUSE	PROPOSED AREA				DDA ACQUIRED AREA			
	AS/APPROVED LOP (IN HA.)	(%)	AS/TSS (IN HA.)	(%)	AS/TSS (IN HA.)	(%)	AS/TSS (IN HA.)	(%)
RESIDENTIAL (GROSS)	125.87	60.93	125.01	60.69	33.18	26.36		
COMMERCIAL	11.34	5.49	11.35	5.52	0.00	0.00		
INDUSTRIAL	2.22	1.08	2.22	1.07	0.00	0.00		
RECREATIONAL	22.89	11.08	21.55	10.47	6.99	30.53		
PUBLIC/ SEMI-PUBLIC	19.68	9.53	11.46	5.76	0.06	0.33		
CIRCULATION	24.58	11.89	33.95	16.49	16.65	67.78		
TOTAL	206.58	100	205.95	100	56.89	27.54		

C. LANDUSE BREAKUP OF GROSS RESIDENTIAL AREA

LANDUSE	PROPOSED AREA				DDA ACQUIRED AREA			
	AS/APPROVED LOP (IN HA.)	(%)	AS/TSS (IN HA.)	(%)	AS/TSS (IN HA.)	(%)	AS/TSS (IN HA.)	(%)
RESIDENTIAL (NET)	82.74	65.73	83.00	66.4	23.54	28.45		
COMMERCIAL	5.29	4.21	5.07	4.05	0.67	12.74		
RECREATIONAL	13.51	10.73	15.45	12.36	1.87	13.82		
PSP/OCF	13.42	10.66	21.39	17.11	7.04	52.42		
CIRCULATION	10.91	8.67	0.10	0.07	0.07	0.63		
TOTAL	125.87	100	125.01	100	33.18	26.36		

D. DISTRIBUTION OF NET RESIDENTIAL AREA

NET AREA (IN HA.)	PROPOSED IN LOP			DDA ACQUIRED AREA			
	DU'S	(%)	POPULATION	NET AREA (IN HA.)	DU'S	(%)	POPULATION
82.74				23.54			
(EWS, LIG, MIG & OTHERS)	14500	100	69600	7062	100	31779	

E. PROPOSED NUMBERING OF RESIDENTIAL POCKETS
EIGHT (8) POCKETS I.E. A-1, A-2, B-1, B-2, B-3, B-4, C-1 & C-2 ARE EARMARKED FOR RESIDENTIAL. OUT OF THOSE EIGHT RESIDENTIAL POCKETS ONLY FOUR (4) RESIDENTIAL POCKETS I.E. POCKET B-1 (AREA 0.76 HA.), B-3 (AREA 3.57 HA.), C-1 (AREA 13.42 HA.) & C-2 (AREA 5.79 HA.) ARE PARTIALLY AVAILABLE FOR DEVELOPMENT AND REST FOUR (4) RESIDENTIAL POCKETS I.E. POCKET A-1, A-2, B-2 & B-4 ARE UNDER BUILT-UP/UNAUTHORIZED COLONIES.

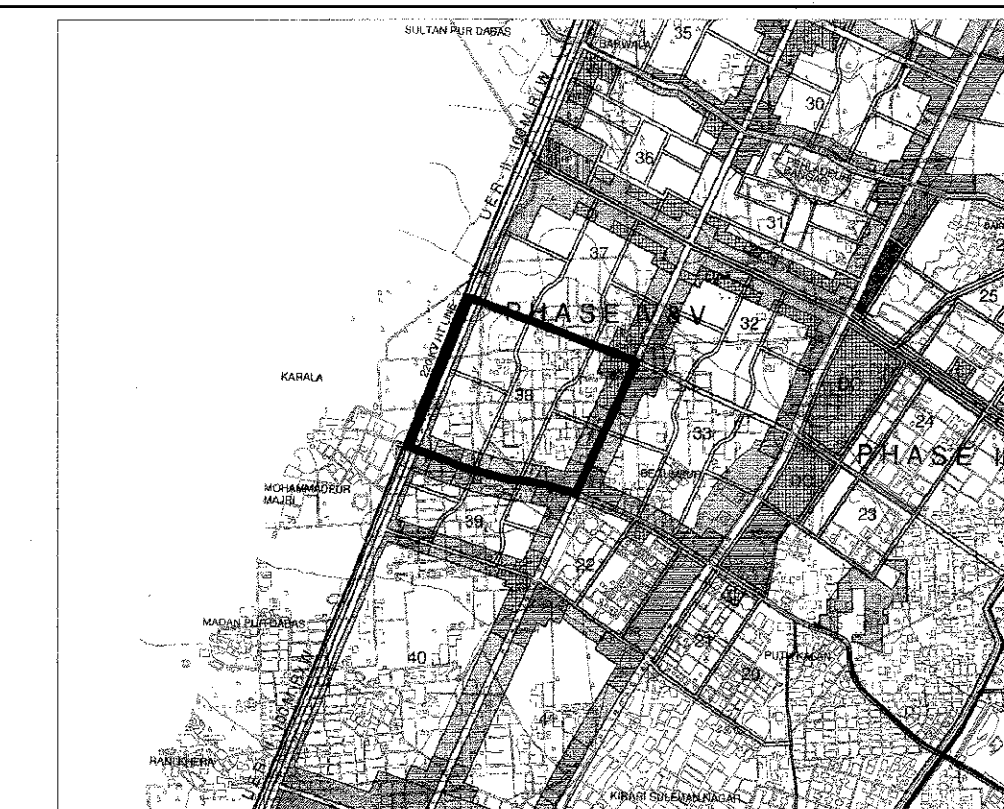

KEY PLAN

NOTE:

- THIS DRG. IS APPROVED IN THE 258TH SCREENING COMMITTEE MEETING HELD ON 18.07.2007 VIDE ITEM NO. III:2007 IN FILE NO. DIR. (PLG./R/5038/2005/138 WITH THE OBSERVATION THAT ONLY "GROUP HOUSING POCKETS" TO BE DEVELOPED AND NOT "GROUP HOUSING AND PLOTTED" (AS REFLECTED IN 3.0 (ii) OF THE AGENDA)
- THIS DRG. IS AUTHENTICATED BY DY. DIR. (ARCH.) COORD. DT. 21.8.07 AT PAGE 4/N IN FILE NO. DIR. (PLG./R/5038/2005/138
- THIS PLAN IS PREPARED BASED ON THE TOTAL STATION SURVEY (TSS) PROVIDED BY EXECUTIVE ENGINEER, RPD-1, DDA VIDE LETTER NO. F.2 (14) AE / I/IRPD - 1 / DDA / 86 DATED 22.01.2014. IN THE CURRENT PROPOSAL THE AREA CALCULATION IS BASED ON REDRAFTING OF ALREADY APPROVED LAYOUT PLAN OF SECTOR - 38, PHASE - V, ROHINI ON TOTAL STATION SURVEY. THE TOTAL AREA OF THE SECTOR AS PER TOTAL STATION SURVEY IS 205.95 HA. INSTEAD OF 206.58 HA AND AS PER APPROVED LAYOUT PLAN.
- ALL DIMENSIONS ARE IN METRES
- ONLY WRITTEN DIMENSIONS ARE TO BE FOLLOWED
- AREA UNDER PROPOSED 12 M. WIDE ROAD PASSING THROUGH COMMERCIAL AREA
- THE SCHEME WAS CONSIDERED AND APPROVED IN 322nd SCREENING COMMITTEE MEETING HELD ON 21.03.2014 VIDE ITEM NO. 42:2014.
- THE SAME HAS BEEN VERIFIED BY DY. DIR. (ARCH.) COORD. DT. 30.04.2014
- PROPOSED NUMBERING OF OTHER COMMUNITY FACILITY POCKETS (OCF-1 TO OCF-3) IN SECTOR 38, PHASE-V ROHINI, HAS BEEN APPROVED IN THE 326th SCREENING COMMITTEE MEETING HELD ON 17.11.2014 VIDE ITEM NO. 121:2014
- THE SAME HAS BEEN VERIFIED BY DY. DIRECTOR (ARCH.) COORD. DT. 8.12.2014

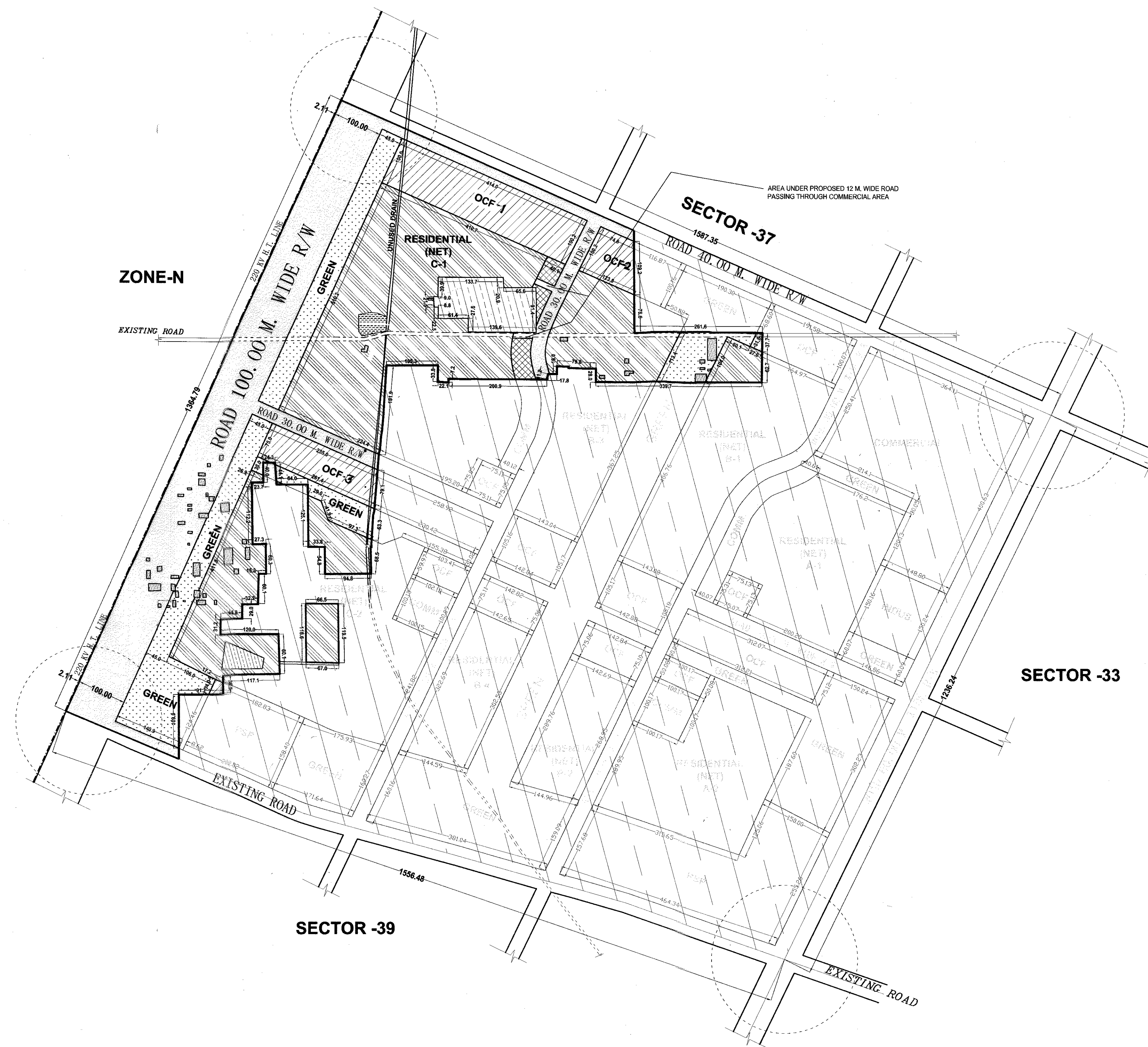

LEGEND:

	RESIDENTIAL		COMMERCIAL
	RECREATIONAL		PUBLIC/SEMI PUBLIC FACILITIES / OCF
	CIRCULATION		LAND RESERVED FOR GRADE SEPARATOR
	BUILT-UP / UNACQUIRED AREA		WATER BODY

FILE No: DIR(PLG)/R/5038/2005/138

**REVISED LAYOUT PLAN OF SECTOR- 38
PHASE -V, ROHINI**

माप SCALE	1:5000	
तारीख DATE	MARCH 2014	
योजना सहायक/ सहायक निदेशक (योजना) PLG. ASSTT. / ASSTT. DIR.(PLG.)-C		
सहायक निदेशक (योजना) ASSTT. DIR. (PLG.)		
उप निदेशक (योजना) DY. DIR. (PLG.)		
निदेशक (योजना) DIRECTOR (PLG.)		

