

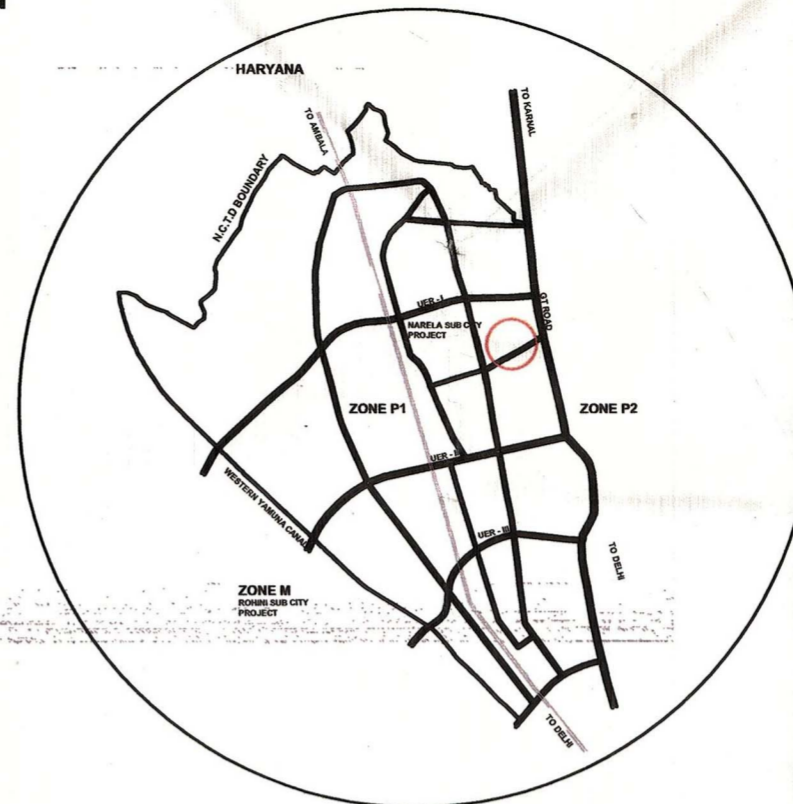

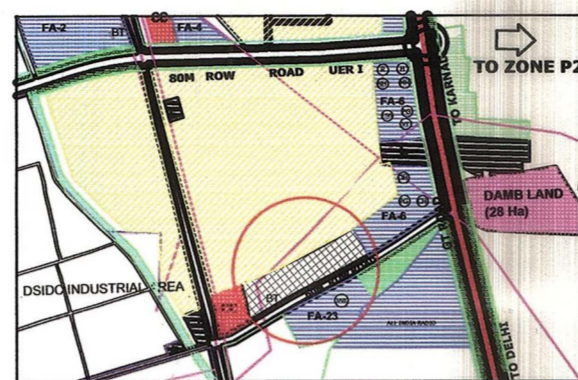

DELHI DEVELOPMENT AUTHORITY

KEY PLAN

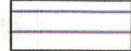

LEGEND:

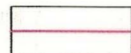
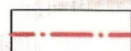
-  COMMERCIAL
-  PUBLIC & SEMI-PUBLIC
-  RECREATIONAL / GREEN BUFFER
-  HT LINE
-  SCHEME BOUNDARY

AREA STATEMENT :

AREA OF THE SCHEME : 16 HA.

PARTICULARS	AREA IN HA. (APP.)	% AGE
DISTRICT COURT	4.0	53.75
FIRE STATION	1.0	
BUS TERML. - DEPOT	0.8	
OTHER PLOT	2.8	
ESS 11 KV (1 NO.) (2M X 10M)	0.008	
PARKING	0.6	3.75
RECREATIONAL/ GREEN	4.8	30
CIRCULATION/ ROAD	2.0	12.5
TOTAL	16.0	100

NOTE :

- I) APPROVED ROAD CROSS-SECTION / DETAILS TO BE FOLLOWED.
- II) AREA AND DIMENSIONS WILL BE AS PER FEASIBILITY / DEMARCATIONS.
- III) STATUTORY CLEARANCES WILL BE TAKEN BY INDIVIDUAL AGENCIES.
- IV) DEVELOPMENT CONTROL NORMS WILL BE AS PER MPD-2021 / BBL '83.
- V) PLAN IS PREPARED ON THE BASIS OF P.T. SURVEY.
- VI) EXISTING TREES SHALL BE RETAINED AS FAR AS POSSIBLE.

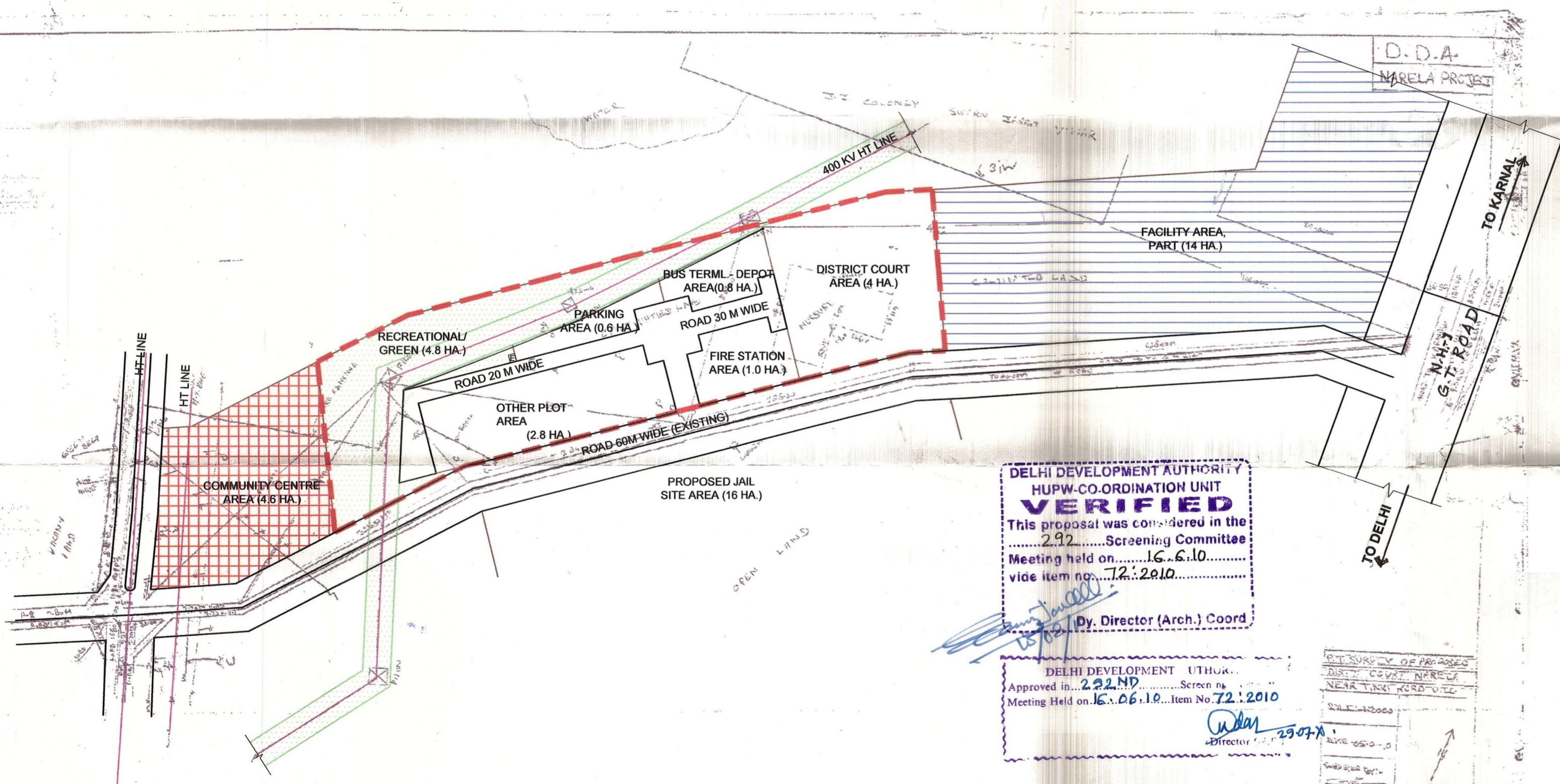

DELHI DEVELOPMENT AUTHORITY
HUPW.CO.ORDINATION UNIT
VERIFIED
 This proposal was considered in the
 292 Screening Committee
 Meeting held on 16.6.10 vide item no. 72:2010.
 By Director (Arch.) Coord

DELHI DEVELOPMENT AUTHORITY
 Approved in 292ND Screening Meeting
 Meeting Held on 16.06.10 Item No. 72:2010
 Director (Arch.) Coord

**APPROVED IN 292ND SCREENING COMMITTEE MEETING
 HELD ON 16.06.10 VIDE ITEM NO. 72 : 2010. (FILE NO.
 F15(304)2009/NP/PT.)**

TITLE:
LAYOUT PLAN OF GOVERNMENT LAND ALONG 60 M ROW ROAD, ZONE P-1

SCALE: 1:2000	DATE: 16.06.2010	DEALT BY:	DRAWING NO.:
PLG. DMAN: <i>RLK</i>	ASST. DIR.:	JT.DIR.(PLG)	NORTH: 
DIRECTOR(PLG): <i>29.07.10</i>	ADDL.COMMR.(PLG)	COMMR.(PLG.):	

NARELA PROJECT
PLANNING UNIT, DDA