

46/c



दिल्ली विकास प्राधिकरण
DELHI DEVELOPMENT AUTHORITY
रोहिणी योजना कार्यालय
ROHINI PLANNING OFFICE

AREA STATEMENT

CF-7 & CF-8
TOTAL AREA OF POCKETS* 38500.92 SQ.M.

DETAILS OF PLOT

PLOT NO.	USE	AREA (IN SQ.M.)
1	CF-I (COMMUNITY FACILITY)	3083.91
2	FAMILY WELFARE CENTRE	1093.98
3	DISPENSARY	1057.72
4	Sr. SECONDARY SCHOOL-I	6007.50
5	RELIGIOUS-I	400.00
6	RELIGIOUS-II	400.00
7	MULTIPURPOSE COMMUNITY HALL	2000.00
8	BANQUET HALL	1973.23
9	MULTILEVEL PARKING	2012.97
10	CF-II (COMMUNITY FACILITY)	2640.00
11	Sr. SECONDARY SCHOOL-II	6063.83
12	DIAGNOSTIC CENTRE	868.75
13	NURSING HOME/ POLYCLINIC	1825.45
14	MATERNITY HOME	1151.56
15	POLICE POST	1056.21
	CIRCULATION*	6855.32

* INCLUDING 540 SQ. M. AREA OF 18.0 M. WIDE CONNECTING ROAD TAKEN FROM RECREATIONAL/GREEN AREA BETWEEN POCKET CF-7 & CF-8.

NOTE :

- THE PROPOSAL IS BASED ON P.T. SURVEY SUPPLIED BY SURVEY UNIT OF ROHINI PLANNING OFFICE DATED 13.11.2014 AND MODIFIED ON 21.04.2015.
- DEVELOPMENT CONTROL NORMS WILL BE FOLLOWED AS PER MPD-2021.
- ALL DIMENSIONS ARE IN METERS. ONLY WRITTEN DIMENSIONS ARE TO BE FOLLOWED.
- THE SCHEME WAS APPROVED IN THE 347TH SCREENING COMMITTEE MEETING HELD ON 22.02.2017 VIDE ITEM NO. 13:2017

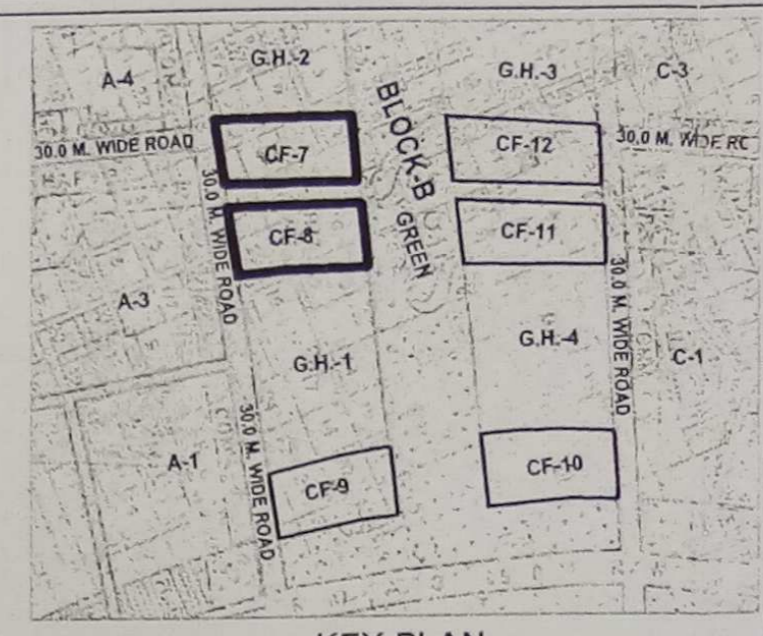

KEY PLAN

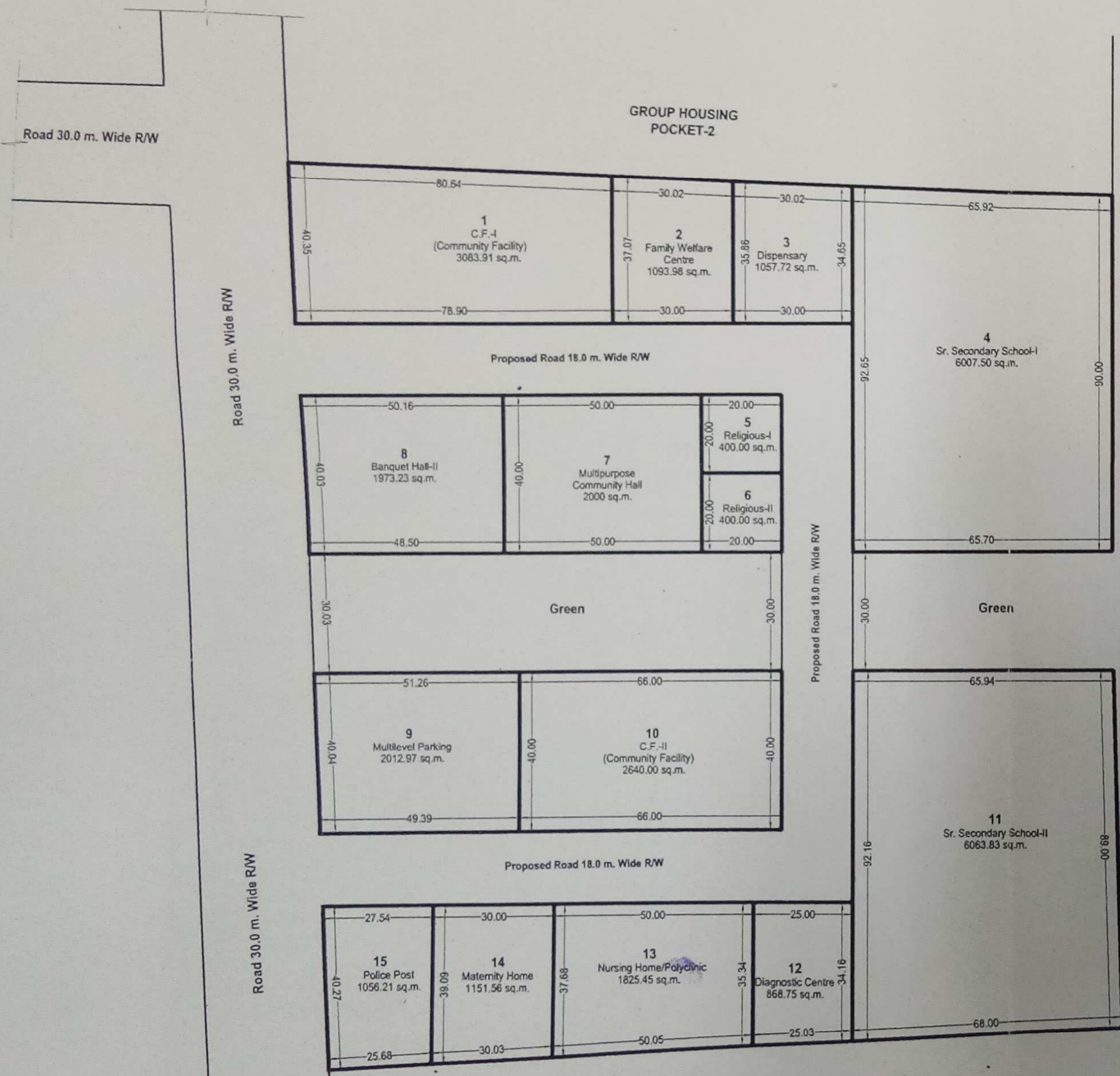

GROUP HOUSING POCKET-2

GROUP HOUSING POCKET-1

DELHI DEVELOPMENT AUTHORITY
IPW-CO-ORDINATION UNIT
VERIFIED
This proposal was considered in the
347th Screening Committee
Meeting held on 22.2.2017
Vide item no. 13:2017
27/2/17
By Director (Arch.) Co-ordn.

DELHI DEVELOPMENT AUTHORITY
CERTIFIED
Approved in 347th Screening
Committee Meeting Dt. 22.2.2017
vide Item No. 13:2017
Sign. H.K. Bhasoti
Name H.K. Bhasoti
Designation Director (Plg.) Rohini
Zone M & H (Pt)

The Proposal has been approved by the 347th Screening Committee held on 22.2.2017 vide item No. 13:2017 in File No. DIR (PLG) R/4028/2005/603

A. K. Malhotra
DY. DIR (PLG.) Rohini
Zone M & H (Pt)

Deepak Joshi
ASST. DIR. (PLG.) Rohini
Zone M & H (Pt)

Shakuntla Chopra
PLANNING ASST.
ZONE H (Pt)

FILE No: DIR(PLG)R/4028/2005/603

PROPOSED LAYOUT PLAN OF COMMUNITY FACILITIES POCKET (CF-7 & CF-8) IN BLOCK-B, SECTOR 28, PHASE IV, ROHINI

माप SCALE	1:1000	
तारीख DATE	JANUARY, 2017	
योजना सहायक PLG. ASSTT.	सहायक निदेशक (योजना) ASSTT. DIR. (PLG.) (ON CONTRACT)	
सहायक निदेशक (योजना) ASSTT. DIR. (PLG.)		
उप निदेशक (योजना) DY. DIR. (PLG.)		
निदेशक (योजना) DIRECTOR (PLG.)		
रोहिणी ROHINI योजना कार्यालय नई दिल्ली 110085 PLANNING OFFICE, NEW DELHI 110085		ड्रिंग संख्या DRG. NO. LCP/CF-7&8/28/17