



DELHI DEVELOPMENT AUTHORITY ROHINI PLANNING OFFICE

AREA STATEMENT:-

Total Area of Pocket	6.947	Hac.		
Area Under Residential	2.456	Hac.	=	35.35 %
Area Under Circulation/Parking	3.014	Hac.	=	43.39 %
Area Under Green / Parks	1.297	Hac.	=	18.67 %
Area Under Facilities/Utilities	0.180	Hac.	=	2.59 %
Total Area	6.947	Hac.	=	100.00 %

DETAIL OF PLOTS:-

Plot Area In Sqmt.	Size of Plot In Sqmt.	No. of Plots	Area under DU's	No. of DU's	Population	Numbering of Plots
60	5X12	196	11760	784	3528	179-374
32	4X8	400	12800	1200	5400	1-178 375-596
Total	-	596	24560	1984	8928	-

• NET RESIDENTIAL DENSITY: 285 DUE/Ha, 1286 PPH

• DEVELOPMENT CONTROL NORMS AS PER MPD - 2021

NOTES:

- THIS DRAWING IS BASED ON FEASIBILITY REPORT PLAN OF SECTOR 36, ROHINI FURNISHED BY LETTER NO.16 (265)/EE/RPD-8/DDA/487 DATED 10-05-2012
- THE FACILITIES/ UTILITIES COMPRISES OF DHALAO, ESS, MB, VB & DUSTBIN AS PER MPD-2021
- THE OTHER FACILITIES LIKE CH, CSC, UGR WILL BE PROVIDED IN THE NEARBY C.F. POCKET.
- THE SCHEME HAS BEEN APPROVED IN THE 297TH SCREENING COMMITTEE MEETING HELD ON 14-02-2011 VIDE ITME NO. 04-2011 AT P.4/N IN FILE NO. DIR.(PLG)/R/5036/A-1/2010 WITH THE FOLLOWING OBSERVATIONS:
(i) RCC BOUNDARY WALL AROUND THE POCKET BE ERECTED TO PROTECT THE LAND AND TO PREVENT ANY MISUSE IN FUTURE BY THE ALLOTTEES.
- THE SCHEME WAS CONSIDERED IN THE 297TH SCREENING COMMITTEE MEETING HELD ON 14-02-2011 VIDE ITME NO. 04-2011 AND THE SAME HAS BEEN VERIFIED BY DY. DIR. (ARCH) COORD. DATED 14-03-2011 IN FILE NO. DIR.(PLG)/R/5036/A-1/2010
- BOUNDARY WALL AROUND THE POCKET BE ERECTED AS PER THE STANDARD DESIGN PREPARED AND DULY APPROVED BY SCREENING COMMITTEE, DDA, ARCHITECTURE DEPARTMENT (HUPW) AND LANDSCAPE UNIT TO PROTECT THE LAND AND TO PREVENT ANY MISUSE IN FUTURE BY THE ALLOTTEES.
- THE SCHEME HAS BEEN APPROVED IN THE 305TH SCREENING COMMITTEE HELD ON 25-05-2012 VIDE ITME NO. 23-2012 AT PAGE No.14/N IN FILE No. DIR.(PLG)/R/5036/A-1/2010. THE SAME HAS BEEN CERTIFIED BY DIR.(PLG)/ROHINI DT. 01/06/12 AND VERIFIED BY DY. DIR. (ARCH) COORDIN. DT. 04-06-12.
- ☒ 11 KV ESS SITES (4 Nos.)
AREA = 80.00 M.EACH (10.0 X 8.0 M)
THE LOCATION OF 11 KV ELECTRIC SUB STATION MARKED ON LAYOUT PLAN DULY APPROVED BY TPDDL & FORWARDED BY EX-ENG. (ELECT) ED-7 DDA VIDE LETTER NO. F.2 (28) 12/EE/ED-7/DDA/2896 DATED 9-8-12 SUBSEQUENTLY LOCATION OF 11 KV ESS SITES WAS FINALISED IN THE MEETING HELD UNDER THE CHAIRMANSHIP OF DIRECTOR, (PLG) ROHINI ALONG WITH REPRESENTATIVE OF TPDDL.

(FILE NO: DIR(PLG)/R/5036/A-1/2010)

REVISED LAYOUT PLAN OF RESIDENTIAL POCKET -1, BLOCK-A, SECTOR 36, PHASE V, ROHINI

SCALE: 1:1000

DATE: MAY 2012

PLG. ASSTT.

ASSTT. DIR. (PLG)

DY. DIR. (PLG)

DIRECTOR (PLG)



ROHINI
PLANNING OFFICE NEW DELHI 110088

DRG. NO.:
S-36/PH-V
A-1/2

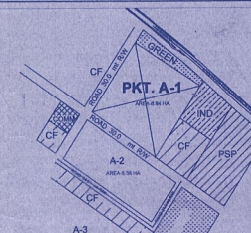

KEY-PLAN

CONTD. -
AND EX-ENG. ED-9 DDA ON 7-9-12 &
SUBSEQUENT SUBMISSION OF DETAIL OF
ESS SITES BY TPDDL THROUGH E-MAIL
ON 14-10-12 HAS BEEN APPROVED IN THE
308TH SCREENING COMMITTEE MEETING
HELD ON 11-10-12 VIDE ITME No. 36-2012.

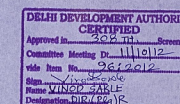

The Proposal has been approved by
the 308 TH Screening Committee
held on 11/10/12 vide Item No. 36-2012
in File No. Dir(PLG)/R/5036/A-1/2010
308-36-37/PH-V

ASSTT. DIR (PLG) DY. DIR. (PLG)

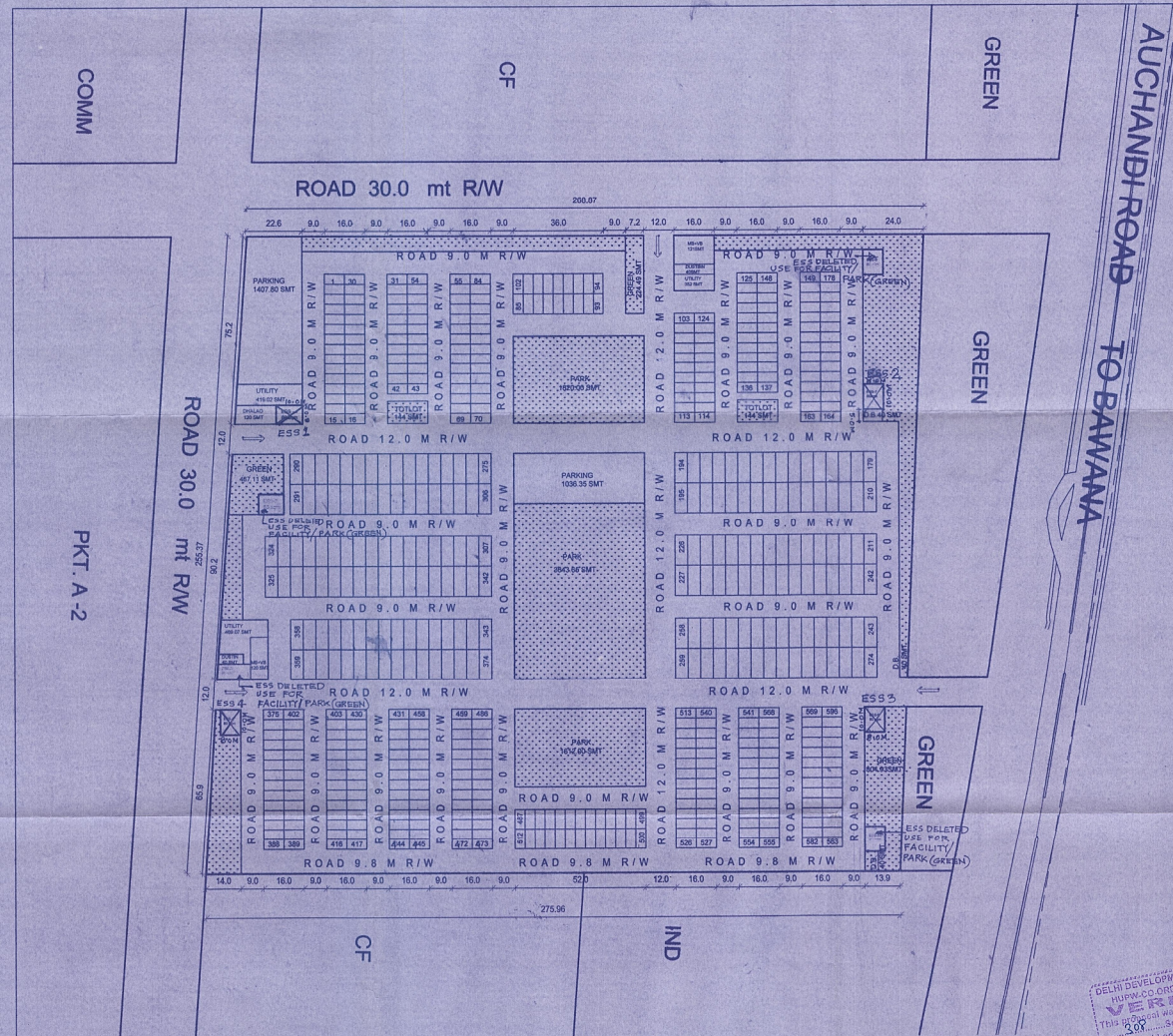
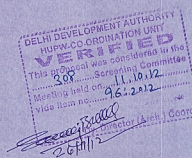

DELHI DEVELOPMENT AUTHORITY
HUPM COORDINATION UNIT
VERIFIED
This project was considered in the
308th Screening Committee
held on 11.10.12
in File No. DIR (PLG) 5036/2012
Sec 36-37/PH IV-V
By Director (Arch.) Coord
26/12/12

DELHI DEVELOPMENT AUTHORITY
CERTIFIED
Approved in 308th Screening
Committee Meeting Dt. 11.10.12
vide Item No. 36-37/2012
Sign: VIKAS SAKLE
Name: VIKAS SAKLE
Position: DIR (PLG) R

The Proposal has been approved by
the 308th Screening Committee
held on 11.10.12 vide Item No. 36-37/2012
in File No. DIR (PLG) 5036/2012
Sec 36-37/PH IV-V
Asstt. Dir. (PLG) Dy. Dir. (PLG)



DELHI DEVELOPMENT AUTHORITY
ROHINI PROJECT PLANNING AND DESIGN

AREA STATEMENT :-

TOTAL AREA OF POCKET = 5.35 HAC.

AREA UNDER RESIDENTIAL = 1.98 HAC.=37.01%

AREA UNDER CIRCULATION/PARKING=2.44 HAC.=45.61%

AREA UNDER GREEN/PARKS = 0.79 HAC.=14.77%

AREA UNDER FACILITIES/UTILITIES=0.14 HAC.=2.61%

DETAIL OF PLOTS

PLOT AREA IN Sq.M.	SIZE OF PLOT IN Mts.	No'S OF PLOTS	AREA UNDER PLOTS	No'S OF POPN. DU'S	NUMBERING OF PLOTS
60.00	5X12	154	9240	616	2772
32.00	4X8	248	7936	744	3348
26.00	3.25X8	100	2600	300	1350
TOTAL	---	502	19776	1660	7470

NET RESIDENTIAL DENSITY= 310 DU's/HAC=1396 PPH

NOTES:
1. The Facilities/ Utilities comprise of Dhaloo, ESS, MB, VB & Dustbin as per M.P.D-2021.
2. The other facilities like CH, CSC, UGR will be provided in the nearby CF pocket.

LAYOUT PLAN OF/POCKET -2, BLOCK-A, SECTOR -36, PHASE -V, ROHINI

DATE: DEC 2012 SCALE: 1:1000

BY: ASST. NAME: VIKAS SAKLE

APP: NAME: VIKAS SAKLE

FOR: DIR (PLG) NAME: VIKAS SAKLE

PREPARED BY (PLG) NAME: VIKAS SAKLE

ROHINI PROJECT OFFICE NEW DELHI 110085 DRG. No. S-36/PLA A2/1

PKT. A -1

ROAD 30.0 mt R/W

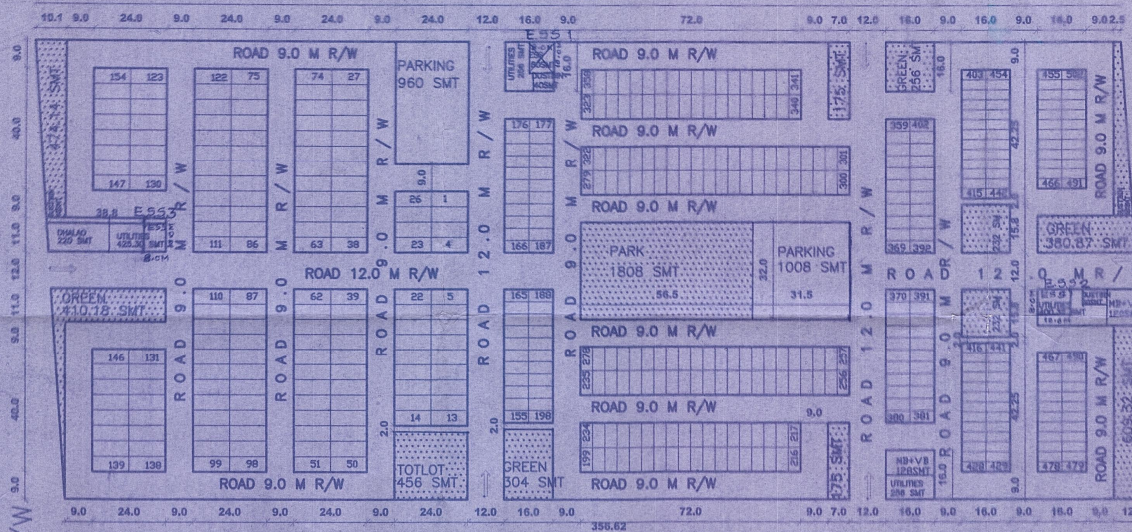

LEGEND

11 K.V. E.S.S. SITES (3 NOS)
AREA: 80.05 SQM EACH (10.0M X 8.0M)

THE LOCATION OF 11 K.V. ELECTRIC SUB-STATION MARKED ON LAYOUT PLAN DULY APPROVED BY TPDDL & FORWARDED BY EX. ENG. (ELECT) ED-7 ODA VIDE LETTER No F-2(23)12/EE/ED7 ODA/2690 DATED 9.8.12 SUBSEQUENTLY LOCATION OF 11 K.V. E.S.S. SITES WAS FINALISED IN THE MEETING HELD UNDER THE CHAIRMANSHIP OF DIRECTOR (PLG) ROHINI ALONGWITH REPRESENTATIVE OF TPDDL AND EX. ENG. ED-9 ODA ON 7.09.12 HAS BEEN APPROVED IN THE 308TH SCREENING COMMITTEE MEETING HELD ON 11.10.12 VIDE ITEM NO. 36-37/2012.

NOTES -

- THE SCHEME HAS BEEN APPROVED IN THE 297TH SCREENING COMMITTEE MEETING HELD ON 14.02.11 VIDE ITEM NO. 03:2011 AT P.4/N IN FILE NO. DIR (PLG) R/5036/A-2/2010 WITH THE FOLLOWING OBSERVATION.
- R.C.C. BOUNDARY WALL, AROUND THE POCKET BE ERECTED TO PROTECT THE LAND AND TO PREVENT ANY MISUSE IN FUTURE BY THE ALLOTTEES.
- THE SCHEME WAS CONSIDERED IN THE 297TH SCREENING COMMITTEE MEETING HELD ON 14.02.11 VIDE ITEM NO. 03:2011 AND THE SAME HAS BEEN VERIFIED BY DY. DIRECTOR (ARCH.) COORD. DT. 14.03.11 IN FILE NO. DIR (PLG) R/5036/A-2/2010

CF

COMM

CF

CF

GREEN

CF

ROAD 30.0 mt R/W

ROAD 24.0 mt R/W

ROAD 24.0 mt R/W

DELHI DEVELOPMENT AUTHORITY
CERTIFIED
 Approved by: 308TH Screening Committee Meeting Dt. 11/10/12
 vide Item No. 96/2012
 Sign: [Signature]
 Name: VINOD SARKI
 Designation: Director

The Proposal has been approved by the 308TH Screening Committee held on 11/10/12 vide Item No. 96/2012 in File No. DDA/2006/SEC/2012/Sec. 36-37/PH. III

Asstt. Dir. (P&D) [Signature]
 Dir. (P&D) [Signature]

DELHI DEVELOPMENT AUTHORITY
 HUDA, 308TH SCREENING COMMITTEE
 The proposal was considered by the 308TH Screening Committee Meeting held on 11/10/12 vide Item No. 96/2012
 [Signature]
 26/11/12 Director (Arch.) Coord.

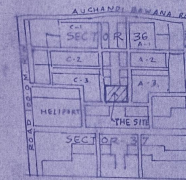
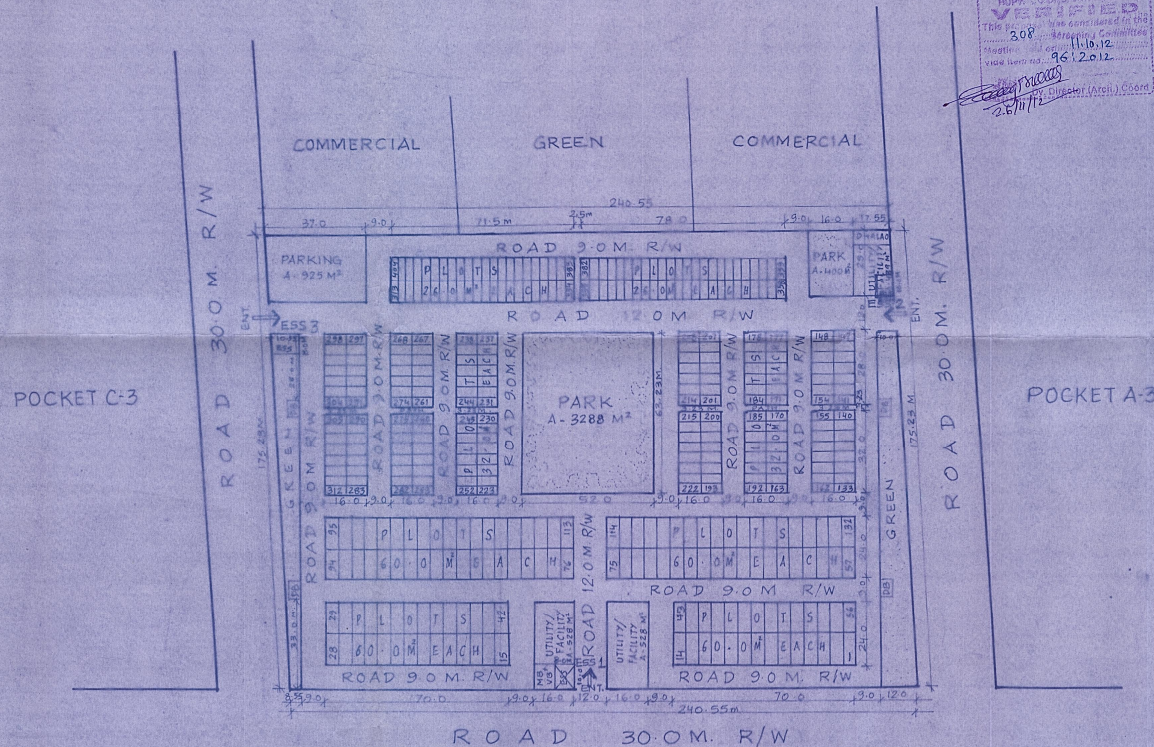

KEY PLAN



DELHI DEVELOPMENT AUTHORITY
 ROHINI PROJECT PLANNING & DESIGN

AREA STATEMENT

TOTAL AREA OF POCKET - 4.21 HAC.
 AREA UNDER RESIDENTIAL - 1.61 HAC. 38.24%
 AREA UNDER CIRCULATION/PARKING - 1.76 HAC. 41.81%
 AREA UNDER GREEN/PARKS - 0.69 HAC. 16.39%
 AREA UNDER UTILITIES/FACILITIES - 0.15 HAC. 3.56%

DISTRIBUTION OF RESIDENTIAL PLOTS

PLOT AREA	SIZE MXM	PLOT NOS	TOTAL PLOTS	AREA M²	DU'S	POPULATION
60.0M	5X12	1-132	132	7920	528	2376
32.0M	4X8	133-312	180	5760	540	2430
26.0M	3.25X8	313-404	92	2392	276	1242
TOTAL			404	16072	1344	6048

NET RESIDENTIAL DENSITY - 319 DU'S/HAC. 1436 PPH

DEVELOPMENT CONTROL NORMS AS PER MPD 2021

NOTES:-

- THE UTILITY/FACILITIES COMPRISES OF DHALAO, ESS, MS-403 AND DUSTBIN AS PER MPD 2021
- THE OTHER FACILITIES LIKE CH, CSC, WSR WILL BE PROVIDED IN THE NEARBY C.F. POCKET
- THE SCHEME HAS BEEN APPROVED IN THE 308TH SCREENING COMMITTEE MEETING HELD ON 11/10/12 VIDE ITEM NO. 96/2012 AT P-1/N IN FILE NO. DIR (PLG) R/5036/B-1/2010 WITH THE FOLLOWING OBSERVATION:-
 (i) RCC BOUNDARY WALL, AROUND THE POCKET BE ERRECTED TO PROTECT THE LAND AND TO PREVENT ANY MISUSE IN FUTURE BY THE ALLOTTEES.
- THE SCHEME WAS CONSIDERED IN THE 307TH SCREENING COMMITTEE MEETING HELD ON 11/02/11 VIDE ITEM NO. 65/2011 AND THE SAME HAS BEEN VERIFIED BY DDA/PH (ARCH) COORD. DT. 11/03/11 IN FILE NO. DIR (PLG) R/5036/B-1/2010

LEGEND

- 41 KV ESS (3 Nos.)
- AREA = 8010.50 M EACH (10.0 X 8.0 M)
- THE LOCATION OF 11 KV ELECTRIC SUB STATION MARKED ON LAYOUT PLAN DULY APPROVED BY TPDDL & FORWARDED BY EX. ENG. (ELECT) ED-7 DDA VIDE LETTER NO. F-2(25)12/EE/ED-7 DDA/2890 DATED 9.8.12. SUBSEQUENTLY LOCATION OF 11 KV ESS WAS FINALISED IN THE MEETING HELD UNDER THE CHAIRMANSHIP OF DIRECTOR (PLG) ROHINI ALONG WITH REPRESENTATIVE OF TPDDL AND EX. ENG. ED-9 DDA ON 7-9-12 HAS BEEN APPROVED IN THE 308TH SCREENING COMMITTEE MEETING HELD ON 11/10/12 VIDE ITEM No. 96/2012.

LAYOUT PLAN OF RESIDENTIAL POCKET-1 BLOCK 'B', SECTOR-36, ROHINI.

SCALE	1:1000	DATE	DEC. 2010	N
PLG. DM / PLG. ASSTT.	[Signature]	JT./DY. DIR (PLG)	[Signature]	
ASSTT. DIR (PLG)	[Signature]	DIRECTOR (PLG)	Vinod Sarki	



ROHINI

PROJECT OFFICE NEW DELHI 110085

S-36/PH.V
 B-1/1
 DRG. NO.

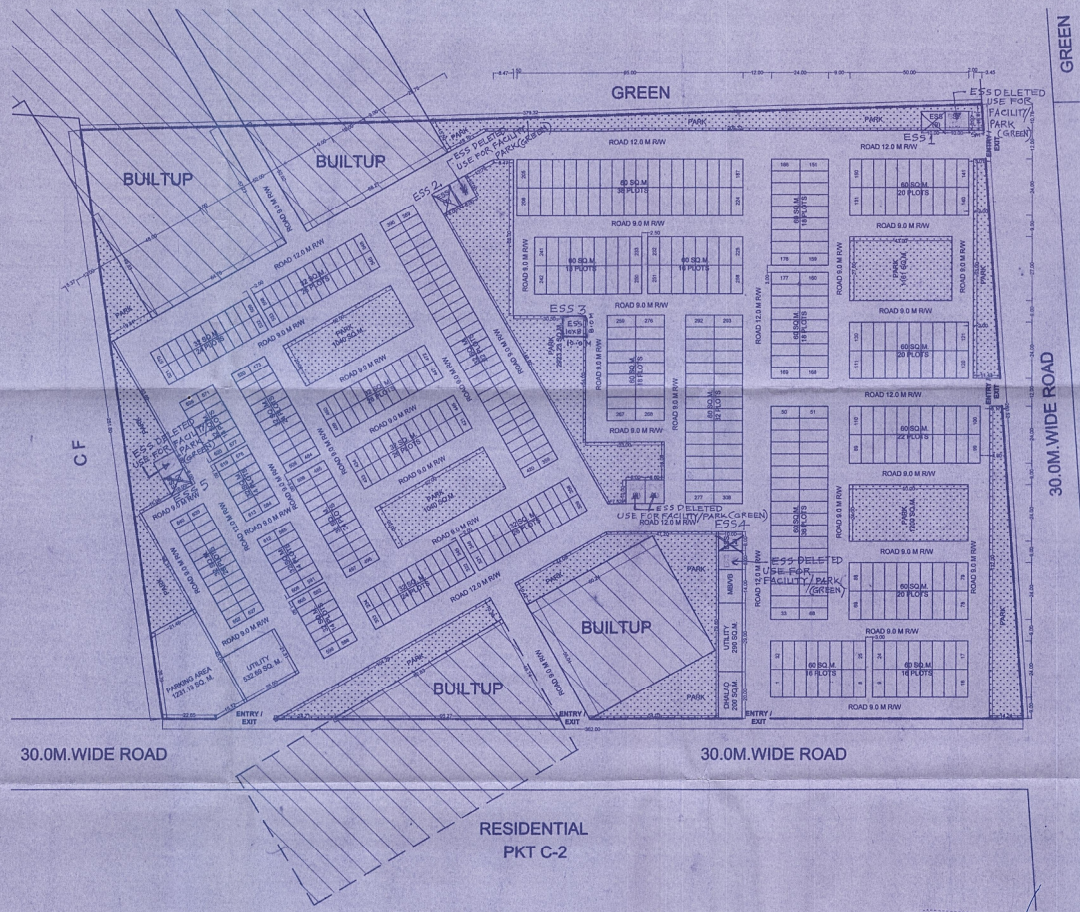

7/16

**DELHI DEVELOPMENT AUTHORITY
CERTIFIED**
Approved in: 2.02.12 Screening
Consent Meeting Dt: 11.10.12
vide Item No. 9612012
Sign: *[Signature]*
Name: *[Name]*
(In presence of *[Name]*)

The Proposal has been approved by the 308TH Screening Committee held on 11.10.12 vide item No. 9612012 in File No. DIR (PLG) R/5036/C-2/2012 Sec-36/31/PH-V-31
Asset Dir. (PLG) *[Signature]* Dy. Dir. (PLG) *[Signature]*

**DELHI DEVELOPMENT AUTHORITY
HUPW COORDINATION UNIT**
This plan has been considered in the 308TH Screening Committee Meeting held on 11.10.12 vide item No. 9612012 in File No. DIR (PLG) R/5036/C-2/2012 Sec-36/31/PH-V-31
By, Director (Arch) Coord.

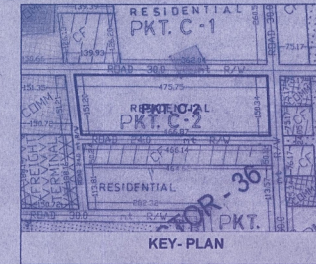

**DELHI DEVELOPMENT AUTHORITY
ROHINI PLANNING OFFICE**

AREA STATEMENT

1. TOTAL AREA OF THE POCKET	7.067 HA
• AREA UNDER BUILT-UP	0.270 HA
• NET AREA OF POCKET	6.797 HA

2. AREA BREAKUP

DETAILS OF USE	AREA (IN HA)	AREA (%)
RESIDENTIAL PLOTS	2.586	38.04
RECREATIONAL (PARK)	1.109	16.32
FACILITIES/UTILITIES	0.186	2.73
CIRCULATION / PARKING	2.917	42.91
TOTAL	6.797	100.00

DISTRIBUTION OF RESIDENTIAL PLOTS

PLOT AREA (IN SQ. M.)	PLOT SIZE (IN M.)	NUMBER OF PLOTS	AREA UNDER PLOTS (IN SQ. M.)	NUMBER OF DUS	POPULATION
60	12x5	3224	224	1340	896
32	8x4	225 612	388	12416	1164
TOTAL		612	2586	2080	9270

- NET RESIDENTIAL DENSITY: 291 DUS/HA, 1312 PPH
- DEVELOPMENT CONTROL NORMS AS PER MPD - 2021

NOTES:

- THIS PLAN IS PREPARED BASED ON THE LAND OWNERSHIP STATUS PROVIDED BY DD(M)/ ROHINI ON 15.05.2012 AND TOTAL STATION SURVEY PROVIDED BY EXECUTIVE ENGINEER, RPD-8, DDA VIDE LETTER NO. F.16 (265) EE / RPD - 8 / DDA / 487 DATED 10.05.2012.
- THE FACILITIES/ UTILITIES COMPRISES OF DHALAO, ESS, MB, VB & DUSTBIN AS PER MPD-2021.
- THE OTHER FACILITIES LIKE CH, CSC, UGR WILL BE PROVIDED IN THE NEARBY C.F. POCKET.
- ALL DIMENSIONS ARE IN METRES
- ONLY WRITTEN DIMENSIONS ARE TO BE FOLLOWED
- BOUNDARY WALL AROUND THE POCKET BE ERECTED TO PROTECT THE LAND AND TO PREVENT ANY MISUSE IN FUTURE BY THE ALLOTTEES AS PER THE STANDARD DESIGN PREPARED BY ARCHITECTURE DEPARTMENT (HUPW) AND LANDSCAPE UNIT WITH APPROVAL OF EM.DDA.
- THE SCHEME HAS BEEN APPROVED IN THE 305TH SCREENING COMMITTEE MEETING HELD ON 25.05.2012 VIDE ITEM No. 2412012 AT PAGE No. 4/1 IN FILE NO. DIR. (PLG) R/5036/C-2/2012. AND SUBSEQUENT CORRIGENDUM FOR CORRECTION IN MINUTES APPROVAL & ISSUED BY DY. DIR. (COORDN) ON 01.06.2012 WITH THE OBSERVATION THAT:-
• ADDITIONAL APPROACH ROAD OF 9.0M. EACH CONNECTING 24.0M. WIDE ROAD & 30.0M. WIDE ROAD THROUGH PARK BE PROVIDED FOR EASIER ACCESS TO FIRE TENDERS WHICH SHOULD NEVER BE BLOCKED BY THE RWA.
THE SAME HAS BEEN CERTIFIED BY DIR. (PLG) ROHINI DT. 01.06.12 AND VERIFIED BY DY. DIR. (ARCH) COORDN. DT. 04.06.12. *[Signature]*

(FILE NO: DIR(PLG)/R/5036/C-2/2012)

LAYOUT PLAN OF RESIDENTIAL POCKET-2, BLOCK- C, SECTOR-36, PHASE V, ROHINI

SCALE: 1:1000

DATE: MAY 2012

PLG. ASSTT./PLG. OFFICER *[Signature]*

ASSTT. DIR. (PLG) *[Signature]*

DY. DIR. (PLG) *[Signature]*

DIRECTOR (PLG) *[Signature]*



ROHINI
PLANNING OFFICE NEW DELHI 110085

DRG. NO.:
S-36/PH-V
C-2/1

RESIDENTIAL
PKT C-1

BUILTUP

CF

CF

COMMERCIAL

24.0M.WIDE ROAD

FREIGHT TERMINAL

30.0M.WIDE ROAD

BUILTUP

30.0M.WIDE ROAD

24.0M.WIDE ROAD

CF

30.0M.WIDE ROAD

CF

LEGEND

□ 11 KV ESS SITES (4 Nos.)

AREA= 30.0 SQ. M. EACH (10.0x8.0M)

THE LOCATION OF 11 KV ELECTRIC SUB STATION MARKED ON LAYOUT PLAN DULY APPROVED BY TPDDL & FORWARDED BY EX. ENG. (ELECT) ED 7 DDA VIDE LETTER No. F.2(33)12/EE/ED 7 DDA/2890 DATED 7-8-12. SUBSEQUENTLY LOCATION OF 11KV ESS 301 SQ. M. WAS FINALISED IN THE MEETING HELD UNDER THE CHAIRMANSHIP OF DIRECTOR (PLG) ROHINI ALONG WITH REPRESENTATIVE OF TPDDL AND EX. ENG. ED 3 DDA ON 7-9-12. SUBSEQUENT SUBMISSION OF DETAIL OF ESS SITES BY TPDDL THROUGH E-MAIL ON 4-10-12 HAS BEEN APPROVED IN THE 308TH SCREENING COMMITTEE MEETING HELD ON 11-10-2012 VIDE ITEM No. 9612012.

69/c



DELHI DEVELOPMENT AUTHORITY ROHINI PLANNING OFFICE

AREA STATEMENT

- TOTAL AREA OF THE POCKET 7.286 HA
- AREA BREAKUP

DETAILS OF USE	AREA (IN HA)	AREA (%)
RESIDENTIAL PLOTS	2.760	37.88
RECREATIONAL (PARK)	1.038	14.24
FACILITIES / UTILITIES	0.206	2.83
CIRCULATION / PARKING	3.282	45.05
TOTAL	7.286	100.00

DISTRIBUTION OF RESIDENTIAL PLOTS

PLOT AREA (IN SQ. M.)	PLOT SIZE (IN M.)	PLOT NUMBERS	TOTAL PLOTS	AREA UNDER PLOTS (IN SQ. M.)	NUMBER OF DUS	POPULATION
60	12x5	1-252	252	15120	1008	4536
32	8x4	253-642	390	12480	1170	5265
TOTAL			642	27600	2178	9801

• NET RESIDENTIAL DENSITY: 229 DU/HA, 1346 PPH

• DEVELOPMENT CONTROL NORMS AS PER MPD - 2021

NOTES:

- THIS PLAN IS PREPARED BASED ON THE LAND OWNERSHIP STATUS PROVIDED BY DD(M)/ROHINI ON 15.08.2012.
- THE CONFIRMATION OF AREA & DIMENSION OF THE POCKET IS SOUGHT FROM ENGG. WING, ROHINI VIDE LETTER NO. DIR (PLG)/R/4001/PH IV-V/2010/227 DATED 03.05.2012 AND IS STILL AWAITED.
- THE FACILITIES/ UTILITIES COMPRISES OF DHALAO, ESS, MB, VB & DUSTBIN AS PER MPD-2021.
- THE OTHER FACILITIES LIKE CH, CSC, UGR WILL BE PROVIDED IN THE NEARBY C.F. POCKET.
- ALL DIMENSIONS ARE IN METRES
- ONLY WRITTEN DIMENSIONS ARE TO BE FOLLOWED
- BOUNDARY WALL AROUND THE POCKET BE ERECTED TO PROTECT THE LAND AND TO PREVENT ANY MISUSE IN FUTURE BY THE ALLOTTEES AS PER THE STANDARD DESIGN PREPARED BY ARCHITECTURE DEPARTMENT (HUPW) AND LANDSCAPE UNIT WITH APPROVAL OF EM.DDA.
- THE SCHEME HAS BEEN APPROVED IN THE 305TH SCREENING COMMITTEE MEETING HELD ON 25.05.2012 VIDE ITEM NO. 26/2012 AT P. 4/N IN FILE NO. DIR. (PLG)/R/5037/A-1/2012 WITH THE FOLLOWING OBSERVATION:
 - AN APPROACH ROAD OF 12M WIDE BE PROVIDED THROUGH GREEN CONNECTING THE 80M WIDE ROW FOR EASIER ACCESS TO FIRE TENDERS WHICH SHOULD NEVER BE BLOCKED BY THE RWA.

THIS SAME HAS BEEN CERTIFIED BY DIR. (PLG) ROHINI DT. 01/06/12 AND VERIFIED BY DY. DIR. (ARCH) CO-ORDIN. DT. 04/06/12. *M. Singh*

(FILE NO: DIR(PLG)/R/5037/A-1/2012)

LAYOUT PLAN OF RESIDENTIAL POCKET-1, BLOCK-A, SECTOR-37, PHASE V, ROHINI

SCALE: 1:1000

DATE: MAY 2012

PLG. ASSTT. / PLG. OFFICER *M. Singh* *J. Datta*

ASSTT. DIR. (PLG) *Arjun*

DY. DIR. (PLG) *Arjun*

DIRECTOR (PLG) *V. V. Singh* 09/06/2012



ROHINI
PLANNING OFFICE NEW DELHI 110085

DRG. NO.:
S-37/PH-V
A-1/1

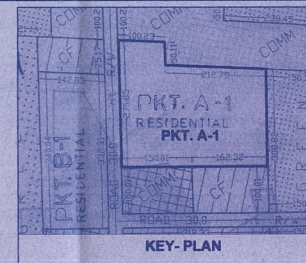

KEY-PLAN

ROAD 60.0 M RW

GREEN
GREEN
GREEN

COMMERCIAL

COMMERCIAL

COMMERCIAL

CF

RESIDENTIAL
PKT B-1

ROAD 30.0 M RW

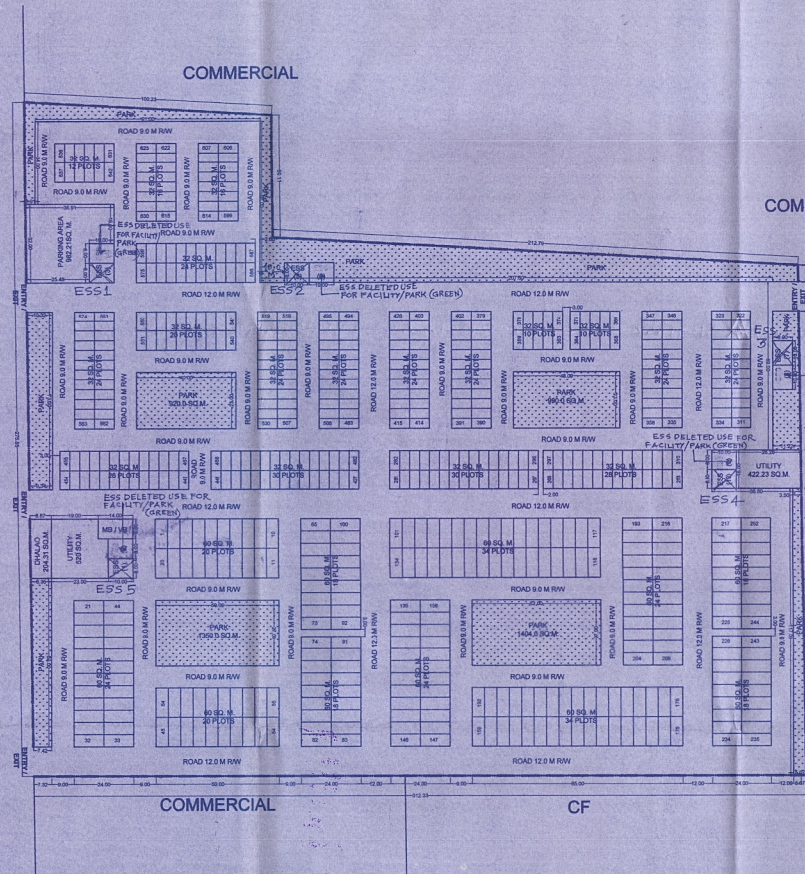

DELHI DEVELOPMENT AUTHORITY
CERTIFIED
Approved in: 2012/05/01
Committee Meeting No. 11/10/12
vide Item No. 26/2012
Sign: *M. Singh*
Name: M. Singh
Designation: PLG (PLG) R

The Proposal has been approved by the 305th Screening Committee held on 25.05.2012 vide Item No. 26/2012 in File No. DIR(PLG)/R/5037/A-1/2012 dated 09.06.2012.

Arjun *Arjun*
Asstt. Dir. (PLG) Dy. Dir. (PLG)

DELHI DEVELOPMENT AUTHORITY
PLANNING CO-ORDINATION UNIT
ROHINI PLANNING OFFICE
This drawing was prepared in the
Screening Committee
on 09.06.2012
by *M. Singh*
Director (Arch) Coord.

LEGEND:

- 11 KV ESS SITES (5 Nos.)
- AREA = 80.0 SQ.M EACH (10.0 X 8.0 M)

THE LOCATION OF 11 KV ELECTRIC SUB STATION MARKED ON LAYOUT PLAN DULY APPROVED BY TPDDL & FORWARDED BY EX. ENG. (ELECT) ED-7 DDA VIDE LETTER NO. F-2(23)12/EE/ED7 DDA/2890 DATED 9-8-12. SUBSEQUENTLY LOCATION OF 11 KV ESS SITE WAS FINALISED IN THE MEETING HELD UNDER THE CHAIRMANSHIP OF DIRECTOR (PLG) ROHINI ALONG WITH REPRESENTATIVE OF TPDDL AND EX. ENG. ED-3 DDA ON 7-9-12 & SUBSEQUENT SUBMISSION OF DETAIL OF ESS SITES BY TPDDL THROUGH E-MAIL ON 4-10-12. HAS BEEN APPROVED IN THE 308TH SCREENING COMMITTEE MEETING HELD ON 11-10-2012 VIDE ITEM NO. 36/2012.

68/c

LEGEND

11 KV ESS SITES (4 Nos.)

AREA = 80.0 SQ.M. EACH (10-0X8-0M)

THE LOCATION OF 11 KV ELECTRIC SUB STATION MARKED ON LAYOUT PLAN DULY APPROVED BY TPDDL & FORWARDED BY EX-ENG. (ELECT) ED-7 DDA VIDE LETTER No. F-2(23)12/EE/ED-7/DDA/2890 DATED 9-8-12. SUBSEQUENTLY LOCATION OF 11 KV ESS SITES WAS FINALISED IN THE MEETING HELD UNDER THE CHAIRMANSHIP OF DIRECTOR (PLG) ROHINI ALONG WITH REPRESENTATIVE OF TPDDL AND EX-ENG. ED-7 DDA ON

NOTE:

IN THE APPROVED LAYOUT PLAN, TABLE ON DISTRIBUTION OF PLOTS IN PLOT AREA OF 26.0 SQ.M. 142 & 277 ARE CORRECTED WHICH WERE INADVERTANTLY WRITTEN AS 242 & 227 HAS BEEN APPROVED BY COMM. (PLG) II DDA ON 18/5/12 AT PAGE No. 12/N IN FILE No. DIR. (PLG) R/5037/B-3/2011.

DELHI DEVELOPMENT AUTHORITY
HUPW-08 ORDINATION UNIT

VERIFIED

This proposal was considered in the
308th Screening Committee

Meeting held on 11.10.12

vide item no. 96/2012

COMMERCIAL

7-9-12 HAS BEEN APPROVED
IN THE 308TH SCREENING
COMMITTEE MEETING HELD ON
11-10-12 VIDE ITEM No. 96/2012.

RESIDENTIAL

**DELHI DEVELOPMENT AUTHORITY
CERTIFIED**

Approved in 308th Screening

Committee Meeting Dt. 11.10.12

vide item No. 96/2012

Sign: Vinod Sake

Name VINOD SAKLE

Designation DIR. (PLG) R

The Proposal has been approved by
the 308th Screening Committee
held on 11.10.12 vide item No. 96/2012
in File No. DIR. (PLG) R/5037/B-3/2011

DELHI DEVELOPMENT AUTHORITY
ROHINI PROJECT PLANNING

AREA STATEMENT

1. TOTAL AREA OF THE POCKET	4.92 HA	
2. AREA BREAKUP		
DETAILS OF USE	AREA (IN HA)	AREA (%)
RESIDENTIAL PLOTS	2.92	59.35
RECREATIONAL SPACES	0.68	13.82
FACILITIES / UTILITIES	0.18	3.66
GRADUATION / PARKING	2.52	51.05
TOTAL	4.92	100.00

DISTRIBUTION OF RESIDENTIAL PLOTS

PLOT AREA (SQ. M.)	PLOT SIZE (M x M)	TOTAL PLOTS	FORECASTED NO. OF INHABITANTS	POPULATION
10	10 x 10	64	256	722
12	12 x 12	64	256	722
15	15 x 15	64	256	722
TOTAL		192	768	2266

* NET RESIDENTIAL DENSITY: 370 DUAHA/1960 PPM

* DEVELOPMENT CONTROL NORMS AS PER MCD - 2021

NOTES:

- THIS PLAN IS PREPARED BASED ON THE LAND OWNERSHIP STATUS PROVIDED BY DY. DIRECTOR (MLH) DDA VIDE LETTER No. 774/CE/D/2010/1142 DATED 22.11.2011 AND TOTAL STATION SURVEY PROVIDED BY EXECUTIVE ENGINEER, RPO/DA VIDE LETTER No. F3 (MKE) DATED 1 RMD 9/04/2011 DATED 24.11.2011
- ALL DIMENSIONS ARE IN METRES
- ONLY WRITTEN DIMENSIONS ARE TO BE FOLLOWED
- ESS: ELECTRIC SUBSTATION (11 KV), MR. MUD. BOOTH, VB, VESITABLE BOUNDARY
- BOUNDARY WALL AROUND THE POCKET BE ERRECTED TO PROTECT THE LAND AND PREVENT ANY MOBILE INFLUENCE BY THE ALLOTTED
- APPROVED BY P.C. DIR. (PLG) R/5037/B-3/2011. IT SHALL BE FORWARDED TO THE SCREENING COMMITTEE
- THE PROPOSAL HAS BEEN APPROVED IN THE 308TH SCREENING COMMITTEE MEETING HELD ON 21/12/2011 VIDE ITEM No. 109/2011 & THE SAME IS CERTIFIED BY THE DIR. (PLG) ROHINI DT. 17/02/2012 & VERIFIED BY THE DY. DIR. (ARCH) CO-ORDN. ON DT. 03/03/12 IN FILE No. DIR. (PLG) R/5037/B-3/2011.

APPROVED BY V.C. DDA ON 25.12.11. IT WILL BE RATIFIED BY THE SCREENING COMMITTEE

FILE No. DIR. (PLG) R/5037/B-3/2011

LAYOUT PLAN OF POCKET B-3, SECTOR 37, PHASE V, ROHINI

SCALE: 1:1000

DATE: 28.11.2011

PLG, ASSTT. PLG OFFICER

ASSTT. DIR. (PLG)

DY. DIR. (PLG)

DIRECTOR (PLG)

ROHINI

FILE NO. 37/PLV B-3/1

ROAD 30 M RW

COMMERCIAL

GREEN

67/c



DELHI DEVELOPMENT AUTHORITY
ROHINI PROJECT PLANNING & DESIGN

AREA STATEMENT

TOTAL AREA OF POCKET - 13.79 HA.
AREA UNDER RESIDENTIAL - 5.2 HA 37.71%
AREA UNDER CIRCULATION/PARKING - 5.19 HA 37.64%
AREA UNDER GREEN/PARKS - 3.0 HA 21.75%
AREA UNDER UTILITY/FACILITIES - 0.4 HA 2.90%
DISTRIBUTION OF RESIDENTIAL PLOTS

PLOT AREA	SIZE mx m	PLOT NUMBERS	TOTAL PLOTS	AREA m ²	D.U'S	POPULATION
60.0 M ²	50 X 120	681 - 1184	504	30240	2016	9072
32.0 M ²	40 X 80	1 - 680	680	21760	2040	9180
TOTAL			1184	52000	4056	18252

NET RESIDENTIAL DENSITY - 294 DUS/HA. 1324.PPH

DEVELOPMENT CONTROL NORMS AS PER M.P.D - 2021

- NOTE
- THE UTILITY FACILITIES COMPRISES OF DHALAO ESS, MB-VB, DUSTBIN AS PER MPD-2021
 - THE OTHER FACILITIES LIKE CSC, UGR, WILL BE PROVIDED IN THE NEARBY CP POCKET
 - THE SCHEME HAS BEEN APPROVED IN THE 297TH SCREENING COMMITTEE MEETING HELD ON 14.02.11 VIDE ITEM NO. 07.2011 AT P-1/N IN FILE NO. DIR. (PLG)/5037/C-1/2010 WITH THE FOLLOWING OBSERVATION -
 - 1) RCC BOUNDARY WALL, AROUND THE POCKET BE ERECTED TO PROTECT THE LAND AND TO PREVENT ANY MISUSE IN FUTURE BY THE ALLOTTEES.
 - 2) THE SCHEME WAS CONSIDERED IN THE 297TH SCREENING COMMITTEE MEETING HELD ON 14.02.11 VIDE ITEM NO. 07.2011 AND THE SAME HAS BEEN VERIFIED BY THE DY. DIR. (ARCH.) COORD. DT. 14.03.11 IN FILE NO. DIR. (PLG)/5037/C-1/2010
 - 3) IN THE APPROVED LAY OUT PLAN, PLOT NO. 382, IS CORRECTED WHICH WAS INADVERTENTLY SHOWN AS PLOT NO. 383 HAS BEEN APPROVED BY COMM. C.P.L. DT. 14.03.11 IN FILE NO. DIR. (PLG)/5037/C-1/2010

LAYOUT PLAN OF RESIDENTIAL PKT-I BLOCK-C SECTOR-37 ROHINI PH-V

SCALE	1:1000	DATE	DEC-2010	N
PLG. DIR./PLG. ASST.	JYOTI DIR. (PLG)	ASST. DIR. (PLG)	DIRECTOR (PLG)	

ROHINI
PROJECT OFFICE NEW DELHI 110085
S 37 / PH V
C 1 / 1
DRG NO.

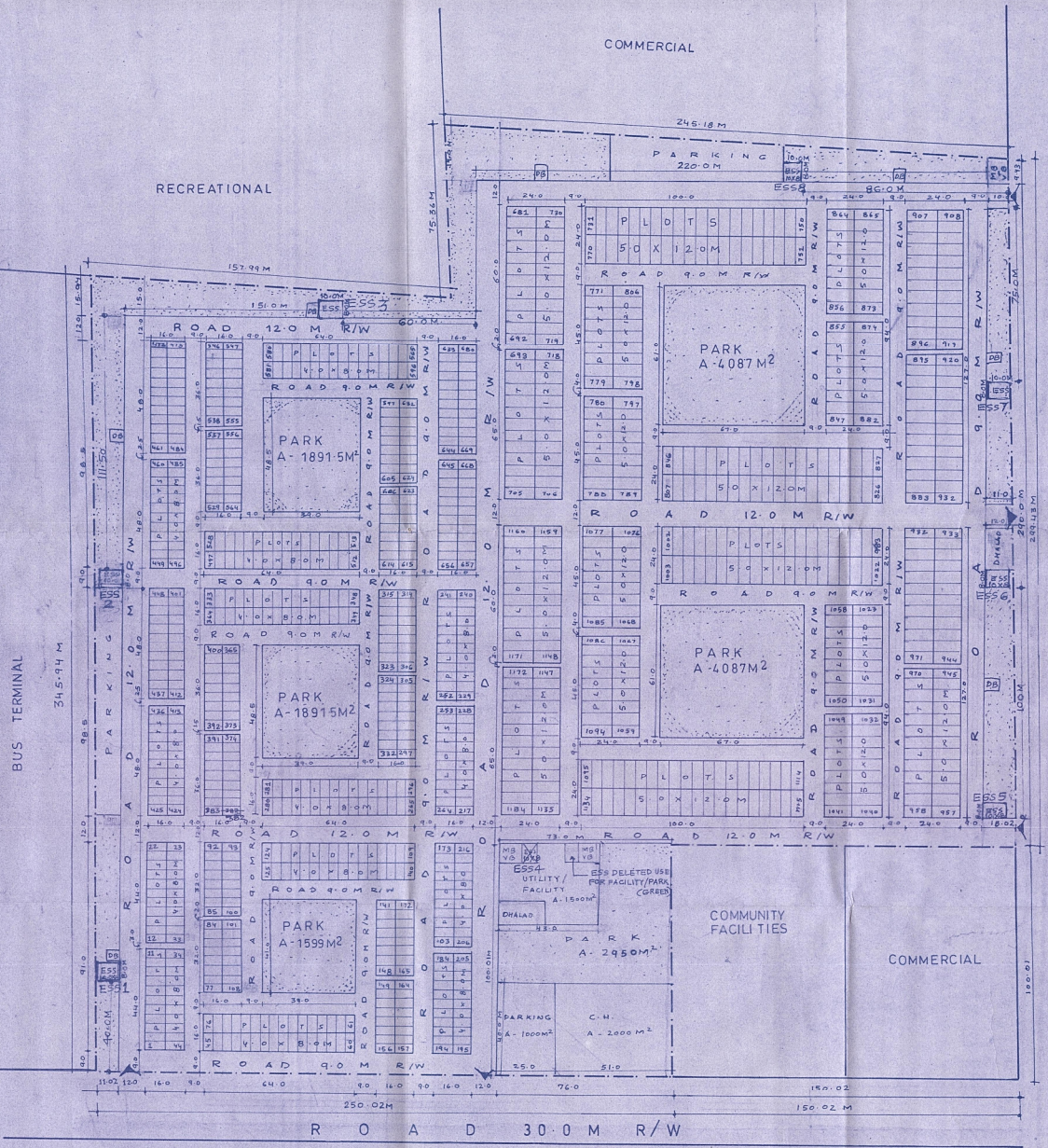

RESIDENTIAL B-3

LEGEND

11. KV. ESS SITES (B No.)
AREA = 20.0 SQ.M EACH (10.0 X 8.0 M)

THE LOCATION OF 11 KV ELECTRIC SUB STATION MARKED ON LAYOUT PLAN DULY APPROVED BY T.P.D.L. & FORWARDED BY EX. ENG. (ELECT.) ED-7 DDA VIDE LETTER NO. F.2 (23)/12/EE/ED/7/DDA DATED 9-8-12. SUBSEQUENTLY LOCATION OF 11 KV ESS SITES WAS FINALISED IN THE MEETING HELD UNDER THE CHAIRMANSHIP OF DIRECTOR (PLG) ROHINI ALONG WITH REPRESENTATIVE OF T.P.D.L. AND EX. ENG. ED-7 DDA ON 7-9-12. HAS BEEN APPROVED IN THE 305TH SCREENING COMMITTEE MEETING HELD ON 11-10-12 VIDE ITEM NO. 94.2012.

DELHI DEVELOPMENT AUTHORITY CERTIFIED
Approved in 296TH Screening Committee Meeting Dt. 11.10.12 vide Item No. 94.2012
Sign: *[Signature]*
Name: MANOJ KUMAR
Designation: P.E. (PLG)

The proposal has been approved by the 296TH Screening Committee held on 11.10.12 vide item No. 94.2012 in File No. DIR. (PLG)/5037/C-1/2010 dt. 26.31/11/2010

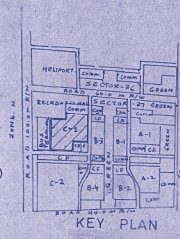

COMMERCIAL

PLOT AREA (IN SQ. M.)	PLOT SIZE (IN M)	PLOT NUMBERS	TOTAL PLOTS	AREA UNDER PLOTS (IN SQ. M.)	NUMBER OF DUS	POPULATION
60	12x5	1-728	728	43680	2912	13104
32	8x4	729-1400	672	21504	2016	9072
TOTAL			1400	65184	4928	22176

• DEVELOPMENT CONTROL NORMS AS PER MPD - 2021

1. THIS PLAN IS PREPARED BASED ON THE LAND OWNERSHIP STATUS PROVIDED BY DD(M) ROHINI ON 15.05.2012.
2. THE CONFIRMATION OF AREA & DIMENSION OF THE POCKET IS SOUGHT FROM ENGG. WING, ROHINI VIDE LETTER NO. DIR (PLGR)/4001/PH I-V/31/2010/227 DATED 03.05.2012 AND IS STILL PENDING.
3. THE FACILITIES/UTILITIES COMPRISES OF DHALAO, ESS, MB, VB & DUSTBIN AS PER MPD-2021.
4. THE OTHER FACILITIES LIKE C.F, CSC, UGR WILL BE PROVIDED IN THE FUTURE OF THE POCKET.
5. ALL DIMENSIONS ARE IN METERS
6. ONLY WRITTEN DIMENSIONS ARE TO BE FOLLOWED
7. BOUNDARY WALL AROUND THE POCKET BE ERECTED TO PROTECT THE LAND AND TO PREVENT ANY MISUSE IN FUTURE BY THE ALLOTTEES AS PER THE STANDARD DESIGN PROVIDED BY ARCHITECTURE DEPARTMENT (HUPW) AND LANDSCAPE UNIT WITH APPROVAL OF EM.DDA.
8. THE SCHEME HAS BEEN APPROVED IN THE 305TH SCREENING COMMITTEE MEETING HELD ON 25.05.2012 VIDE ITEM NO. 27/2012.
9. THE SCHEME IS APPROVED BY THE DIR (PLGR)/4003/PC-2012 WITH THE FOLLOWING OBSERVATION:
 - a. THE 9M WIDE ROAD IN FRONT OF PLOT NO. 377 TO 387 AND PLOT NO. 405 TO 427 BE INCREASED TO 12M WIDE ROAD WITH RELOCATION OF ENTRY/EXIT, MB/VB, DHALAO, UTILITY, ESS (S) & DUSTBIN.
 - b. PROVIDE FREE ACCESS OF FIRE TENDER, ESPECIALLY TO THE TWO UTILITY AREA AND THE RESIDENTIAL POCKET.

THE SAME HAS BEEN CERTIFIED BY DIR. (PLG.) ROHINI DT. 01/06/12
AND VERIFIED BY, DY. DIR. (ARQ.) COORDN. DT. 04/06/12 *meah*

11 KVESS SITES (11 Nos.)
PROP. AS/LOP AREA = 80.0 SQ.M EACH (10.0 X 8.0M)

THE LOCATION OF 11 KV ELIGRIC 3/5 STATION MARKED ON LAYOUT
PLAN DUD VIDE APPROVED BY TPD-8 FORWARDED BY ENG. EDC (ELCT)
ENG. TPD-8 VIDE LETTER NO. F-2(73)12/EE/ED-7 DDA/2839 OF DATED
9-8-80 SUBSEQUENTLY LOCATION OF 11 KV E55 STATION WAS FINALISED
BY TPD-8. THE MEETING HELD UNDER THE CHAIRMANSHIP OF DIRECTOR (P)
BOMBAY ALONG WITH REPRESENTATIVES OF TPD-8 AND BY ENG. EDC
FOA ON 7-3-82. 9. SUBSEQUENT SUBMISSION OF DETAIL OF E55 SITES
BY TPD-8 THROUGH E-MAIL ON 4-10-82 HAS BEEN APPROVED IN THE
9-10-82 SCREENING COMMITTEE MEETING HELD ON 11-10-82 VIDE
ITEM NO. 2612012.

(FILE No: DIR(PLG)/R/5037/C-2/2012)

**LAYOUT PLAN OF RESIDENTIAL
POCKET-2, BLOCK- C, SECTOR-37,
PHASE V, ROHINI**

SCALE: 1:1000

DATE : MAY 2012

PLG. ASST. / PLG. OFFICER *H. H. H. H.* *JD*

ASSTT. DIR. (PLG)

DY. DIR. (PLG)

DIRECTOR (PLG)



ROHINI
PLANNING OFFICE NEW DELHI 110085

DRG. NO. :
S- 37 / PH-V
C-2 / 1

OCF
SECTOR - 38

DELIVERED BY POSTAL AUTHORITY
 HUPWA COORDINATION UNIT
VERIFIED
 This report was considered
 308th
 11.10.12
 9612012
 [Signature]
 [Signature]

DELHI DEVELOPMENT AUTHORITY
CERTIFIED

Approved by _____ Secretary
Committee Meeting On 21/10/12
vide Sl.no. No. 96/2012
Sign: Vinod Saxena
Name VINOD SAXENA
Designation DIG (P&R)

The Proposal has been approved by the BOETH Screening Committee held on 11/10/12 vide Item No. 96/2012 in File No. Dis (Pg) E/2006/5ER/2012/
Sec 26-3/14/12

~~1st~~ 2nd 1st
 1st 2nd 1st