

DELHI DEVELOPMENT AUTHORITY

ROHINI PROJECT PLANNING AND DESIGN

AREA STATEMENT :-

TOTAL AREA OF POCKET = 20.26 HAC.

AREA UNDER RESIDENTIAL = 8.47 HAC.=41.81 %

AREA UNDER CIRCULATION = 8.20 HAC.=40.47 %

AREA UNDER GREEN/PARKS = 2.53 HAC.=12.49 %

AREA UNDER UTILITIES = 1.06 HAC.=5.23 %

PLOT AREA IN Sq. M.	SIZE OF PLOT IN M.	Nb OF PLOT	AREA UNDER PLOTS	Nb OF OUTSTATION	NUMBERING OF PLOTS
60.00	5X12	598	35680	2392	10764
32.00	4X8	1116	35712	3348	15066
26.00	3.25X8	492	12792	1476	6642
30.00	3.75X8	6	180.00	18	81
26.88	3.36X8	8	215.04	24	108
TOTAL	---	2220	84779.04	7258	32661

LEGEND

1. THE LOCATION OF 11 KV ELECTRIC SUB STATION MARKED ON LAYOUT PLAN ONLY APPROVED BY T.P.D.P. FORWARDED BY EX. ENGG. (C) ED-7 DDA VIDE LETTER NO P-1(23)12/ES/ED-7/DDA 2830 DATED 9-8-2012 HAS BEEN APPROVED IN 308th SCREENING COMMITTEE MEETING HELD ON 11-10-2012 VIDE ITEM NO 3012012

DELHI DEVELOPMENT AUTHORITY
HUMAN COORDINATION
308th SCREENING COMMITTEE
11.10.12
307.2.012
Director (Arch) Coord

DELHI DEVELOPMENT AUTHORITY
CERTIFIED
Approved in 308th Screening Committee Meeting Dn 11.10.2012
Vide Item No. 3012012
By: M. K. GUPTA, S.E.
Project Engineer (Arch)

The Proposal has been approved by the 308th Screening Committee held on 11.10.12 vide Item No. 3012012 in File No. 11/10/12/ES/ED-7/DDA 2830/3012012

THE SCHEME WAS DISCUSSED IN THE 289th SCREENING COMMITTEE MEETING HELD ON 25-02-2010 VIDE ITEM NO 11-2010 IN FILE NO. DIR(PUG) R/5034/A1.A-2/2010 THE PROPOSAL AS REFLECTED IN THE AGENDA WAS APPROVED

THE SCHEME WAS APPROVED IN THE 289th SCREENING COMMITTEE MEETING VIDE ITEM NO 11-2010 AND THE SAME WAS AUTHENTICATED BY DY. DIR (ARCH) COORDN. IN FILE NO. DIR (PLC) R/5034/A1.A-2/2010.

LAYOUT PLAN OF POCKET-1 & 2, BLOCK-A
SECTOR - 34, PHASE - V, ROHINI

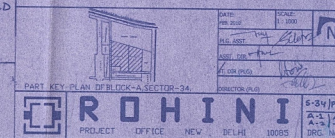



DELHI DEVELOPMENT AUTHORITY
ROHINI PROJECT PLANNING & DESIGN

AREA STATEMENT

A. TOTAL AREA OF POCKET - 7.2 HA

AREA UNDER

RESIDENTIAL PLOTS	3.08 HA	42.8 %
GREEN / PARK	0.70 HA	9.7 %
UTILITY	0.16 HA	2.2 %
CIRCULATION / PARKING	3.26 HA	45.3 %

B. DISTRIBUTION OF RESIDENTIAL PLOTS

PLOT AREA (SQ.M)	PLOT SIZE	PLOT NOS.	TOTAL PLOTS	TOTAL AREA (SQ.M)	DUS	POPULATION
60	5X12	1-96, 967-1712	242	14520	868	4356
32	4X8	97-142, 144-152, 155-168, 171-184, 187-195, 197-240, 281-458, 713-778	380	12160	1140	5130
26	25X8	281-289, 459-566	148	3848	444	1098
36	45X8	143-153, 154-163, 170-185, 186-196	8	288	24	108
TOTAL			778	30816	2576	11592

NET RESIDENTIAL DENSITY - 358 DUS/HA / 1610 PPH

C. DEVELOPMENT CONTROL NORMS AS PER M.P.D. 2021

DELHI DEVELOPMENT AUTHORITY
CERTIFIED
Approved in _____
Committee Meeting on _____
Date _____
Signature _____
Signature _____

The Proposal has been approved by the _____ Screening Committee held on _____ vide Item No. _____ in File No. _____
2012 / S-24-35
ASST DIR (PLG) _____
DY DIR (PLG) _____

LEGEND
1. TRUNK LINE SITE (S.NRS) AREA 6000 M EACH
THE LOCATION OF 11 KV ELECTRIC SUB STATION MARKED ON LAYOUT PLAN ONLY APPROVED BY T.P.D. & FORWARDED BY EX-2000/6/807 CDA WIDE LETTER NO. P-2 (23/12/2012) DATED 3-8-2012 HAS BEEN APPROVED IN 289TH SCREENING COMMITTEE MEETING HELD ON 11-16-2012 VIDE ITEM NO. 901/2012

LAYOUT PLAN OF RESIDENTIAL POCKET A-4, SECTOR-34, ROHINI

SCALE 1:1000
DATE FEB. 2010
PLG. DMLPG. ASST. _____
ASST. DIR. _____
JT. DIRECTOR (PLG) _____
DIRECTOR (PLG) _____

ROHINI
PROJECT OFFICE NEW DELHI 110085
S-34/Ph-2
A-4/1
DRG. NO. _____

THE SCHEME WAS DISCUSSED IN THE 289TH SCREENING COMMITTEE MEETING HELD ON 25.02.2010 VIDE ITEM NO. 19/2010 IN FILE NO. DIR (PLG) R/4034/PKT-4/BLK-A/2010
THE PROPOSAL AS REFLECTED IN THE AGENDA WAS APPROVED

THE SCHEME WAS APPROVED IN THE 289TH SCREENING COMMITTEE VIDE ITEM NO. 19/2010 AND THE SAME WAS AUTHENTICATED BY DY. DIR. (ARCH) COORD. DT. 6.4.10 IN FILE NO. DIR (PLG) R/4034/PKT-4/BLK-A/2010

RESIDENTIAL POCKET A-3

ROAD 24.0 M R/W

ROAD 9.0 M R/W

ROAD 9.0 M R/W

ROAD 9.0 M R/W

ROAD 9.0 M R/W

ROAD 9.0 M R/W

ROAD 9.0 M R/W

ROAD 9.0 M R/W

ROAD 9.0 M R/W

ROAD 9.0 M R/W

ROAD 9.0 M R/W

ROAD 9.0 M R/W

ROAD 9.0 M R/W

ROAD 9.0 M R/W

ROAD 9.0 M R/W

ROAD 9.0 M R/W

ROAD 9.0 M R/W

ROAD 9.0 M R/W

ROAD 9.0 M R/W

ROAD 9.0 M R/W

ROAD 9.0 M R/W

ROAD 9.0 M R/W

ROAD 9.0 M R/W

ROAD 9.0 M R/W

ROAD 9.0 M R/W

ROAD 9.0 M R/W

ROAD 9.0 M R/W

ROAD 9.0 M R/W

ROAD 9.0 M R/W

ROAD 9.0 M R/W

ROAD 9.0 M R/W

ROAD 9.0 M R/W

ROAD 9.0 M R/W

ROAD 9.0 M R/W

ROAD 9.0 M R/W

ROAD 9.0 M R/W

ROAD 9.0 M R/W

ROAD 9.0 M R/W

ROAD 9.0 M R/W

ROAD 9.0 M R/W

ROAD 9.0 M R/W

ROAD 9.0 M R/W

ROAD 9.0 M R/W

ROAD 9.0 M R/W

ROAD 9.0 M R/W

ROAD 9.0 M R/W

ROAD 9.0 M R/W

ROAD 9.0 M R/W

ROAD 9.0 M R/W

ROAD 9.0 M R/W

ROAD 9.0 M R/W

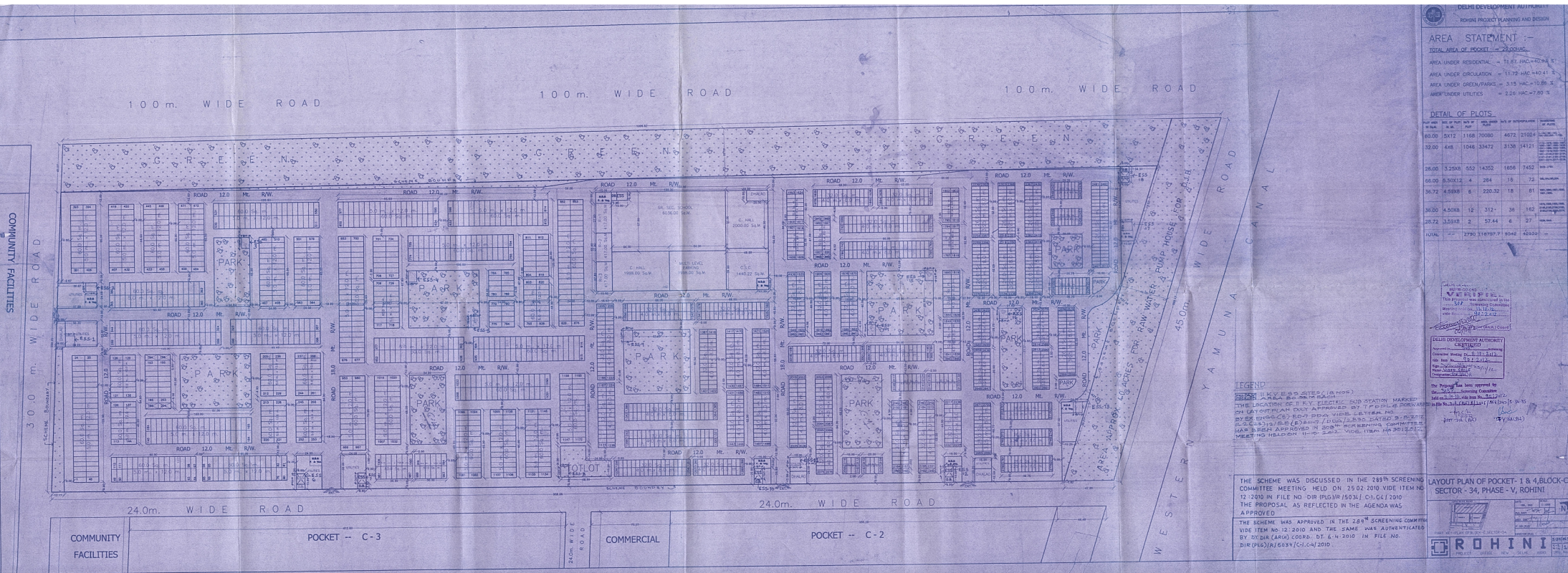

DELHI DEVELOPMENT AUTHORITY
ROHINI PROJECT PLANNING AND DESIGN

AREA STATEMENT :-

TOTAL AREA OF POCKET -- 21.00 HECTARE
AREA UNDER RESIDENTIAL -- 11.67 HECTARE
AREA UNDER CIRCULATION -- 11.72 HECTARE
AREA UNDER GREEN/PARKS -- 3.15 HECTARE
AREA UNDER UTILITIES -- 2.20 HECTARE

DETAIL OF PLOTS

Plot No.	Area in Sq. M.	Area in Sq. Yds.	Area in Sq. M.	Area in Sq. Yds.
10000	5412	1168	70000	4672
12000	448	1044	33472	3130
14000	3200	552	14352	1858
16000	53012	4	284	18
18000	45888	6	220.32	18
20000	45008	12	312	38
22000	35008	2	57.44	6
TOTAL	27200	11879.7	8042	458.60

APPROVED BY THE DELHI DEVELOPMENT AUTHORITY
FOR THE ROHINI PROJECT
DATE: 12/04/2010
BY: [Signature]
FOR: [Signature]

LEGEND
1. K.V. ELECTRIC SUB STATION MARKED
2. THE LOCATION OF T.V. ELECTRIC SUB STATION MARKED
3. THE LOCATION OF T.V. ELECTRIC SUB STATION MARKED
4. THE LOCATION OF T.V. ELECTRIC SUB STATION MARKED
5. THE LOCATION OF T.V. ELECTRIC SUB STATION MARKED
6. THE LOCATION OF T.V. ELECTRIC SUB STATION MARKED
7. THE LOCATION OF T.V. ELECTRIC SUB STATION MARKED
8. THE LOCATION OF T.V. ELECTRIC SUB STATION MARKED
9. THE LOCATION OF T.V. ELECTRIC SUB STATION MARKED
10. THE LOCATION OF T.V. ELECTRIC SUB STATION MARKED

THE SCHEME WAS DISCUSSED IN THE 289TH SCREENING COMMITTEE MEETING HELD ON 25.02.2010 VIDE ITEM NO. 12-2010 IN FILE NO. DIR (PLG)/R/503X/C1/C4/2010 THE PROPOSAL AS REFLECTED IN THE AGENDA WAS APPROVED.
THE SCHEME WAS APPROVED IN THE 289TH SCREENING COMMITTEE MEETING HELD ON 25.02.2010 VIDE ITEM NO. 12-2010 IN FILE NO. DIR (PLG)/R/503X/C1/C4/2010.

LAYOUT PLAN OF POCKET-1 & 4 BLOCK-C SECTOR-34, PHASE-V, ROHINI

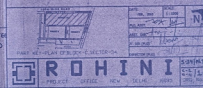

THE SCHEME WAS APPROVED IN THE 286TH MEETING HELD ON 10.12.09 VIDE ITEM NO. 165/2009 AND THE SAME WAS VERIFIED BY D.D.R.(ARCH) COORD. IN FILE NO. DIR(PLG)/R/5034/PKT-2/BLK-C/2009.

- THE SCHEME WAS DISCUSSED IN 286TH SCREENING COMMITTEE MEETING HELD ON 10.12.2009 VIDE ITEM NO. 165/2009.
- THE PROPOSAL WAS APPROVED WITH THE OBSERVATION THAT-
- RESIDENTIAL FACILITIES SUCH AS DHALAO, E.S.S, MILK & VEG. BOOTH, DISPOSABLE GARBAGE COLLECTION TROLLEY, DUSTBIN AND COMMUNITY OFFICES BE SHOWN IN L.O.P.
 - DHALAO INCLUDING SEGREGATION - 2 NOS, E.S.S - 2 NOS, MILK & VEG. BOOTH (M.B.V.B) - 3 NOS, DUSTBIN - 3 NOS ARE PROVIDED
 - ISSUES RELATED TO PARKING BE ADDRESSED IN THE OTHER COMMUNITY FACILITY AREAS & COMMERCIAL AREAS
 - A PLOT OF 1000 SQM FOR MULTILEVEL PARKING IS PROVIDED IN THE NEARBY COMMUNITY FACILITY POCKET



AREA STATEMENT

A. TOTAL AREA OF POCKET 9.67 HA AREA UNDER

- RESIDENTIAL PLOT 3.95 HA 41%
- CIRCULATION PARKING 4.11 HA 42%
- OPEN SPACES (GREEN) 1.0 HA 11%
- UTILITY/FACILITIES 0.59 HA 6%

B. DISTRIBUTION OF RESIDENTIAL PLOTS

PLOT AREA	SIZE IN M.	TOTAL NO. OF PLOTS	AREA UNDER PLOTS	NO. OF DU'S	POPULATION	NOS. OF PLOT
60M	5X12	221	13260	884	3975	119-22, 40-74, 110-111, 222, 333-347, 348-351, 362-375, 376-390, 845-915, 917-928, 931-989, 990-1004, 1005-1019, 1020-1038
32M	1X8	472	15104	1416	6372	41-64, 67-90, 91-112, 113-134, 135-156, 157-178, 203-215, 216-238, 239-256, 257-282, 283-306, 307-332, 331-404, 405-418, 419-432, 433-446, 447-463, 464-480, 481-493, 494-514, 515-526, 527-544, 545-560, 561-574, 575-586, 587-597, 598-609, 610-622, 623-643, 644-669
26M	3X25	410	10,660	1230	5535	515-526, 527-544, 545-560, 561-574, 575-586, 587-597, 598-609, 610-622, 623-643, 644-669, 670-683, 684-696, 697-709, 710-724, 725-737, 738-750, 751-764, 765-779, 780-792, 793-806, 807-833, 834-860, 861-871, 872-884, 885-897, 898-910, 911-924, 925-938, 939-951, 952-964
41.28	5.16	6	247.68	18	81	65-66, 67-68, 69-70, 71-72, 73-74, 75-76, 77-78, 79-80, 81-82, 83-84, 85-86, 87-88, 89-90, 91-92, 93-94, 95-96, 97-98, 99-100, 101-102, 103-104, 105-106, 107-108, 109-110, 111-112, 113-114, 115-116, 117-118, 119-120, 121-122, 123-124, 125-126, 127-128, 129-130, 131-132, 133-134, 135-136, 137-138, 139-140, 141-142, 143-144, 145-146, 147-148, 149-150, 151-152, 153-154, 155-156, 157-158, 159-160, 161-162, 163-164, 165-166, 167-168, 169-170, 171-172, 173-174, 175-176, 177-178, 179-180, 181-182, 183-184, 185-186, 187-188, 189-190, 191-192, 193-194, 195-196, 197-198, 199-200, 201-202, 203-204, 205-206, 207-208, 209-210, 211-212, 213-214, 215-216, 217-218, 219-220, 221-222, 223-224, 225-226, 227-228, 229-230, 231-232, 233-234, 235-236, 237-238, 239-240, 241-242, 243-244, 245-246, 247-248, 249-250, 251-252, 253-254, 255-256, 257-258, 259-260, 261-262, 263-264, 265-266, 267-268, 269-270, 271-272, 273-274, 275-276, 277-278, 279-280, 281-282, 283-284, 285-286, 287-288, 289-290, 291-292, 293-294, 295-296, 297-298, 299-300, 301-302, 303-304, 305-306, 307-308, 309-310, 311-312, 313-314, 315-316, 317-318, 319-320, 321-322, 323-324, 325-326, 327-328, 329-330, 331-332, 333-334, 335-336, 337-338, 339-340, 341-342, 343-344, 345-346, 347-348, 349-350, 351-352, 353-354, 355-356, 357-358, 359-360, 361-362, 363-364, 365-366, 367-368, 369-370, 371-372, 373-374, 375-376, 377-378, 379-380, 381-382, 383-384, 385-386, 387-388, 389-390, 391-392, 393-394, 395-396, 397-398, 399-400, 401-402, 403-404, 405-406, 407-408, 409-410, 411-412, 413-414, 415-416, 417-418, 419-420, 421-422, 423-424, 425-426, 427-428, 429-430, 431-432, 433-434, 435-436, 437-438, 439-440, 441-442, 443-444, 445-446, 447-448, 449-450, 451-452, 453-454, 455-456, 457-458, 459-460, 461-462, 463-464, 465-466, 467-468, 469-470, 471-472, 473-474, 475-476, 477-478, 479-480, 481-482, 483-484, 485-486, 487-488, 489-490, 491-492, 493-494, 495-496, 497-498, 499-500, 501-502, 503-504, 505-506, 507-508, 509-510, 511-512, 513-514, 515-516, 517-518, 519-520, 521-522, 523-524, 525-526, 527-528, 529-530, 531-532, 533-534, 535-536, 537-538, 539-540, 541-542, 543-544, 545-546, 547-548, 549-550, 551-552, 553-554, 555-556, 557-558, 559-560, 561-562, 563-564, 565-566, 567-568, 569-570, 571-572, 573-574, 575-576, 577-578, 579-580, 581-582, 583-584, 585-586, 587-588, 589-590, 591-592, 593-594, 595-596, 597-598, 599-600, 601-602, 603-604, 605-606, 607-608, 609-610, 611-612, 613-614, 615-616, 617-618, 619-620, 621-622, 623-624, 625-626, 627-628, 629-630, 631-632, 633-634, 635-636, 637-638, 639-640, 641-642, 643-644, 645-646, 647-648, 649-650, 651-652, 653-654, 655-656, 657-658, 659-660, 661-662, 663-664, 665-666, 667-668, 669-670, 671-672, 673-674, 675-676, 677-678, 679-680, 681-682, 683-684, 685-686, 687-688, 689-690, 691-692, 693-694, 695-696, 697-698, 699-700, 701-702, 703-704, 705-706, 707-708, 709-710, 711-712, 713-714, 715-716, 717-718, 719-720, 721-722, 723-724, 725-726, 727-728, 729-730, 731-732, 733-734, 735-736, 737-738, 739-740, 741-742, 743-744, 745-746, 747-748, 749-750, 751-752, 753-754, 755-756, 757-758, 759-760, 761-762, 763-764, 765-766, 767-768, 769-770, 771-772, 773-774, 775-776, 777-778, 779-780, 781-782, 783-784, 785-786, 787-788, 789-790, 791-792, 793-794, 795-796, 797-798, 799-800, 801-802, 803-804, 805-806, 807-808, 809-810, 811-812, 813-814, 815-816, 817-818, 819-820, 821-822, 823-824, 825-826, 827-828, 829-830, 831-832, 833-834, 835-836, 837-838, 839-840, 841-842, 843-844, 845-846, 847-848, 849-850, 851-852, 853-854, 855-856, 857-858, 859-860, 861-862, 863-864, 865-866, 867-868, 869-870, 871-872, 873-874, 875-876, 877-878, 879-880, 881-882, 883-884, 885-886, 887-888, 889-890, 891-892, 893-894, 895-896, 897-898, 899-900, 901-902, 903-904, 905-906, 907-908, 909-910, 911-912, 913-914, 915-916, 917-918, 919-920, 921-922, 923-924, 925-926, 927-928, 929-930, 931-932, 933-934, 935-936, 937-938, 939-940, 941-942, 943-944, 945-946, 947-948, 949-950, 951-952, 953-954, 955-956, 957-958, 959-960, 961-962, 963-964, 965-966, 967-968, 969-970, 971-972, 973-974, 975-976, 977-978, 979-980, 981-982, 983-984, 985-986, 987-988, 989-990, 991-992, 993-994, 995-996, 997-998, 999-1000
41.28	5.16	6	247.68	18	81	65-66, 67-68, 69-70, 71-72, 73-74, 75-76, 77-78, 79-80, 81-82, 83-84, 85-86, 87-88, 89-90, 91-92, 93-94, 95-96, 97-98, 99-100, 101-102, 103-104, 105-106, 107-108, 109-110, 111-112, 113-114, 115-116, 117-118, 119-120, 121-122, 123-124, 125-126, 127-128, 129-130, 131-132, 133-134, 135-136, 137-138, 139-140, 141-142, 143-144, 145-146, 147-148, 149-150, 151-152, 153-154, 155-156, 157-158, 159-160, 161-162, 163-164, 165-166, 167-168, 169-170, 171-172, 173-174, 175-176, 177-178, 179-180, 181-182, 183-184, 185-186, 187-188, 189-190, 191-192, 193-194, 195-196, 197-198, 199-200, 201-202, 203-204, 205-206, 207-208, 209-210, 211-212, 213-214, 215-216, 217-218, 219-220, 221-222, 223-224, 225-226, 227-228, 229-230, 231-232, 233-234, 235-236, 237-238, 239-240, 241-242, 243-244, 245-246, 247-248, 249-250, 251-252, 253-254, 255-256, 257-258, 259-260, 261-262, 263-264, 265-266, 267-268, 269-270, 271-272, 273-274, 275-276, 277-278, 279-280, 281-282, 283-284, 285-286, 287-288, 289-290, 291-292, 293-294, 295-296, 297-298, 299-300, 301-302, 303-304, 305-306, 307-308, 309-310, 311-312, 313-314, 315-316, 317-318, 319-320, 321-322, 323-324, 325-326, 327-328, 329-330, 331-332, 333-334, 335-336, 337-338, 339-340, 341-342, 343-344, 345-346, 347-348, 349-350, 351-352, 353-354, 355-356, 357-358, 359-360, 361-362, 363-364, 365-366, 367-368, 369-370, 371-372, 373-374, 375-376, 377-378, 379-380, 381-382, 383-384, 385-386, 387-388, 389-390, 391-392, 393-394, 395-396, 397-398, 399-400, 401-402, 403-404, 405-406, 407-408, 409-410, 411-412, 413-414, 415-416, 417-418, 419-420, 421-422, 423-424, 425-426, 427-428, 429-430, 431-432, 433-434, 435-436, 437-438, 439-440, 441-442, 443-444, 445-446, 447-448, 449-450, 451-452, 453-454, 455-456, 457-458, 459-460, 461-462, 463-464, 465-466, 467-468, 469-470, 471-472, 473-474, 475-476, 477-478, 479-480, 481-482, 483-484, 485-486, 487-488, 489-490, 491-492, 493-494, 495-496, 497-498, 499-500, 501-502, 503-504, 505-506, 507-508, 509-510, 511-512, 513-514, 515-516, 517-518, 519-520, 521-522, 523-524, 525-526, 527-528, 529-530, 531-532, 533-534, 535-536, 537-538, 539-540, 541-542, 543-544, 545-546, 547-548, 549-550, 551-552, 553-554, 555-556, 557-558, 559-560, 561-562, 563-564, 565-566, 567-568, 569-570, 571-572, 573-574, 575-576, 577-578, 579-580, 581-582, 583-584, 585-586, 587-588, 589-590, 591-592, 593-594, 595-596, 597-598, 599-600, 601-602, 603-604, 605-606, 607-608, 609-610, 611-612, 613-614, 615-616, 617-618, 619-620, 621-622, 623-624, 625-626, 627-628, 629-630, 631-632, 633-634, 635-636, 637-638, 639-640, 641-642, 643-644, 645-646, 647-648, 649-650, 651-652, 653-654, 655-656, 657-658, 659-660, 661-662, 663-664, 665-666, 667-668, 669-670, 671-672, 673-674, 675-676, 677-678, 679-680, 681-682, 683-684, 685-686, 687-688, 689-690, 691-692, 693-694, 695-696, 697-698, 699-700, 701-702, 703-704, 705-706, 707-708, 709-710, 711-712, 713-714, 715-716, 717-718, 719-720, 721-722, 723-724, 725-726, 727-728, 729-730, 731-732, 733-734, 735-736, 737-738, 739-740, 741-742, 743-744, 745-746, 747-748, 749-750, 751-752, 753-754, 755-756, 757-758, 759-760, 761-762, 763-764, 765-766, 767-768, 769-770, 771-772, 773-774, 775-776, 777-778, 779-780, 781-782, 783-784, 785-786, 787-788, 789-790, 791-792, 793-794, 795-796, 797-798, 799-800, 801-802, 803-804, 805-806, 807-808, 809-810, 811-812, 813-814, 815-816, 817-818, 819-820, 821-822, 823-824, 825-826, 827-828, 829-830, 831-832, 833-834, 835-836, 837-838, 839-840, 841-842, 843-844, 845-846, 847-848, 849-850, 851-852, 853-854, 855-856, 857-858, 859-860, 861-862, 863-864, 865-866, 867-868, 869-870, 871-872, 873-874, 875-876, 877-878, 879-880, 881-882, 883-884, 885-886, 887-888, 889-890, 891-892, 893-894, 895-896, 897-898, 899-900, 901-902, 903-904, 905-906, 907-908, 909-910, 911-912, 913-914, 915-916, 917-918, 919-920, 921-922, 923-924, 925-926, 927-928, 929-930, 931-932, 933-934, 935-936, 937-938, 939-940, 941-942, 943-944, 945-946, 947-948, 949-950, 951-952, 953-954, 955-956, 957-958, 959-960, 961-962, 963-964, 965-966, 967-968, 969-970, 971-972, 973-974, 975-976, 977-978, 979-980, 981-982, 983-984, 985-986, 987-988, 989-990, 991-992, 993-994, 995-996, 997-998, 999-1000
44	5.5	2	88	6	27	741, 742, 743, 744, 745, 746, 747, 748, 749, 750, 751, 752, 753, 754, 755, 756, 757, 758, 759, 760, 761, 762, 763, 764, 765, 766, 767, 768, 769, 770, 771, 772, 773, 774, 775, 776, 777, 778, 779, 780, 781, 782, 783, 784, 785, 786, 787, 788, 789, 790, 791, 792, 793, 794, 795, 796, 797, 798, 799, 800, 801, 802, 803, 804, 805, 806, 807, 808, 809, 810, 811, 812, 813, 814, 815, 816, 817, 818, 819, 820, 821, 822, 823, 824, 825, 826, 827, 828, 829, 830, 831, 832, 833, 834, 835, 836, 837, 838, 839, 840, 841, 842, 843, 844, 845, 846, 847, 848, 849, 850, 851, 852, 853, 854, 855, 856, 857, 858, 859, 860, 861, 862, 863, 864, 865, 866, 867, 868, 869, 870, 871, 872, 873, 874, 875, 876, 877, 878, 879, 880, 881, 882, 883, 884, 885, 886, 887, 888, 889, 890, 891, 892, 893, 894, 895, 896, 897, 898, 899, 900, 901, 902, 903, 904, 905, 906, 907, 908, 909, 910, 911, 912, 913, 914, 915, 916, 917, 918, 919, 920, 921, 922, 923, 924, 925, 926, 927, 928, 929, 930, 931, 932, 933, 934, 935, 936, 937, 938, 939, 940, 941, 942, 943, 944, 945, 946, 947, 948, 949, 950, 951, 952, 953, 954, 955, 956, 957, 958, 959, 960, 961, 962, 963, 964, 965, 966, 967, 968, 969, 970, 971, 972, 973, 974, 975, 976, 977, 978, 979, 980, 981, 982, 983, 984, 985, 986, 987, 988, 989, 990, 991, 992, 993, 994, 995, 996, 997, 998, 999, 1000
72	6.0	1	72	4	18	741, 742, 743, 744, 745, 746, 747, 748, 749, 750, 751, 752, 753, 754, 755, 756, 757, 758, 759, 760, 761, 762, 763, 764, 765, 766, 767, 768, 769, 770, 771, 772, 773, 774, 775, 776, 777, 778, 779, 780, 781, 782, 783, 784, 785, 786, 787, 788, 789, 790, 791, 792, 793, 794, 795, 796, 797, 798, 799, 800, 801, 802, 803, 804, 805, 806, 807, 808, 809, 810, 811, 812, 813, 814, 815, 816, 817, 818, 819, 820, 821, 822, 823, 824, 825, 826, 827, 828, 829, 830, 831, 832, 833, 834, 835, 836, 837, 838, 839, 840, 841, 842, 843, 844, 845, 846, 847, 848, 849, 850, 851, 852, 853, 854, 855, 856, 857, 858, 859, 860, 861, 862, 863, 864, 865, 866, 867, 868, 869, 870, 871, 872, 873, 874, 875, 876, 877, 878, 879, 880, 881, 882, 883, 884, 885, 886, 887, 888, 889, 89

POCKET -- C-4

ROAD 24.0 Mt. R/W.

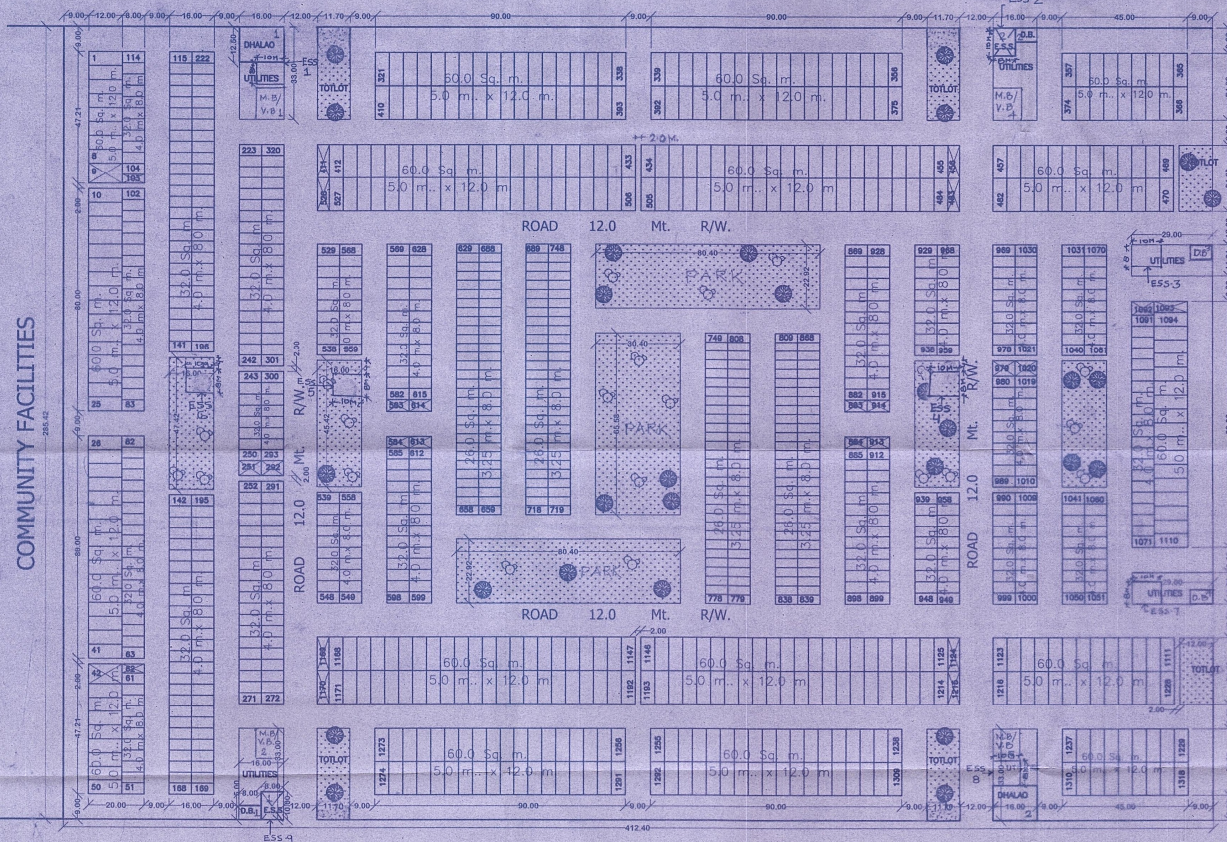

ROAD 30.0 Mt. R/W.

COMMUNITY FACILITIES

COMMERCIAL

GROUP HOUSING

THE PROPOSAL HAS BEEN APPROVED IN THE 266th U.I. SCREENING COMMITTEE MEETING HELD ON 10.12.2009 VIDE ITEM NO. 168/2009. WITH THE FOLLOWING OBSERVATIONS:-

1. RESIDENTIAL FACILITIES SUCH AS DHALAO, E.S.S., MILK/VEGETABLE BOOTH, DISPOSABLE GARBAGE COLLECTION TROLLEY, DUST BIN AND COMMUNITY OFFICES BE SHOWN IN THE LAYOUT PLAN.
2. ISSUE RELATED TO PARKING BE ADDRESSED IN OTHER COMMUNITY FACILITY AREA AND COMMERCIAL AREA.

A PLOT OF AREA 1000.00 Sq.M. IS RESERVED FOR MULTILEVEL PARKING IN THE NEAR BY COMMUNITY FACILITIES POCKET.

THE SCHEME WAS APPROVED IN THE 286th S.C. MEETING HELD ON 10.12.09 VIDE ITEM NO. 161/2009 AND THE SAME WAS VERIFIED BY DY.DIR.(ARCH) COORD. DT. 26.2.10 IN FILE NO. DIR(PLO)R/5034/PKT-3/BLK-C/2009.

LEGEND

PROF. 11KV.ESS SITES (C/NOS) AREA=60 SQ.M EACH

THE LOCATION OF 11KV ELECTRIC SUB-STATION MARKED ON LAYOUT PLAN DULY APPROVED BY TPDDL & FORWARDED BY EX-ENG-6 (E) ED-7 DDA VIDE LETTER NO F2(23)12/EE/ED-7/DDA/1830 DT 9-8-12 HAS BEEN APPROVED IN 908th SCREENING COMMITTEE MEETING HELD ON 11-10-2012 VIDE ITEM NO 901/2012.

DELHI DEVELOPMENT AUTHORITY
HUPW-CO-ORDINATE
VERIFIED & SIGNED
This proposal was considered in the
S.C.P. Screening Committee
Meeting held on 11.10.12
vide item no. 901/2012
Signature: [Signature]
Designation: Dy. Dir. (Arch) Coord.

DELHI DEVELOPMENT AUTHORITY
CERTIFIED
Approved in the 328th Screening Committee Meeting Dt. 11.10.2012 vide item No. 901/2012
Sign: [Signature]
Name: SUNIL K. SINGH
Designation: M.B. (P&R)

The Proposal has been approved by the 328th Screening Committee held on 11.10.12 vide item No. 901/2012 in File No. DIR(PLO)R/5034/SEC-PKT-3/34-35

Signature: [Signature]
POST DIR(P&R)
Signature: [Signature]
DDPR (P&R)

DELHI DEVELOPMENT AUTHORITY
ROHINI PROJECT PLANNING AND DESIGN

AREA STATEMENT :-

A. TOTAL AREA OF POCKET = 11.77 HAC.

AREA UNDER RESIDENTIAL = 5.44 HAC. = 46.21%

AREA UNDER CIRCULATION = 5.00 HAC. = 42.48%

AREA UNDER GREEN/PARKS = 1.06 HAC. = 9.02%

AREA UNDER UTILITIES = 0.27 HAC. = 2.29%

B. DETAIL OF PLOTS

PLOT AREA IN Sq.M.	SIZE OF PLOT IN Mt.	No'S OF PLOT	AREA UNDER PLOTS	No'S OF DUS/POPULATION	NUMBERING OF PLOTS
60.00	5X12	473	28380	1892	6514
32.00	4X8	579	18528	1737	7817
26.00	3.25X8	240	6240	720	3240
86.52	7.21X12	2	173.04	8	36
50.40	4.20X12	8	403.20	32	144
48.00	4.0X12	1	48.00	4	18
25.68	3.21X8	2	51.36	6	27
43.36	5.42X8	4	173.44	12	54
33.68	4.21X8	8	377.44	24	108
40.00	5.0X8	1	40.00	3	13
TOTAL	---	1318	54414.48	4438	19971

NET RESIDENTIAL DENSITY = 377 DUS/HAC.
= 1696 PPH
C. DEVELOPMENT CONTROL NORMS/MPD-2021

LAYOUT PLAN OF POCKET-3, BLOCK-C, SECTOR - 34, PHASE - V, ROHINI

PART: KEY-PLAN OF BLOCK-C, SECTOR-34

PROJECT OFFICE NEW DELHI 110085 DRG. NO.

ROHINI



AREA STATEMENT

A. TOTAL AREA OF POCKET 12.13 HAC AREA UNDER

1. RESIDENTIAL PLOTS 5.26 Hac (43.34%)
2. CIRCULATION/PARKING 4.95 Hac (40.80%)
3. OPEN SPACES/GREEN 1.86 Hac (13.68%)
4. UTILITY/FACILITY 0.26 Hac (2.14%)

B. DISTRIBUTION OF RESIDENTIAL PLOTS

PLOT AREA (IN SQ. M)	SIZE (IN M)	TOTAL AREA NO. OF UNDER PLOTS	NO. OF DUS	POPULATION	PLOT NOS.
60.0	5.0 X 12.0	364	21840	1456	6552
32.0	4.0 X 8.0	696	22772	2088	7396
26.0	3.25 X 8.0	328	8528	284	4428
TOTAL					1388 52640 4528 20376 (1101388)

NOTES:

1. DEVELOPMENT CONTROL NORMS AS PER MPD 2021
2. THIS DRS IS BASED ON THE FEASIBILITY REPORT RECEIVED FROM THE OFFICE OF ENGRG/RPO. WIDE LETTER NO. 21-12063 SUBORDINATE STATION SERIES REPORT RECEIVED WIDE LETTER NO. F(21)A(6)RPO-1004/772 DT. 27.03.20
3. ADDITIONAL PARKING REQUIREMENT OF THIS POCKET HAS BEEN ACCOMMODATED IN COMMON POOL PARKING IDENTIFIED IN C.F. (COMM. PARKING) NEAR PLOT 6 SECTION 34, ROHINI
4. ONLY WRITTEN DIMENSIONS TO BE FOLLOWED

DELHI DEVELOPMENT AUTHORITY
CERTIFIED
Approved in: 208* Screening Committee Meeting Dt. 11.10.2012
vide Item No. 10.2.2012
Sign: [Signature] 23/11/12
Designation: [Designation]

The Proposal has been approved by the 208* Screening Committee held on 11.10.12 vide Item No. 10.2.2012 in File No. 208/PLS/R/2012 vide Item No. 10.2.2012
Sign: [Signature] 23/11/12
Designation: [Designation]

ALL DIMENSIONS ARE IN METRES

LAYOUT PLAN OF POCKET C-5 SECTOR 34, ROHINI PH-V

SCALE	1:1000
DATE	10/12/2010
PLG. DM/PLG. ASST.	[Signature]
ASST. DIR	[Signature]
JT. DIRECTOR (PLG.)	[Signature]
DIRECTOR (PLG.)	[Signature]

ROHINI
PROJECT OFFICE NEW DELHI 110085
5-34/PH-V
C-5/1
DRS NO.

100.0 M WIDE ROAD
250.40 M

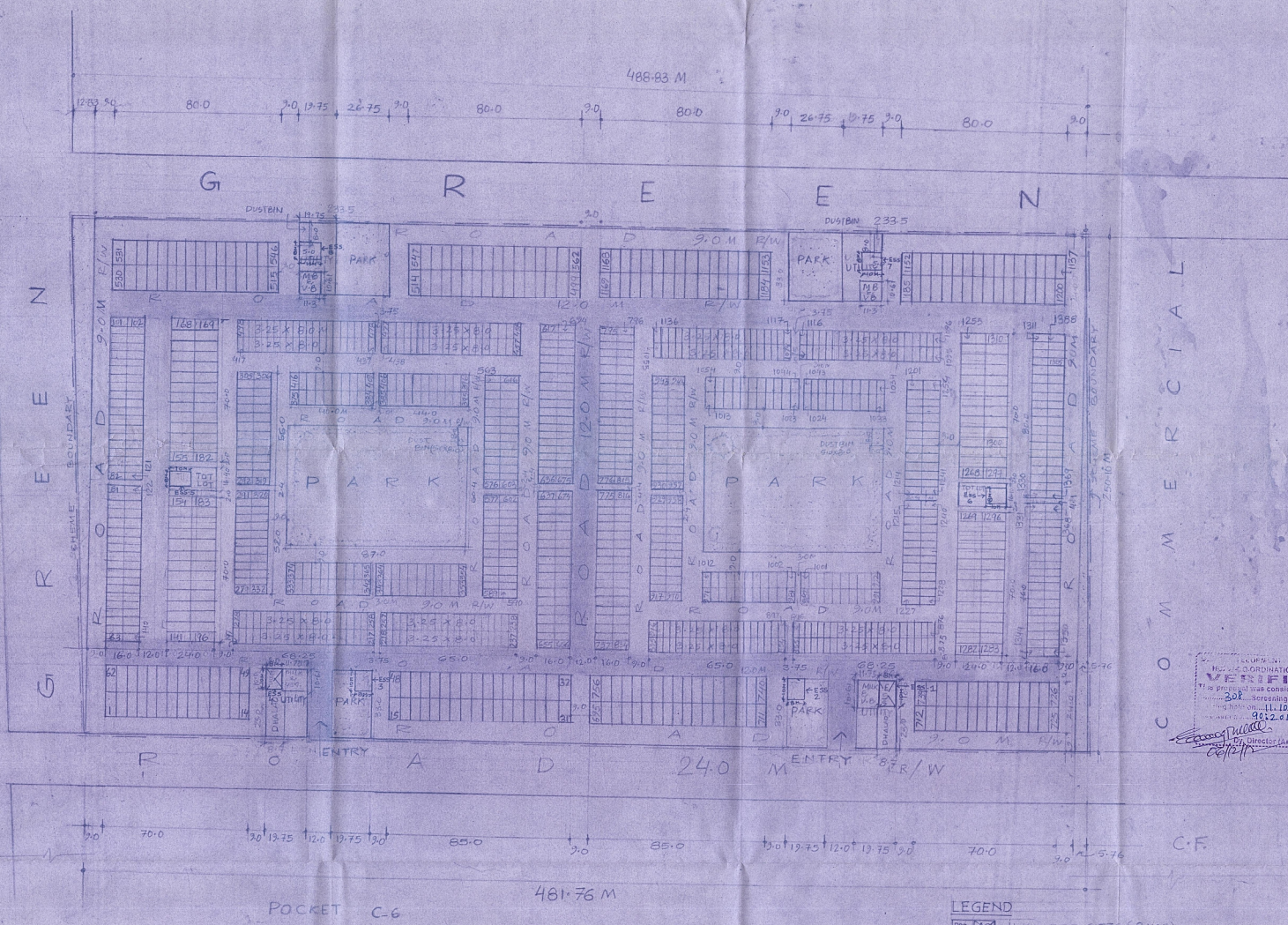

LEGEND

1. K.V. E.S. SITES (C/NOS)
AREA 80.88M EACH
THE LOCATION OF 11 K.V. ELECTRIC SUB STATION MARKED ON LAYOUT PLAN DULY APPROVED BY TDDPLS FORWARDED BY ENGRG (S) BD-7, ODA WIDE LETTER NO. F-2(23)12/55/ED-7/ DDN/2890 DT. 3.8.2012 HAS BEEN APPROVED IN 308* SCREENING COMMITTEE MEETING HELD ON 11.10.2012 VIDE ITEM NO. 80.2012

THE SCHEME WAS DISCUSSED IN THE 289* SCREENING COMMITTEE MEETING HELD ON 25.02.10 VIDE ITEM NO. 18.2010 IN FILE NO. DIR(PLG)/R/4034/PKT. 5/BLK-C/2D10. THE PROPOSAL AS REFLECTED IN THE AGENDA WAS APPROVED.

THE SCHEME WAS APPROVED IN 208* SCREENING COMMITTEE MEETING WIDE ITEM NO. 18.2010 AND THE SAME WAS AUTHENTICATED BY DY.DIR(ARCH) COORDN. DT. 6-4-10 IN FILE NO. DIR(PLG)/R/4034/PKT. 5/BLK-C/1010.

DELHI DEVELOPMENT AUTHORITY
CERTIFIED
Approved in: 388 Screening
Committee Meeting On: 11-10-2012
vide Item No. 90-2012
Sign: [Signature] 23/11/12
Name: M. H. S. D. S. D.
Designation: Director

The proposal has been approved by the 388 Screening Committee held on 11-10-2012 vide item No. 90-2012 in File No. 2012-35-35

[Signature]
23/11/12
[Signature]
23/11/12

DELHI DEVELOPMENT AUTHORITY
HUPW-CO-ORDINATION UNIT
VERIFIED
This proposal was considered in the
308 Screening Committee
on 11.10.12
90:2012

The Proposal has been approved by
the 308 Screening Committee
held on 11-16-12, vide item No. 901-29
in File No. 2012-02-01-2012 (CER)
2012/5-34-35
[Signature]
2012
2012/5-34-35

AREA UNDER RESIDENTIAL PLOTS - 4.756 HAC
(40.16 %)
AREA UNDER OPEN SPACE/GREEN - 2.01 HAC
(16.53 %)
AREA UNDER CIRCULATION/PARKING - 4.685 HAC
(39.55 %)
AREA UNDER UTILITIES/FACILITIES - 0.40 HAC
(3.3 %)

TOTAL NO. OF PLOTS-1338

DISTRIBUTION OF RESIDENTIAL PLOTS

THE LOCATION OF 11KV ELECTRIC
SUB STATION MARKED ON LAY-OUT PLAN
DULY APPROVED BY TPODL & FORWARDED
BY EX ENGG(B) ED-7/DDA VIDE LETTER
NO F-2(23)12-EE/ED-7/DDA/2890
DATED 9-8-2012 HAS BEEN APPROVED
IN 30th SCREENING COMMITTEE
MEETING HELD ON 11-10-2012
VIDE ITEM NO 30: 2012

SCALE 1:1000

DATE	
PLG. DM/PLG. ASST.	<i>W</i>
ASST. DIR	<i>W</i>
JT. DIRECTOR (PLG)	<i>W</i>
DIRECTOR (PLG)	<i>W</i>



R O H I N I				S-34/PH-V
PROJECT	OFFICE	NEW DELHI	110085	C-6/1
				DRG. NO.

NOTES:-

1. DEVELOPMENT CONTROLS AS PER MPD- 2021
2. THIS DRAWING IS BASED ON THE FEASIBILITY REPORT RECEIVED FROM THE OFFICE OF THE EX-ENGR/ RPD-4. VIDE LETTER NO. F-1179, D-24/JC/D/18/24 DATED 1/19/23 DT. 21/202. & SUBSEQUENTLY SURVEY REPORT RPD/18/23 VIDE LETTER NO. F-1214/JC/D/ RPD-4/16/24/2722 DT. 7/2/23.
3. A PLOT OF 2030.0 SQ.M. IS PROPOSED FOR MULTIPLE PARKING FOR PRT. C'S AND PRT. C-6 IN CF (COMMUNITY FACILITY) ADJACENT TO PRT. C-6
4. ONLY WRITTEN DIMENSIONS TO BE FOLLOWED

100.0 M WIDE ROAD

GREEN

PKT C-5

POCKET C-5

481.06 M
463.23 M

PKT. - C-5

COMM

W
W
Z

244.0 M

GREEN

P S F

NOTES

- THE APPROVED LAYOUT PLAN PLOT NO 249 & 288 WHICH WERE NOT NUMBERED EARLIER ARE NUMBERED.
- PLOT NUMBERING IN SOME CASES INADVERTANTLY GIVEN, WHICH HAS BEEN CORRECTED
- THE DETAILS ARE AS UNDER
 - PLOT NO 423 --- C INSTEAD OF 424)
 - PLOT NO 430 --- C INSTEAD OF 426)
 - PLOT NO 425 --- C INSTEAD OF 426)
- THE SAME HAVE BEEN APPROVED BY THE VICE CHAIRMAN D.D.A. ON 22/01/2018 AT PAGE NO 5 IN PLAN NO. B/R/1623/1971 (E.D.)

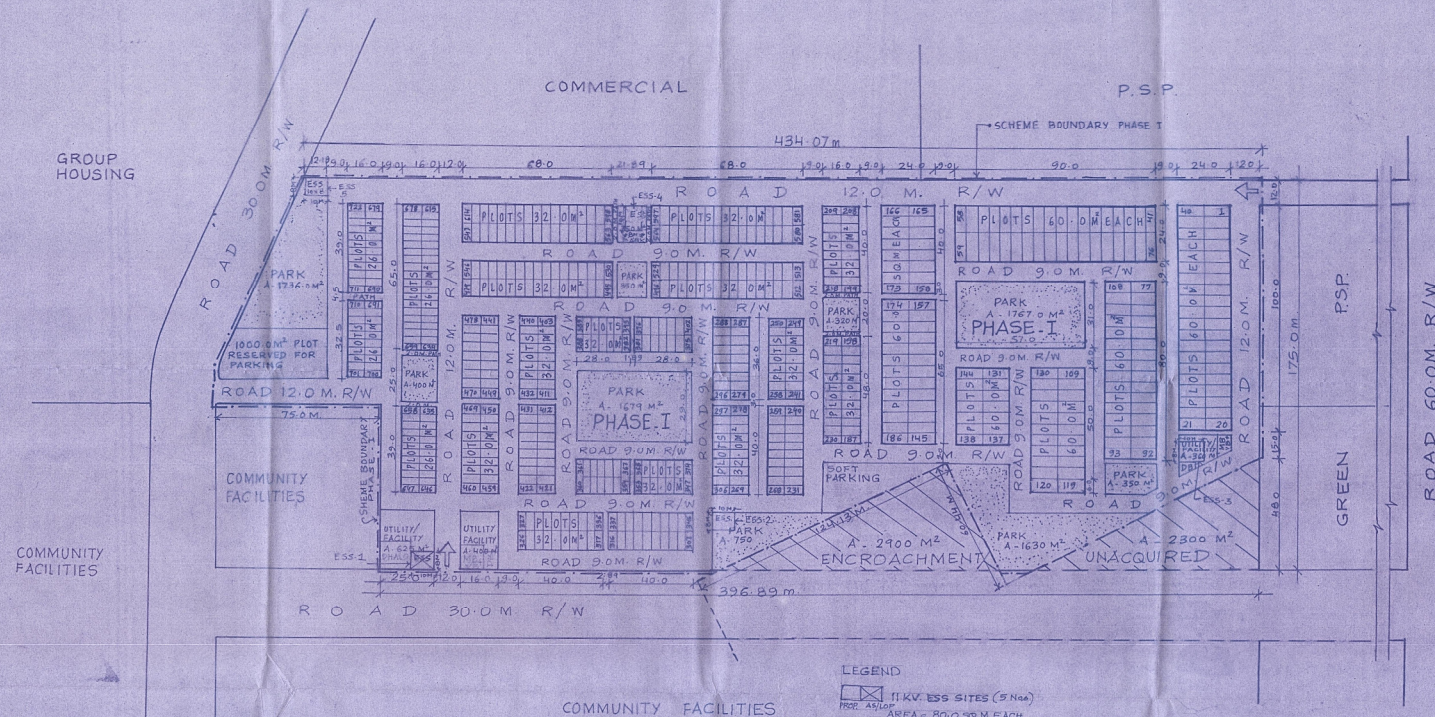

LEGEND

11 KV. ESS SITES (5 Nos)
AREA = 80.030 M EACH

THE LOCATION OF 11 KV ELECTRIC SUB STATION MARKED ON LAYOUT PLAN DULY APPROVED BY TDDI, 9 FORWARDED BY EX. ENG. (E) ED-7, DDA VIDE LETTER No. F-2(23)12/KE/607/DDA/2830 DATED 9.8.2012 HAS BEEN APPROVED IN THE 208th SCREENING COMMITTEE MEETING HELD ON 11.10.12 VIDE ITEM No. 301-202.

DELHI DEVELOPMENT AUTHORITY CERTIFIED
Approved in the 208th Screening Committee Meeting held on 11.10.2012 vide item No. 301-202
Name: MANISH K. PATEL
Designation: Director (Arch.)

The Proposal has been approved by the 208th Screening Committee held on 11.10.12 vide item No. 301-202 in File No. 19/4/2010/57/2010
Name: MANISH K. PATEL
Designation: Director (Arch.)

NOTE:

1. THE SCHEME HAS BEEN APPROVED IN THE 201st SCREENING COMMITTEE MEETING HELD ON 19.4.2010 VIDE ITEM No. 57.2010 IN FILE NO. 61R/PLG/R/5035/PKT-1/BLK-A/2010.
2. THE SCHEME WAS CONSIDERED IN THE 201st SCREENING COMMITTEE MEETING HELD ON 19.4.2010 VIDE ITEM NO. 57.2010 AND THE SAME HAS BEEN VERIFIED BY DY.DR. (ARCH.) COORD. DT. 28.6.10 IN FILE NO. 61R/PLG/R/5035/PKT-1/BLK-A/2010.

DELHI DEVELOPMENT AUTHORITY VERIFIED
This proposal was considered in the 208th Screening Committee Meeting held on 11.10.12 vide item No. 301-202

Name: MANISH K. PATEL
Designation: Director (Arch.)



DELHI DEVELOPMENT AUTHORITY
ROHINI PROJECT PLANNING & DESIGN

AREA STATEMENT

TOTAL AREA OF POCKET - 7.52 HAC.
AREA UNDER ENCROACHMENT/UNACQUIRED - 0.52 HAC.
AREA OF PHASE I
[FREE FROM ENCROACHMENT/ACQUIRED] - 7.0 HAC.

DETAIL OF PHASE I

AREA UNDER
RESIDENTIAL PLOTS - 2.77 HAC. 39.57%
OPEN SPACE (PARK) - 0.94 HAC. 13.43%
UTILITY/FACILITIES - 0.13 HAC. 1.86%
CIRCULATION/PARKING - 3.16 HAC. 45.14%

DISTRIBUTION OF RESIDENTIAL PLOTS

PLOT AREA	SIZE [MxM]	PLOT NOS.	TOTAL PLOT	AREA M ²	D.U.'S	POPULATION
60.0M ²	5.0X12.0	1-186	186	11160	744	3348
32.0M ²	4.0X8.0	187-614	428	13696	1284	5778
26.0M ²	3.25X8.0	615-722	108	2808	324	1458
TOTAL			722	27664	2352	10584

NET RESIDENTIAL DENSITY - 336 DUS/HAC., 1512 PPH

DEVELOPMENT CONTROL NORMS AS PER MPD 2021

THIS DRG. IS PREPARED ON THE BASIS OF FEASIBILITY REPORT GIVEN BY ES/RPD-H DT. 25.3.10 AND LAND STATUS REPORT GIVEN BY DD/LM ROHINI VIDE DY. NO. 435 DT. 25.3.10

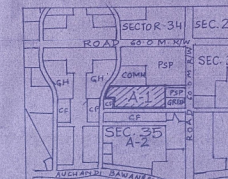

FILE NO. -
DIR (PLG)/R/9035
PKT-1/BLK-A/2010

KEY PLAN

LAYOUT PLAN OF RESIDENTIAL POCKET-1, BLOCK-A, SECTOR-35 ROHINI

SCALE: 1:1000 DATE: MARCH, 2010
PLG. DIR./PLG. ASST.: JUDY. DIR. (PLG.)
ASST. DIR. (PLG.): DIRECTOR (PLG.)

ROHINI
PROJECT OFFICE NEW DELHI 110085
S-35/PH I
A-1/1

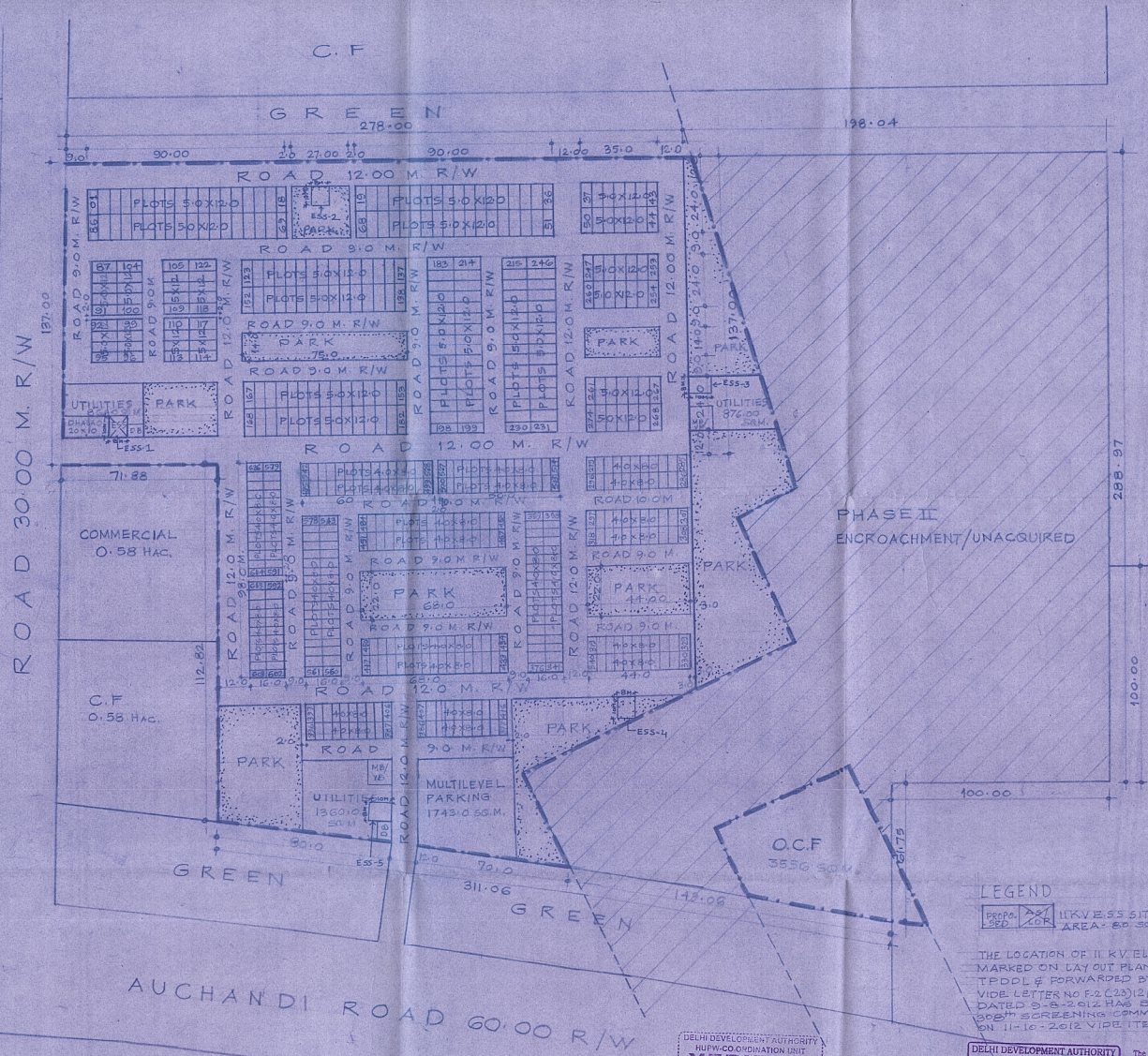

LEGEND

PROPA 201 SED 201 11KV/55 SITES (5 NOS) AREA: 80 SRM EACH

THE LOCATION OF 11 KV ELECTRIC SUB-STATION MARKED ON LAYOUT PLAN DULY APPROVED BY TPO/EE & FORWARDED BY EN/ENG (E) ED-7/DDA VIDE LETTER NO P2/C23/12/EE/ED-7/DDA/2890 DATED 9-8-2012 HAS BEEN APPROVED IN 308TH SCREENING COMMITTEE MEETING HELD ON 11-10-2012 VIDE ITEM NO. 901 2012.

DELHI DEVELOPMENT AUTHORITY
HUPW-COORDINATION UNIT
VERIFIED
This proposal was considered in the
308TH Screening Committee
Meeting held on 11-10-12
Vide Item No. 901 2012
[Signature] (Arch) Coord

DELHI DEVELOPMENT AUTHORITY
CERTIFIED
Approved in 308TH Screening
Committee Meeting Dt. 11-10-2012
Vide Item No. 901 2012
Sign: [Signature]
Name: [Name]
Designation: [Designation]

The Proposal has been approved by the 308TH Screening Committee held on 11-10-12 vide item No. 901 2012 in File No. DIR (PLG) R/5035/PKT-2/BLOCK-A/2010
[Signature] (Arch) Coord
[Signature] (Arch) Coord

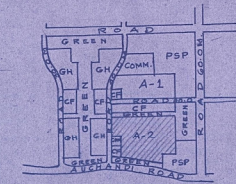

KEY PLAN



DELHI DEVELOPMENT AUTHORITY
ROHINI PROJECT PLANNING & DESIGN

AREA STATEMENT

TOTAL AREA OF THE POCKET = 13.83 HAC.
AREA UNDER PHASE I = 8.67 HAC.
(FREE FROM ENCROACHMENT/ACQUIRED)
AREA UNDER PHASE II = 5.16 HAC.
(ENCROACHMENT/UNACQUIRED)

DETAIL OF PHASE I

AREA UNDER

RESIDENTIAL PLOTS = 2.77 HAC 31.35%
OPEN SPACE (PARK) = 2.19 HAC 25.25%
UTILITIES/FACILITIES = 0.31 HAC 3.58%
CIRCULATION/PARKING = 3.05 HAC 35.18%
O.C.F. = 0.35 HAC 4.04%

DISTRIBUTION OF RESIDENTIAL PLOTS

PLOT AREA IN SQ.M.	PLOT SIZE IN MTR.	PLOT Nos.	TOTAL PLOTS	TOTAL AREA IN SQ.M.	D.U.s	POPULATION
60.00	50X120	1-274	274	16440	1096	4932
32.00	40X80	275-626	352	11264	1056	4752
TOTAL			626	27704	2152	9684

NET RESIDENTIAL DENSITY = 248 DUG/HAC/117 PH
DEVELOPMENT CONTROL NORMS AS PER MPD 2021.

NOTE

1. THE SCHEME HAS BEEN APPROVED IN THE 291ST SCREENING COMMITTEE MEETING HELD ON 19-4-2010 VIDE ITEM NO. 58.2010 IN FILE NO. DIR (PLG) R/5035/PKT-2/BLOCK-A/2010.
2. THE SCHEME WAS CONSIDERED IN THE SCREENING COMMITTEE MEETING HELD ON 19-4-2010 VIDE ITEM NO. 58.2010 AND THE SAME HAS BEEN VERIFIED BY DY. DIR. (ARCH) COORD. DT. 28-6-10 IN FILE NO. DIR (PLG) R/5035/PKT-2/BLOCK-A/2010.

THIS PRG IS BASED ON THE BASIS OF FEASIBILITY REPORT GIVEN BY EE/RPD. DT. 25-03-10 & LAND STATUS GIVEN BY DD (LM.) ROHINI VIDE DY. NO. 435 DT. 25-3-2010

FILE NO. DIR. (PLG) R/5035/PKT-2/BLOCK-A/2010

LAYOUT PLAN OF POCKET-02 BLOCK-A SECTOR-35 PHASE V ROHINI.

SCALE 1:1000 DATE MAR-14-2010
PLG/DNA/PLG/ASSTT. [Signature] (Arch) Coord
ASSTT. DIR (PLG) [Signature] (Arch) Coord
DIRECTOR (PLG) [Signature] (Arch) Coord
NORTH



ROHINI S. 35/PH V
PROJECT OFFICE NEW DELHI 110085 A-2/L
DRG. NO.

ROAD 60.0 M. R/W.

AREA STATEMENT

TOTAL AREA OF PLOT = 13.86 HAC.

AREA UNDER PHASE - I = 11.32 HAC.
(FREE FROM ENCROACHMENT/ACQUIRED)

AREA UNDER PHASE - II = 2.54 HAC.
(ENCROACHED/UNACQUIRED)

DETAIL OF PHASE - I

1 AREA UNDER PLOTS = 3.80 HAC. = 33.56%

2. OPEN SPACE (PARK) = 0.82 HAC. = 7.26%

3. UTILITY/FACILITIES = 0.40 HAC. = 3.53%

4. CIRCULATION PARKING = 6.30 HAC. = 55.65%

DISTRIBUTION OF RESIDENTIAL PLOTS

Plot Area	Size M x M	Plot Nos	Total Area Plots M ²	Du's	Population
600 M ²	5 x 12	1-132	132	7920	528
320 M ²	4 x 8	299-1104	806	25792	2418
260 M ²	3.25 x 8	133-298	166	4316	394
TOTAL			1104	38028	4548

• NET RESIDENTIAL DENSITY = 304 DU'S/HAC, 1369 PPH

• DEVELOPMENT CONTROL NORMS AS PER
MPD - 2021.

* THIS DRG. IS PREPARED ON THE BASIS OF FEASIBILITY REPORT GIVEN BY EE/RPD-4 DT. 25-03-10. AND LAND STATUS GIVEN BY D.O.(LM) ROHINI VIDE DY. No. 435 DT. 25-3-10.

NOTE:
1. THE SCHEME HAS BEEN APPROVED IN THE 291st SCREENING
COMMITTEE MEETING HELD ON 19.4.2010 VIDE ITEM NO.
54: 2010 IN FILE NO. DIR (PLG) R/5035/PKT-1/BLK-C/2010.

2. THE SCHEME WAS CONSIDERED IN THE 29th SCREENING COMMITTEE MEETING HELD ON 19.4.2010 VIDE ITEM NO 54: 2010 AND THE SAME HAS BEEN VERIFIED BY DY.DIR (ARCH) COORDN. DT 28.6.10 IN FILE NO. DIR (PLG) R/5035/PKT-1/BLK. C/ 2010

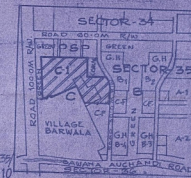

FILE No. 4
DIR (PLG) R/503
PKT-1/BLC C/2010

KEY-PLAN

LAY-OUT PLAN OF RESIDENTIAL POCKET-1
BLOCK-C, SECTOR-35, ROHINI.

SCALE 1:1000 DATE MARCH 2010

PLG. D/M / PLG. ASSTT *Sum* JT/DY. DIR. (PLG) *Wane* 

ASST. DIR (PLG)	<i>[Signature]</i>	DIRECTOR (PLG)	<i>[Signature]</i>	NORTH
-----------------	--------------------	----------------	--------------------	-------

THE BOUNDED

5-35/PH-V
G1/1

PROJECT OFFICE NEW DELHI 110085

LEGEND

11KV/55 SITES (6 SNOO)
AREA 80-203A EACH
THE LOCATION OF 11KV ELECTRIC SUB STATION MARKED
ON LAY-OUT PLAN ONLY APPROVED BY TPDOL & FORWARDED
BY EX ENG (CE) D7, DCA VIDE LETTER NO P-2(23)12/EE/EP/
DCA/2850 DATED 9.8.2012 HAS BEEN APPROVED IN
8001 SCREENING COMMITTEE MEETING HELD ON 10.8.2012.
XIDE ITEM NO 8012012

C.F. (FOR VILLAGE ALSO)
4-04 HAC.

220 KV. HT. LINE

R O A D 100.0 M. R/W